

1 Main Building - Basement Existing  
1 : 200

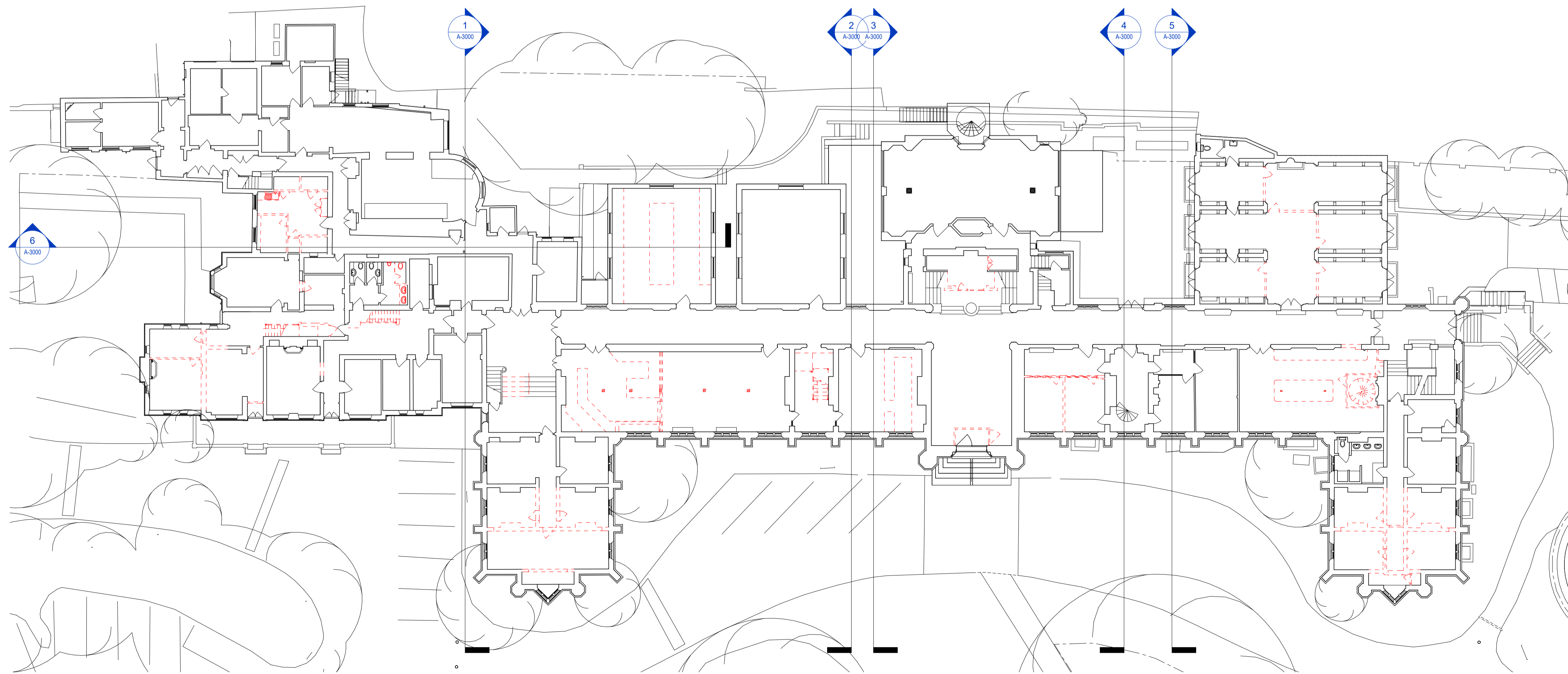

2 Main Building - Ground Floor Existing  
1 : 200

P02	Revised for Planning	10.05.24
P01	Planning Issue	16.02.24
REV	DESCRIPTION	DATE

**IID** Architects  
 Richmond Place  
 15 Petersham Road  
 Richmond  
 TW9 0 6TP  
 info@iid.co.uk  
 020 3274 1100  
 www.iid.co.uk

CLIENT  
**Thomas's London Day Schools**

PROJECT  
**Thomas's College**

DRAWING TITLE  
**Main Building - Existing  
 Basement & Ground Floor  
 Plans**

SCALE: 1 : 200 @ A1

DRAWING NUMBER		REV
1714	IID PL XX DR A-1010	P02