

NOTES

- REFERENCE SHALL BE MADE TO ALL CUDD BENTLEY CONSULTING DRAWINGS AND DOCUMENTS WHEN READING THIS DRAWING.
- REFERENCE SHALL BE MADE TO ALL ARCHITECTURAL, STRUCTURAL AND OTHER DESIGN TEAM DRAWINGS AND DOCUMENTS WHEN READING THIS DRAWING.
- REFERENCE SHALL BE MADE TO THE CUDD BENTLEY CONSULTING ELECTRICAL EQUIPMENT SCHEDULE WHEN READING THIS DRAWING.
- REFERENCE SHALL BE MADE TO THE CUDD BENTLEY CONSULTING ELECTRICAL LEGEND SHEET WHEN READING THIS DRAWING.
- ALL ELECTRICAL WORKS SHALL BE IN ACCORDANCE WITH BS7671 WIRING REGULATIONS INCLUDING ALL AMENDMENTS.
- REFERENCE SHALL BE MADE TO THE CLIENTS EMPLOYERS REQUIREMENTS DOCUMENTS.
- REFERENCE SHALL BE MADE TO THE FIRE STRATEGY DOCUMENT WHICH DETAILS THE VARIOUS FIRE ALARM CLASSIFICATIONS AROUND THE DEVELOPMENT.
- ALL FIRE ALARMS SHALL BE IN COMPLIANCE WITH BS5839 (ALL PARTS).
- REFERENCE SHALL BE MADE TO THE FIRE ALARM SCHEMATICS WHEN READING THIS DRAWING.
- FIRE ALARM SERVICES SHALL BE CONTAINED ON ITS OWN DEDICATED CONTAINMENT IN COMPLIANCE WITH BS5839
- FIRE ALARM CABLING SHALL BE FP200 / FP800.
- ASPIRATING SYSTEMS FOR FIRE DETECTION SHALL BE INSTALLED AS SHOWN ON THIS DRAWING - SUBSTATION AND LIFT SHAFTS.
- ALL INTERNAL WIRING ASSOCIATED WITH THE LIGHTING SHOWN ON THE DRAWING SHALL BE PVC SINGLES (LSOH) CONTAINED WITHIN BELOW GROUND PVC / HDPE DUCTS.
- ALL INTERNAL WIRING ASSOCIATED WITH THE LIGHTING SHOWN ON THE DRAWING SHALL BE XPLE SWA LSOH CONTAINED WITHIN BELOW GROUND PVC / HDPE DUCTS.
- REFERENCE SHALL BE MADE TO THE LIGHTING SCHEMATICS WHEN READING THIS DRAWING.
- REFERENCE SHALL BE MADE TO THE BUILDING CONTROL DOCUMENTS WHEN READING THIS DRAWING.
- ALL MEP SERVICES SHALL BE SECURELY FIXED WITH METAL FIXINGS 500mm EITHER SIDE OF FIRE BATTS, SERVICES LETTERBOXES AND BWIC OPENINGS.
- ALL CABLING WITHIN FIRE ESCAPE ROUTES INCLUDING APARTMENTS SHALL BE SECURELY FIXED USING METAL CABLE TIES AND METALLIC FIXINGS INTO THE SLAB WHERE NOT ON METALLIC CONTAINMENT TO PREVENT PREMATURE COLLAPSE.
- ALL LIGHTING SHALL BE IN FULL ACCORDANCE WITH CIBSE LIGHTING GUIDES AND RELEVANT BRITISH STANDARDS.
- LIGHTING WITHIN LIFT SHAFTS SHALL BE INSTALLED BY OTHERS.
- EXTERNAL LIGHTING AND FIRE ALARMS SHALL BE SUITABLE FOR THE ENVIRONMENT - IP RATED WHERE REQUIRED.
- LIGHTING SERVING EXTERNAL AREAS WITHIN APARTMENTS DENISE TO BE SERVED FROM TENANT CONSUMER UNIT WITHIN APARTMENTS UTILITY CUPBOARD.
- ALL ELECTRICAL EQUIPMENT IS EQUAL AND APPROVED UNLESS OTHERWISE SPECIFIED.

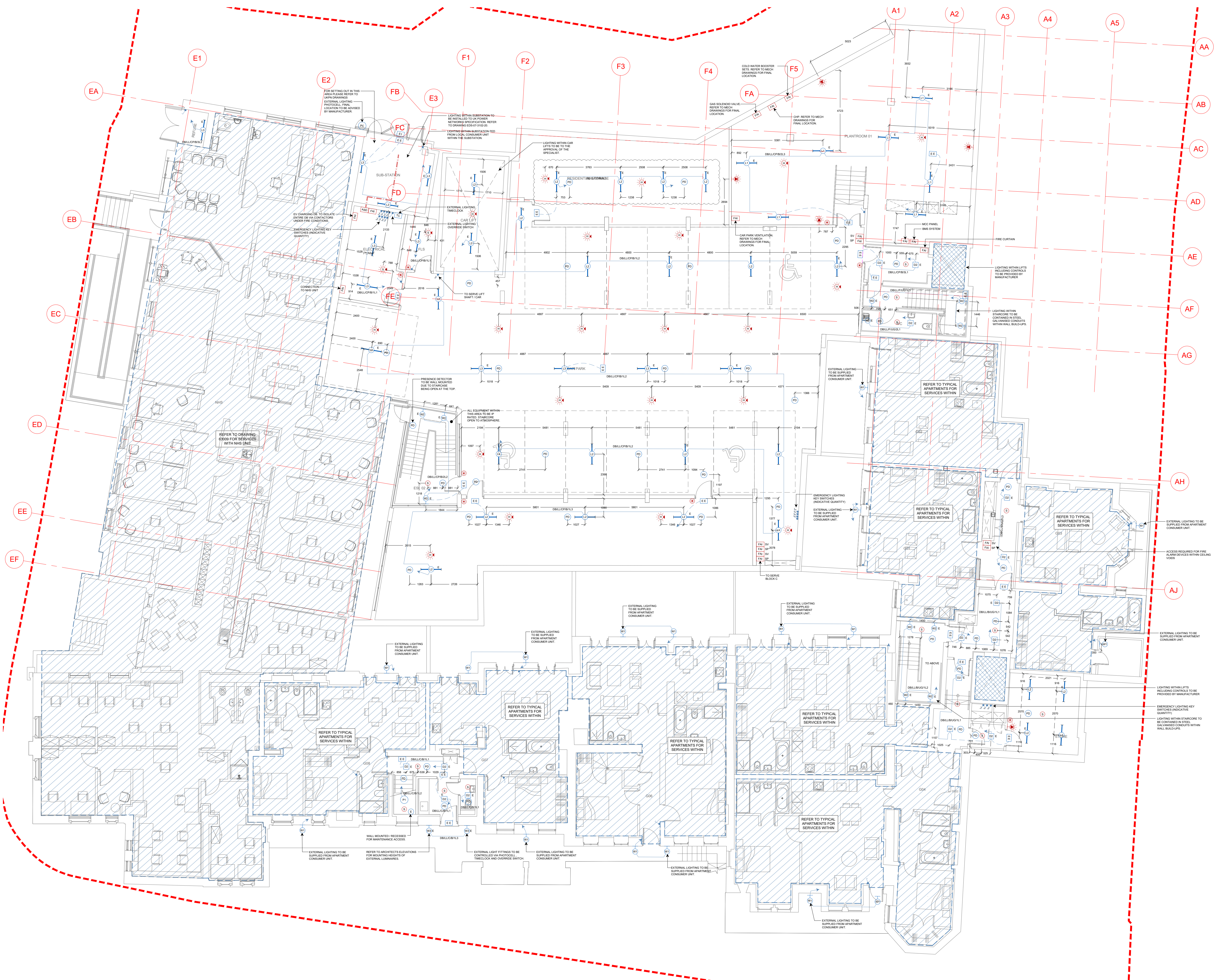

Revision	Description	Drawn By	Engineer	Approved	Date
C01	ISSUED FOR CONSTRUCTION	LSH	NO	AF	15-11-21



Cudd Bentley Consulting Ltd.
 Ashurst Manor
 Church Lane
 Ascot
 Berkshire
 SL5 7DD
 (t) 01344 62 8821
 (e) info@cuddbentley.co.uk

Cudd Bentley Consulting Ltd.
 Suite 1
 Shely Crescent Centre
 20 Fairhouse Way
 Solihull
 B50 4EH
 (t) 0121 711 4343
 (e) info@cuddbentley.co.uk

Cudd Bentley Consulting Ltd.
 12 Deodar Street
 W1G 7AB
 (t) 0203 393 6446
 (e) info@cuddbentley.co.uk

STAGE 5

Client: UKI RICHMOND LTD

Project/Site Location: RICHMOND ROYAL HOSPITAL

Drawing Title: ELECTRICAL SERVICES LOWER GROUND FLOOR LIGHTING AND FIRE DETECTION LAYOUT

Scale	Size	Drawn By	Engineer	Approved	Date
1:100	A1	HF	NO	AF	Apr'21

Drawing Reference: 5672-CBC-XX-LG-DR-E-63001