

FOR PLANNING PURPOSES ONLY

To be read in conjunction with other relevant drawings and information.

Dimensions are indicative only, to be checked on site.

Any discrepancies to be brought to the attention of the architect.

Do not scale from drawings

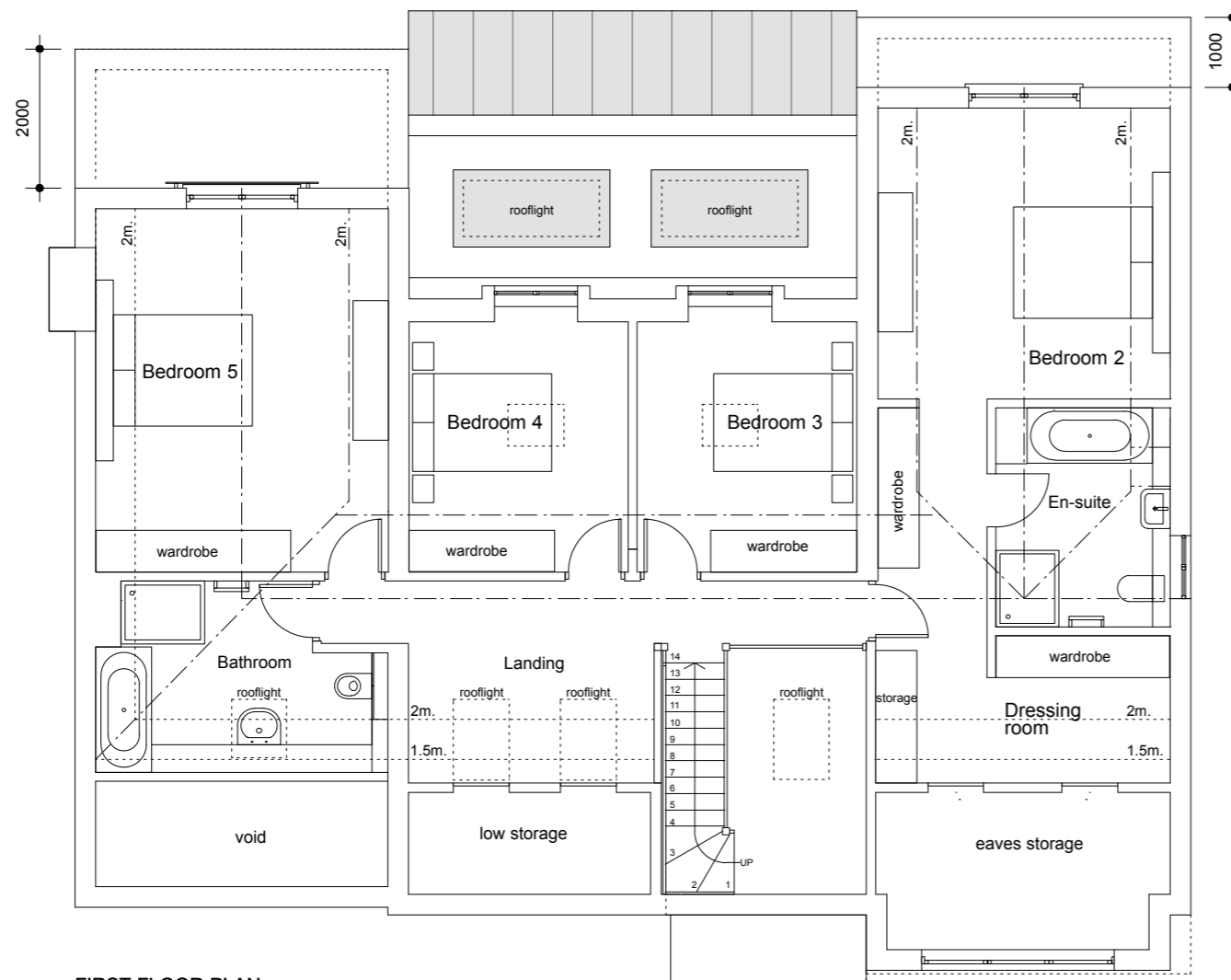

FIRST FLOOR PLAN

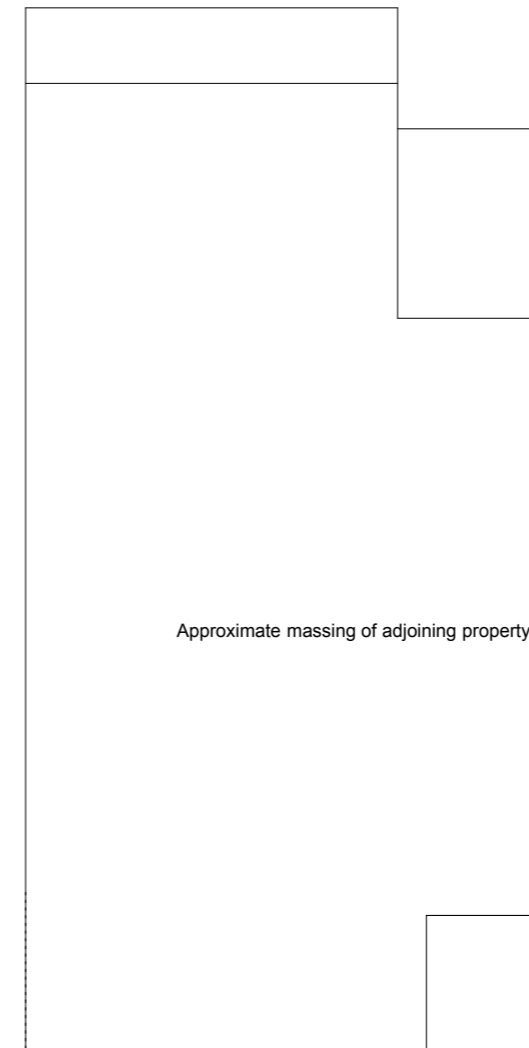

Approximate massing of adjoining property

T A N G L E W O O D

Gross Internal Area (proposed):
 Ground Floor (including garage): 183.5m²
 First Floor (over 1.5m head height): 116.0m²
 Total gross internal area: 299.5m²

Gross Internal Area (existing):
 Ground Floor (including garage): 129m²

Total additional gross area: 170.5m²

Rev. A: 14:06:24: General amendments following client feedback. PD

Westbourne,
 Marlborough Road,
 Hampton. TW12 3RX

First Floor plan as proposed

JOB NO	0818	DWG NO	PR02	DRAWN	PD
--------	------	--------	------	-------	----

DATE	06/24	SCALE	1:100 @A3	REV	A
------	-------	-------	-----------	-----	---

dtr architects limited

94 Innes Gardens, London SW15 3AD.
 Ph: 020 87892705
 e-mail: mail@dtr.uk.com