

EXISTING &
PROPOSED

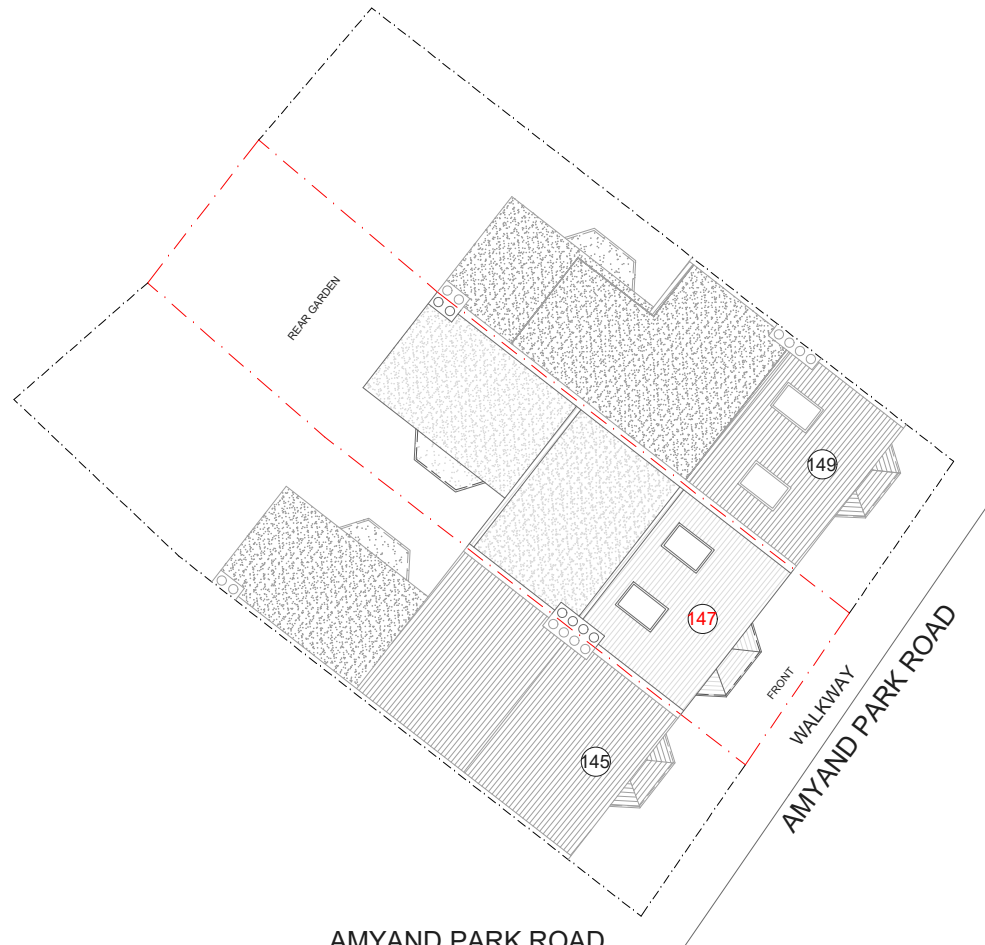

AMYAND PARK ROAD
EXISTING SITE/BLOCK PLAN

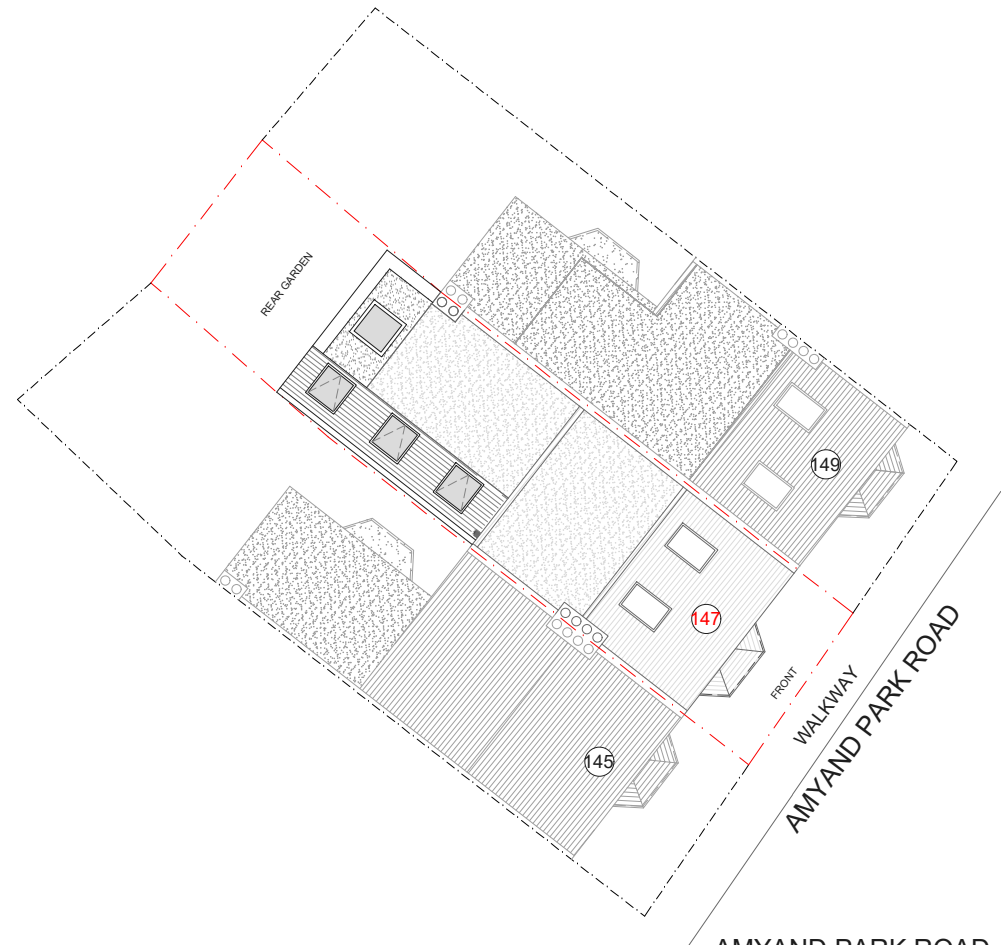

AMYAND PARK ROAD
PROPOSED SITE/BLOCK PLAN



Drawn by:
A-A

Project:
147 Amyand Park Road, Twickenham, Greater London, TW1 3HN

Date:
17.06.2024

No.:
PP-06

Client:
Mel Marriott

Drawing Title:
SITE PLAN

Scale @A3:
1:200

Rev:

Page:

