

Line of 30mins fire rated profile fillers to top profiles of structural roof decking to limit cavity formed by profiles to max 20m.
 Corresponding plates for fillers fixed to top of decking

Hatched area denotes indicative location of PV panels.
 Layout, design and details TBC by MSE Contractor.
 PV array to be a minimum of 4m from roof edge

Area 1

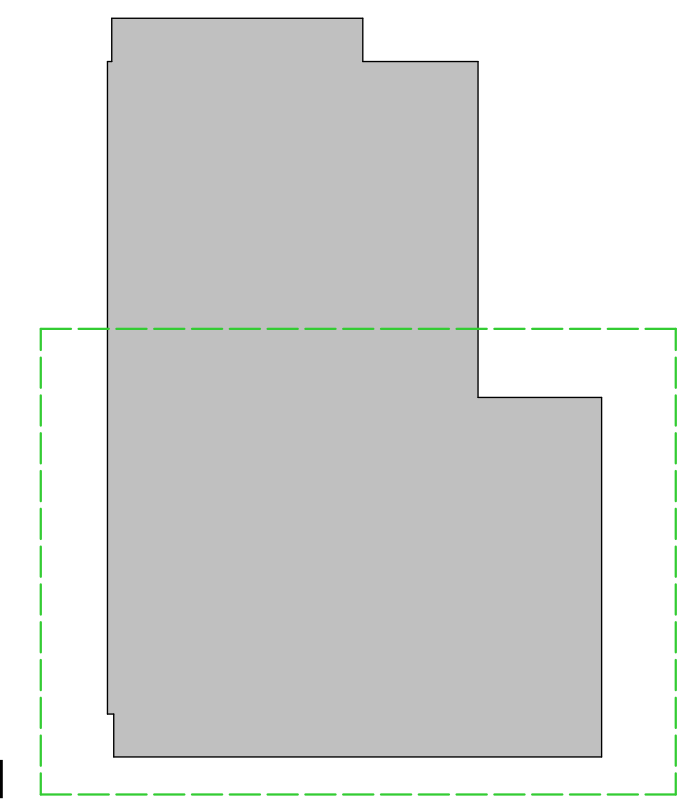

CDM Residual Risks and Actions:

1. Building is within an operating educational establishment. Contractor to have adequate and appropriate site management in place to separate construction from school personnel.
2. Photovoltaic panels and green roof accessed via dedicated external stair (north elevation) and/or roof access hatch from first floor circulation (room 101). First floor to be closed off to end users while roof is being inspected/maintained as part of school management and staff / personnel to be trained in use of fall restraint system.
3. Cleaning of fenestration is via long reach pole or similar.

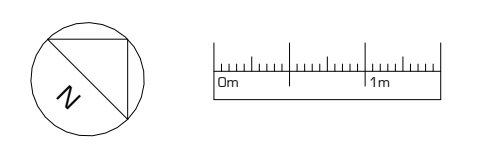

ALCOVE ARCHITECTURE
 / 25a New Broadway Worthing Sussex BN11 4HP
 01903 608448 / www.alcovearchitecture.co.uk

Project
RTS Sports Hall Development

Drawing Title
Setting Out Plan - Roof - Area 1

Status	Date
Construction	Aug 23
Scale	Revision
1 : 50@A1	SB
Project No.	Drawing No.
22137 - ALC - XX - RF - A - DR - 6104	CO1

Alcove Architecture Ltd - Registered No. 8543375

R-Roof-Area 1
 1 : 50