

FRONT ELEVATION (EAST)

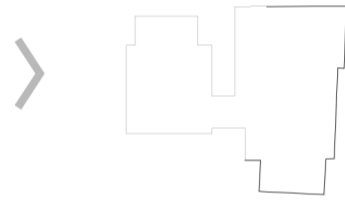

REAR ELEVATION (WEST)

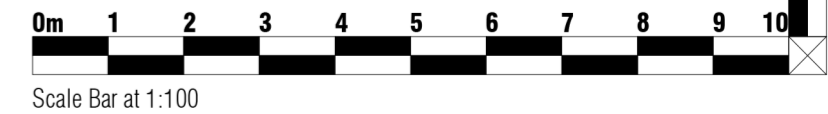
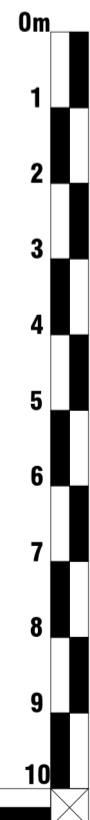

REV C - AIR HANDLING UNITS MOVED TO GROUND FLOOR AND HALL END MODULE
 REDUCED IN SIZE - 05.03.23
 REV B - HOUSE NO.39 ADDED AND DRAWING CHANGED TO A2 SIZE - 11.01.23

COPYRIGHT: This drawing is copyright and may not be altered, reproduced or used other than for the Contract Works for which it is issued without the written permission of Squires and Brown Ltd.

 Chartered Practice	squires and brown architects and building surveyors	MALLORY HOUSE GOOSTREY WAY MOBBERLEY CHESHIRE WA16 7GY 01565 872 288 info@squiresandbrown.co.uk www.squiresandbrown.co.uk
		PROJECT No. 1829

Hampton Pre-Prep School
Pre-Prep Hall

15 August, 2022
 1:100 @ A2
Planning Application

Drawn by MR
Proposed Elevations
A-160

Rev
C