

In ground protection areas, ground protection panels must be laid over the hard surfacing to protect any underlying roots. Trakmats, as supplied by either the Marwood Group, (www.marwoodgroup.co.uk) or Ground-Guards, (www.ground-guards.co.uk) or a similar approved product, must be used, laid on a compressible layer of sand or woodchips, with adjacent panels held together with connectors.

CASTELNAU

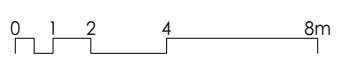
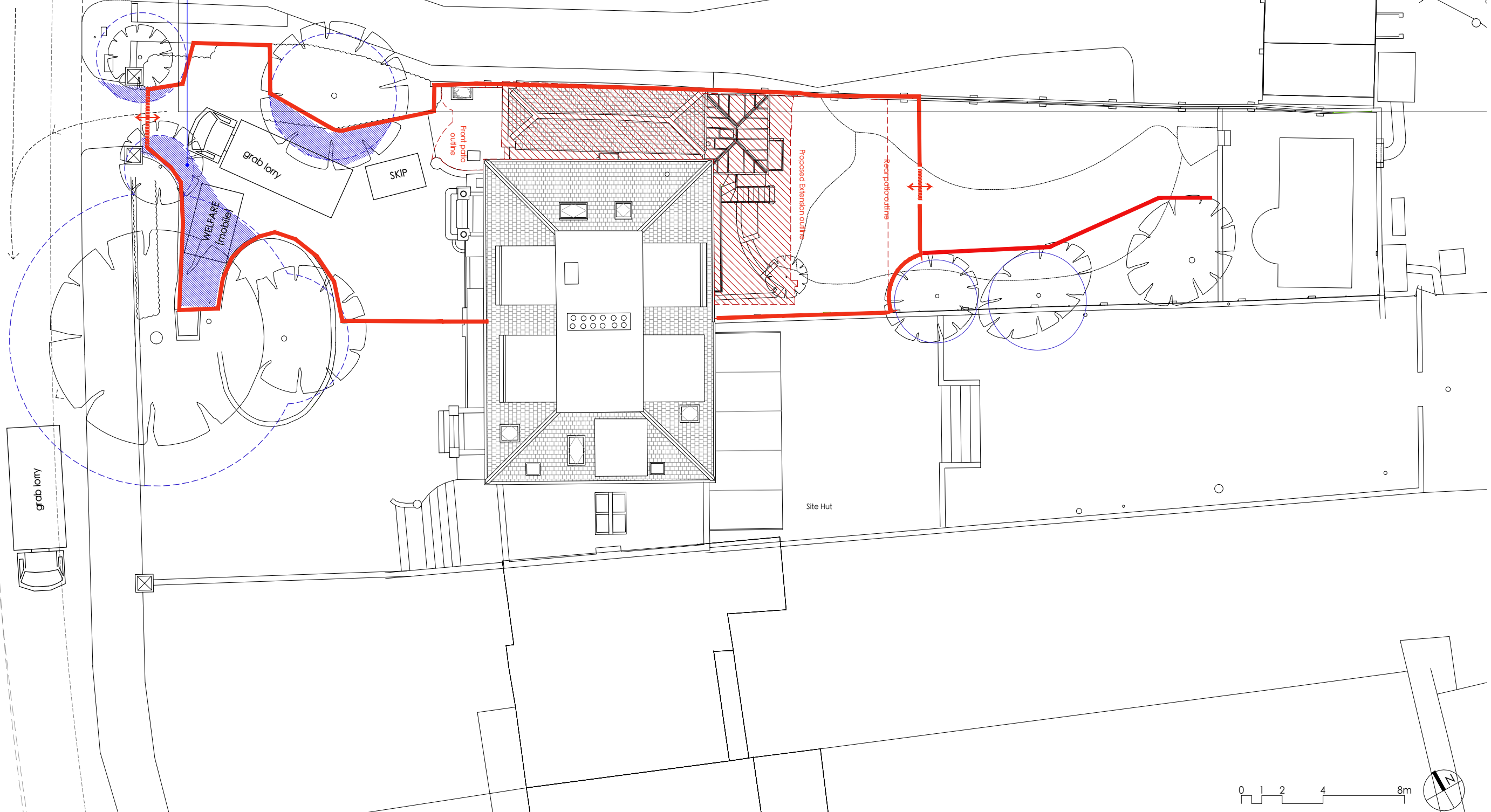
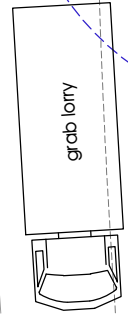
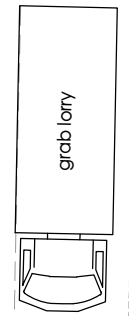

MICHAEL JONES ARCHITECTS
 020 8948 1863 | 129 Kew Road, Richmond, TW9 2PN
www.mjarchitects.co.uk | studio@mjarchitects.co.uk

job title
122 Castelnau, Barnes, SW139EU
 client
Mr and Mrs Taunton

drawing title	scale	1:200pt A3
Proposed Site Works - Grab Lorries	date	June 2024
drawing number	rev	drawn by AT
1664.03.03.Pl01.005		checked by AB