

01 Existing Ground Floor Plan
1:100

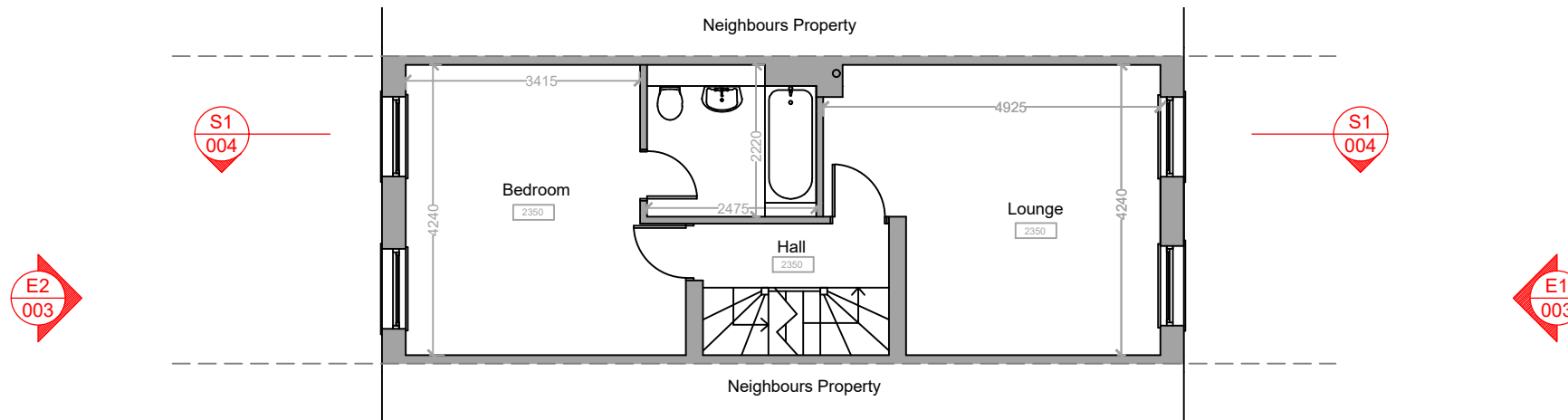

02 Existing First Floor Plan
1:100

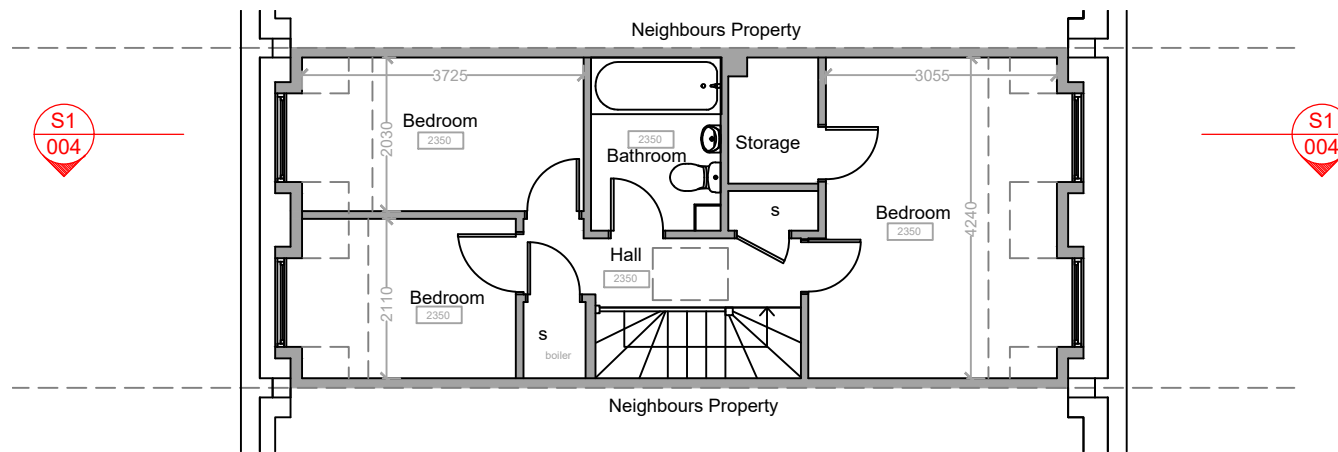

03 Existing Second Floor Plan
1:100

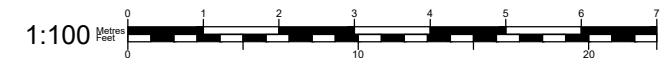

50° North

50° North Architects
The Hut, 187 Kew Road
Richmond, Surrey TW9 2AZ

info@50degrees.co.uk
020 8744 2337
50degrees.co.uk

project north

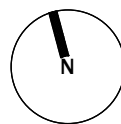

notes

1. Do not scale off this drawing. All dimensions are to be site verified by the contractor prior to proceeding.
2. Contractor to be responsible for complying with all current Building Regulations, to satisfaction of the Building Control Officer.
3. Any errors or inconsistencies are to be reported to 50 Degrees North for clarification.
4. The red boundary line is to identify the property only and is not intended to identify ownership boundaries.

key plan
not to scale

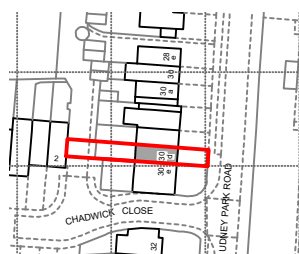

revisions

REV	DATE	DRAWN BY	APPR. BY	NOTES
-	2024.05.10	KRM	LB	first issue

client:

DAVID & LIZ BREWIN

project:

**30D UDNEY PARK ROAD
TEDDINGTON TW11 9BG**

status:

PLANNING

revision:

title:

EXISTING FLOOR PLANS

drawn by:

KRM

approved by:

LB/TB

date:

03.05.2024

job no:

2742

scale:

1:100@A3

drawing no:

002