



ANDYSTURGEON DESIGN

696 SPRING TERRACE

BOUNDARY HEDGE REPORT

JULY 2024

696-00-RP-240701-V1

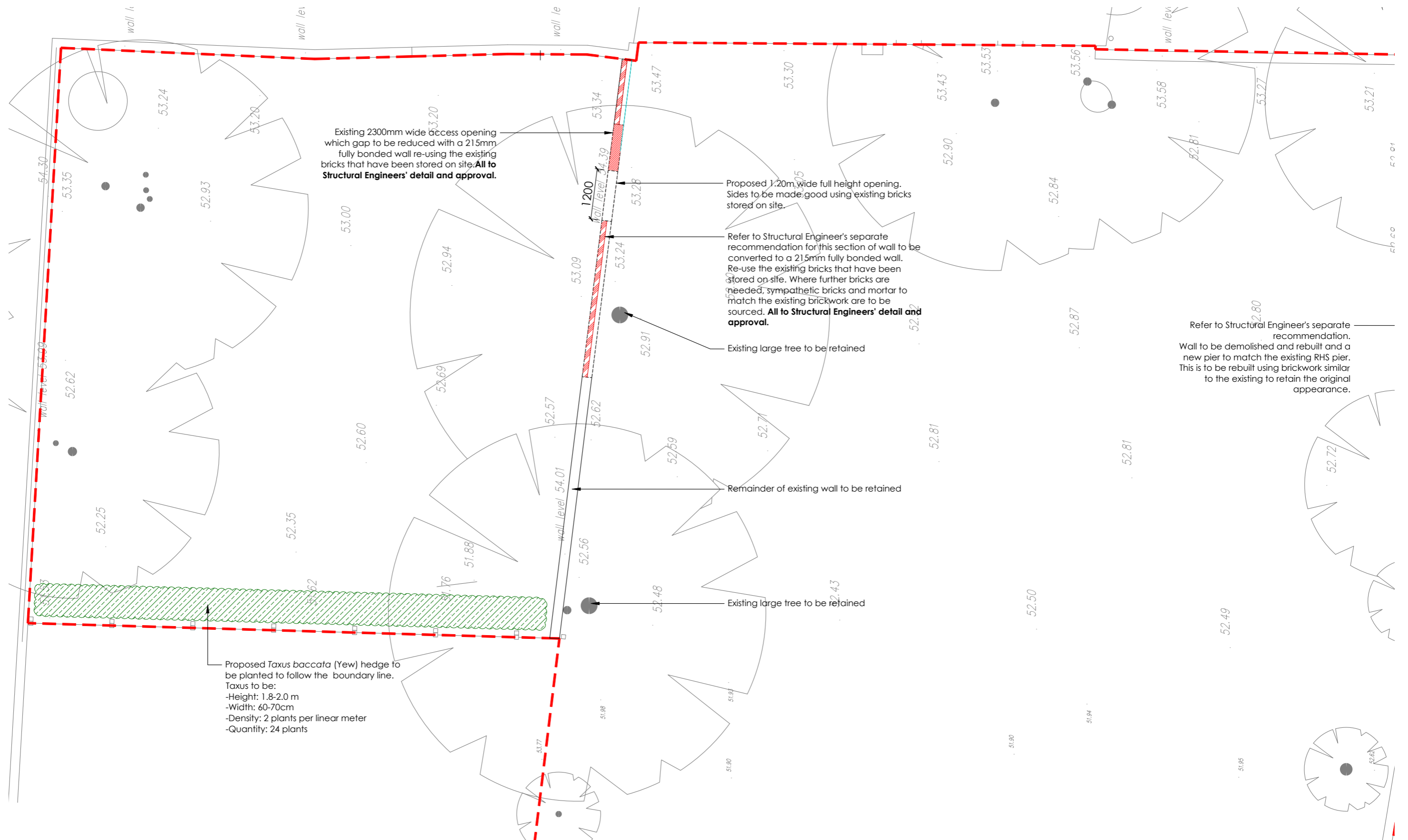

Existing 2300mm wide access opening which gap to be reduced with a 215mm fully bonded wall re-using the existing bricks that have been stored on site. **All to Structural Engineers' detail and approval.**

Proposed 1.20m wide full height opening. Sides to be made good using existing bricks stored on site.

Refer to Structural Engineer's separate recommendation for this section of wall to be converted to a 215mm fully bonded wall. Re-use the existing bricks that have been stored on site. Where further bricks are needed, sympathetic bricks and mortar to match the existing brickwork are to be sourced. **All to Structural Engineers' detail and approval.**

Existing large tree to be retained

Refer to Structural Engineer's separate recommendation. Wall to be demolished and rebuilt and a new pier to match the existing RHS pier. This is to be rebuilt using brickwork similar to the existing to retain the original appearance.

Remainder of existing wall to be retained

Existing large tree to be retained

Proposed *Taxus baccata* (Yew) hedge to be planted to follow the boundary line. Taxus to be:
 -Height: 1.8-2.0 m
 -Width: 60-70cm
 -Density: 2 plants per linear meter
 -Quantity: 24 plants

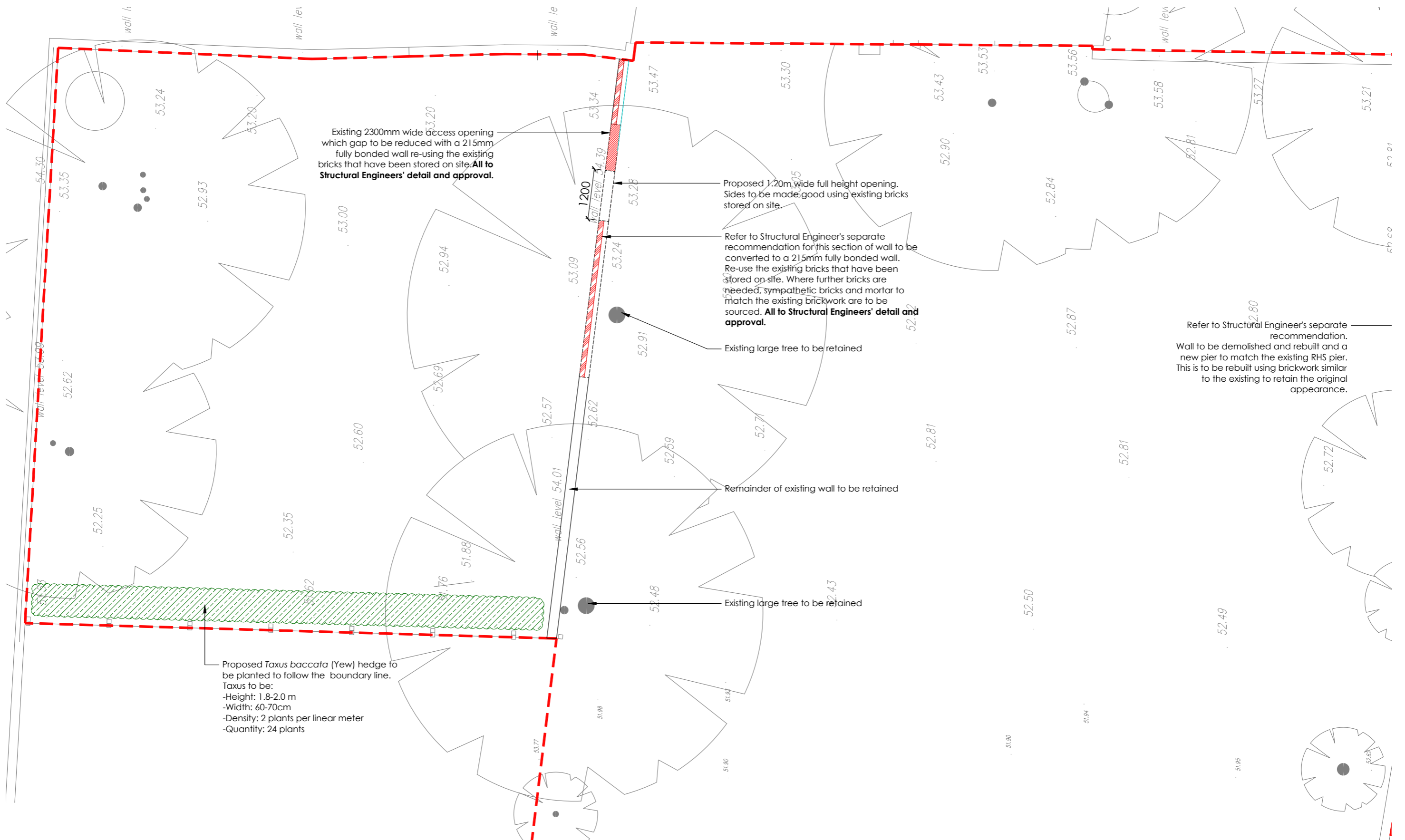

Proposed Hedge specification:

Species: Taxus baccata

Height : 1.8 - 2.0m

Width: 60-70cm

Density: x2 plants per meter

Total plants: 24

Example picture hedging as supplied:



Maintenance:

Newly planted yews should be watered regularly for at least the first year, until their roots have spread out into the soil. An irrigation system will be installed however the hedge will still require hand watering until established. Its important the hedge is not overwatered and that the root balls don't become waterlogged.

The Hedge should be trimmed once a year in summer. Trimming the top will encourage growth at the sides so it is vital to do this to keep the plants bushy.

Every other year, mulching with composted bark fines will feed the hedges and keep them strong.

Case study:

Taxus baccata hedge, 1.8-2.0m upon planting, June 2023.

Instant screen with no gaps between hedging



Taxus baccata hedge, 1.8-2.0m after 1 year, June 2024.

Hedge trimmed and filled out providing a neat consistent look.

