

Proposals include the creation of two areas of biodiverse green roof with approximately 52m² in total, one will be integrated into the proposed first floor plan for the new cricket pavilion (approx. 30m²) and the other created on the flat roof of the new cricket pavilion above the bar/ kitchen area (approx. 22m²). These areas will benefit biodiversity, create more opportunities for invertebrates, bats, and birds, and contribute to biodiversity net gain on Site.

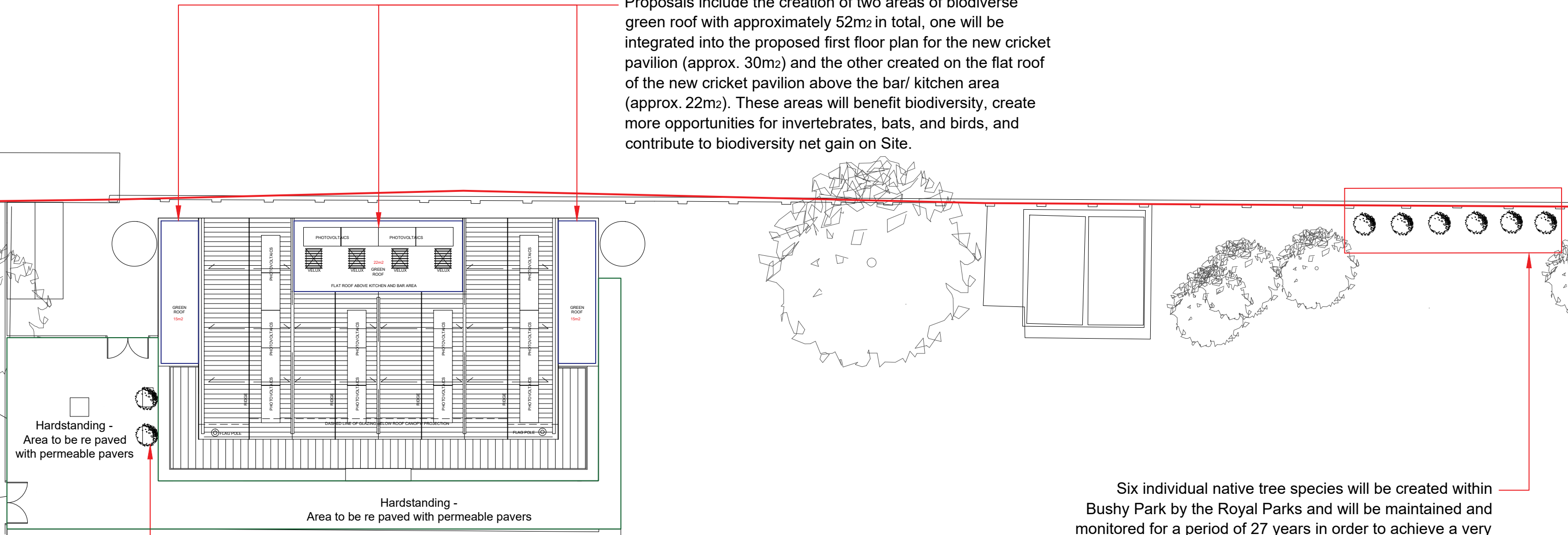

Six individual native tree species will be created within Bushy Park by the Royal Parks and will be maintained and monitored for a period of 27 years in order to achieve a very large size and a moderate condition. The total area of these trees will be 4584.90m².

**NOTE; POSITION INDICATIVE.
LOCATION OF TREES TO BE CONFIRMED BY ROYAL PARKS.**

Two individual planters to be placed at the bottom of each strip window.
Soft planting, grasses and flora, hardy varieties.



Notes

- All dimensions are to be verified by the Contractor on site, any discrepancies in this drawing are to be reported to Aros Ltd
- The Contractor shall not vary any work shown on this drawing without prior approval in writing from Aros Ltd.
- The Contractor shall supply a full set of shop drawings and specifications prior to commencement of work.
- This drawing supersedes all previous issues of the same drawing number with an earlier revision suffix.
- The Contractor shall immediately inform Aros Ltd of the effect upon the programme and costs of any alterations to the proposed works shown on this drawing.
- This drawing is the copyright of Aros Ltd and the contents must not be disclosed to other parties without prior agreement.

Revisions

Rev	Date	Drawn	Checked	Description
	XX.XX.XX			

Project
HWRCC PAVILION
Title
PROPOSED LANDSCAPE PLAN

Project No 6344	Drawing No (20) 105
Date JULY 2024	Scale 1:200 @ A3
Status PLANNING	Rev