

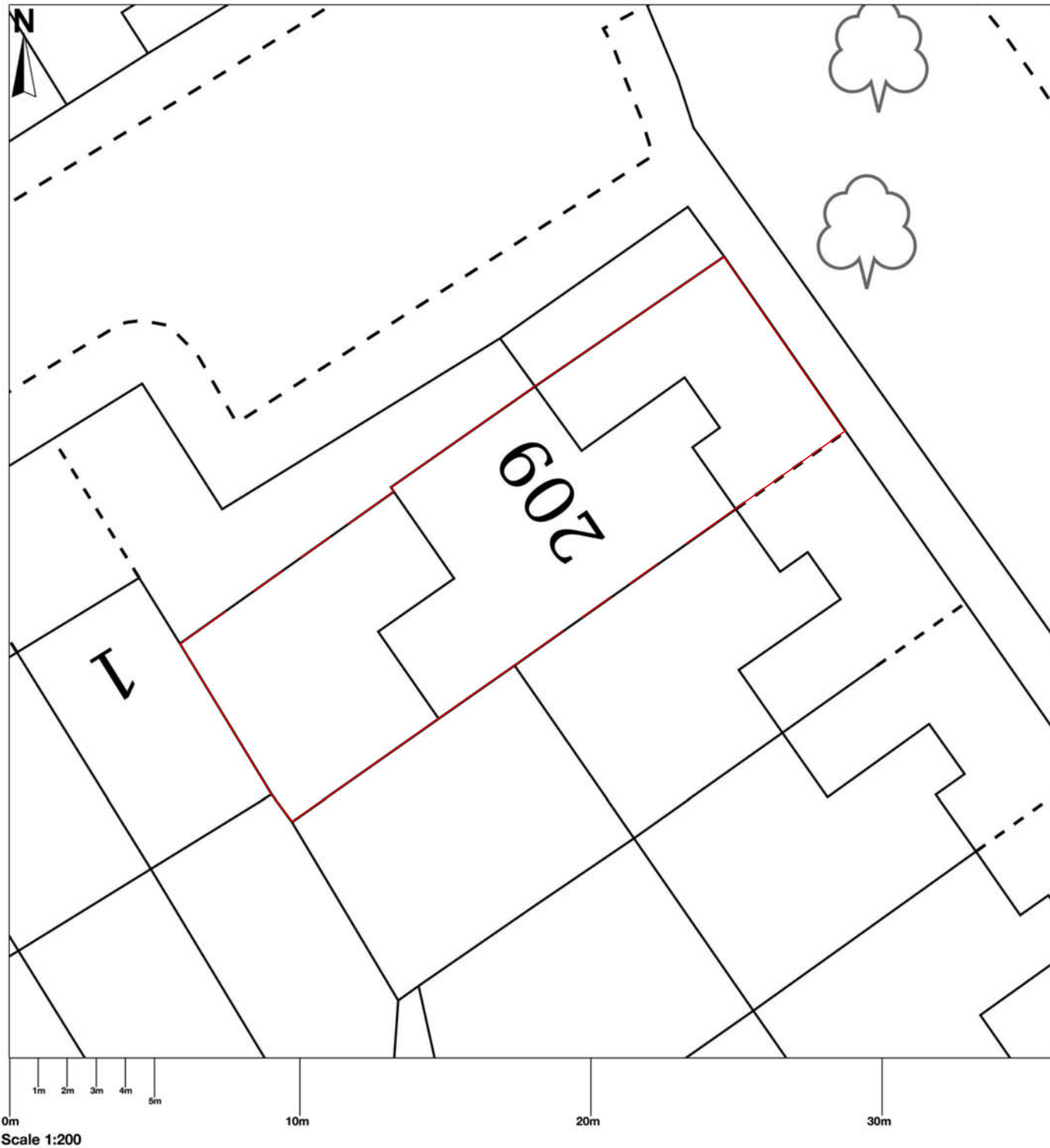

209 Ashburnham Road, Richmond, TW10 7SE



© Crown copyright and database rights 2024 OS 100054135. Map area bounded by: 516800,172256 516836,172292. Produced on 04 April 2024 from the OS National Geographic Database. Supplied by UKPlanningMaps.com. Unique plan reference: b36e/uk/1082244/1457025



Notes Please report any discrepancies on the drawing to LA immediately. Do not measure off the drawing. All dimensions to be checked on site.		Location London Atelier <i>Architecture, Interior, Museum and Exhibition Design</i> Studio 7 160 Barby Road London W10 6BS +44 (0) 20 3490 2140 info@londonatelier.com www.londonatelier.com		Drawing Status Certificate of Lawful Development							
<table border="1"> <thead> <tr> <th>Revision</th> <th>Description</th> <th>Date</th> </tr> </thead> <tbody> <tr> <td>PPO</td> <td>First Issue</td> <td>dd/mm/yy</td> </tr> </tbody> </table>		Revision	Description	Date	PPO	First Issue	dd/mm/yy	Project Title 209, Ashburnham Road, Ham, Richmond Upon Thames, TW10 7SE		Drawing Title Block Plan	
Revision	Description	Date									
PPO	First Issue	dd/mm/yy									
Drawing No. LA132_001		Rev. PP0		Scale 1.200 @A3							
				Date 09/07/2024							