

**general notes**

All dimensions to be verified on site. To be read in conjunction with all relevant documents. In the event of discrepancy notify the Architect immediately. This document is copyright of Lorna Mishan. All drawings subject to planning approval. Do not scale from drawings.

SK Concept Information PP pre-planning  
P Planning level S Scheme T Tender  
BC Building control level Information C Construction  
E Existing Condition

**Note 1:** This drawing is not to be scaled for construction purposes. Any dimensions provided on these drawings and the general layout can only be considered approximate as no measured survey has been conducted. Immediately after taking possession of the site the contractor should fully check the levels and dimensions of the site in order that he is fully satisfied with and accepts the drawings as a true record of the situation on taking possession of the site. Any discrepancies to be discussed with architect.

**Note 2: DRAWINGS + INFORMATION FOR USE AT 145 PETERSHAM ROAD ONLY**

**DRAWING KEY**

- indicative only not surveyed
- new stud partitions treated timber stud to match existing with 12.5mm plasterboard taped jointed and skimmed either side (wetroom/tanking system and tile backer board shower room side) unless otherwise noted
- fitted storage secured back to but separate from existing walls
- NEW DOORS THROUGH OUT FIRST FLOOR**  
All new FD20 doors. Allow new openings for 762x1981mm doors. New doors in existing openings. Retain detail over doors.
- tiled areas
- Bathroom ventilation. 15 L/S. connected to existing fan route to external air

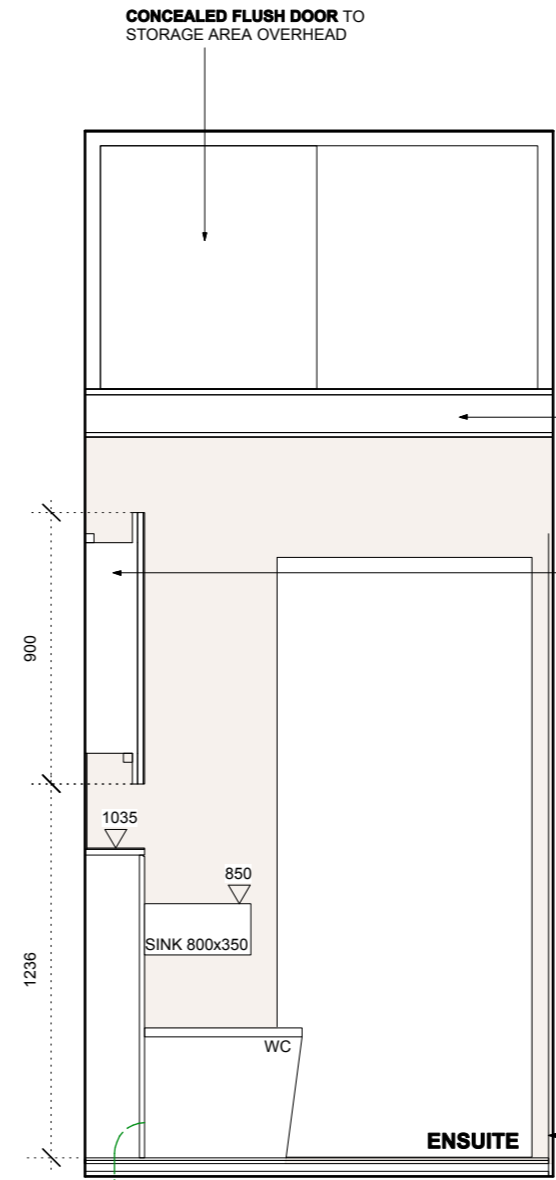
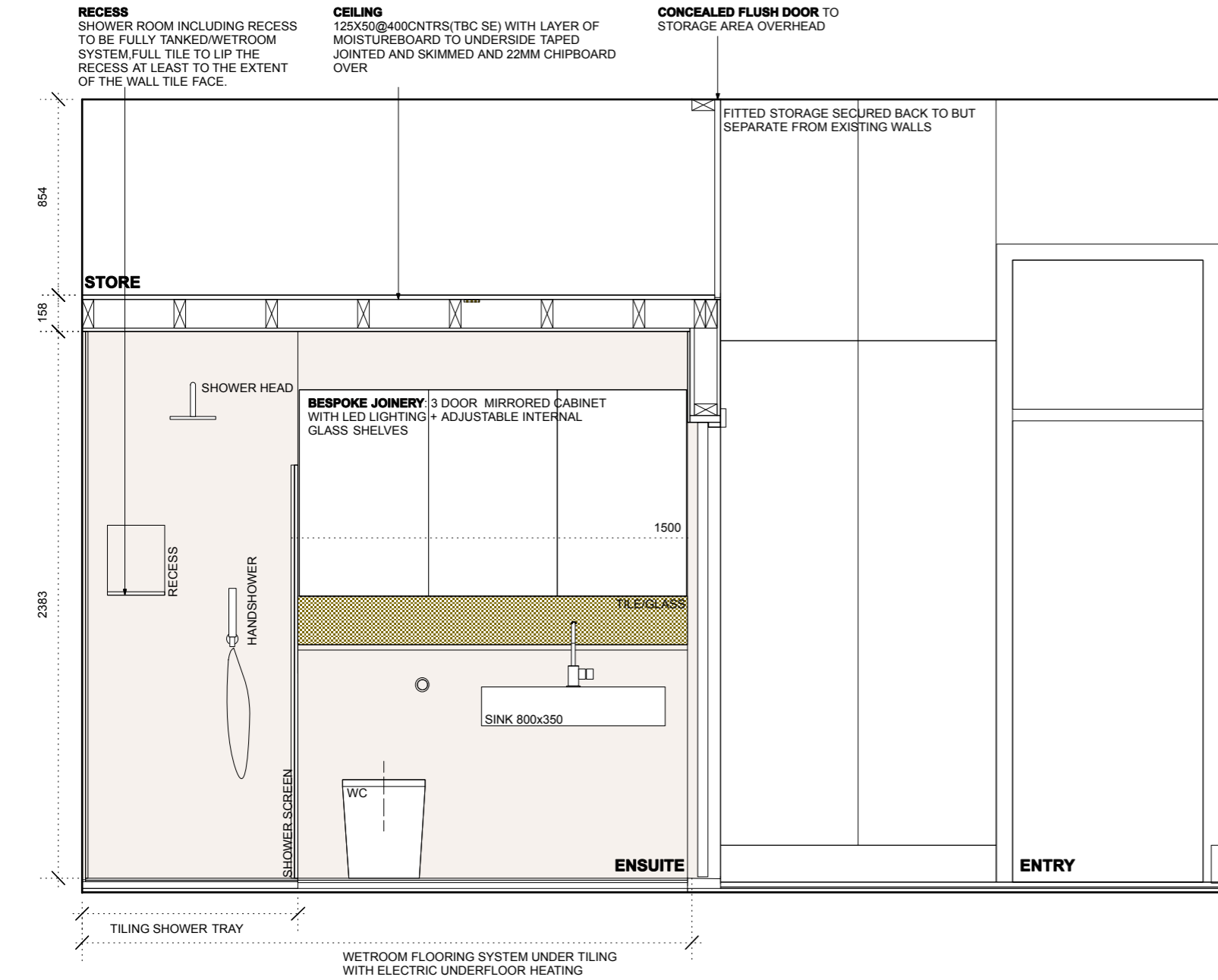

**CEILING**  
125X50@400CNTRS(TB C SE) WITH LAYER OF MOISTUREBOARD TO UNDERSIDE TAPED JOINTED AND SKIMMED AND 22MM CHIPBOARD OVER

**BESPOKE JOINERY:** 3 DOOR MIRRORED CABINET WITH LED LIGHTING + ADJUSTABLE INTERNAL GLASS SHELVES

TILED SKIRTING GROUT LINES TO ALIGN WITH FLOORING

(E): scale bar added	(10.07.24/LM)
(D): issued for comment	(02.07.24/LM)
(C): issued for comment	(26.06.24/LM)
(B): issued for comment	(20.06.24/LM)
(A): issued for comment	(11.06.24/LM)
(-): issued for comment	(03.06.24/LM)

(rev): description	(date/initials)
--------------------	-----------------

**THE HOUSE**  
**Proposed main suite entry + ensuite 1**

1:25@A3 MAY 2024

HOU-P-03(E)