

PRIOR TO THE COMMENCEMENT OF ANY WORKS, THE BUILDER IS TO CHECK AND/OR DETERMINE ALL CONSTRUCTION DETAILS, INCLUDING CHECKING EXISTING SITE LEVELS AND DIMENSIONS. THE DRAWING IS TO BE READ IN CONJUNCTION WITH ALL OTHER PROJECT DRAWINGS, CONSTRUCTION NOTES AND/OR PROJECT SPECIFICATION. ALL DISCREPANCIES SHOULD BE REPORTED IMMEDIATELY.

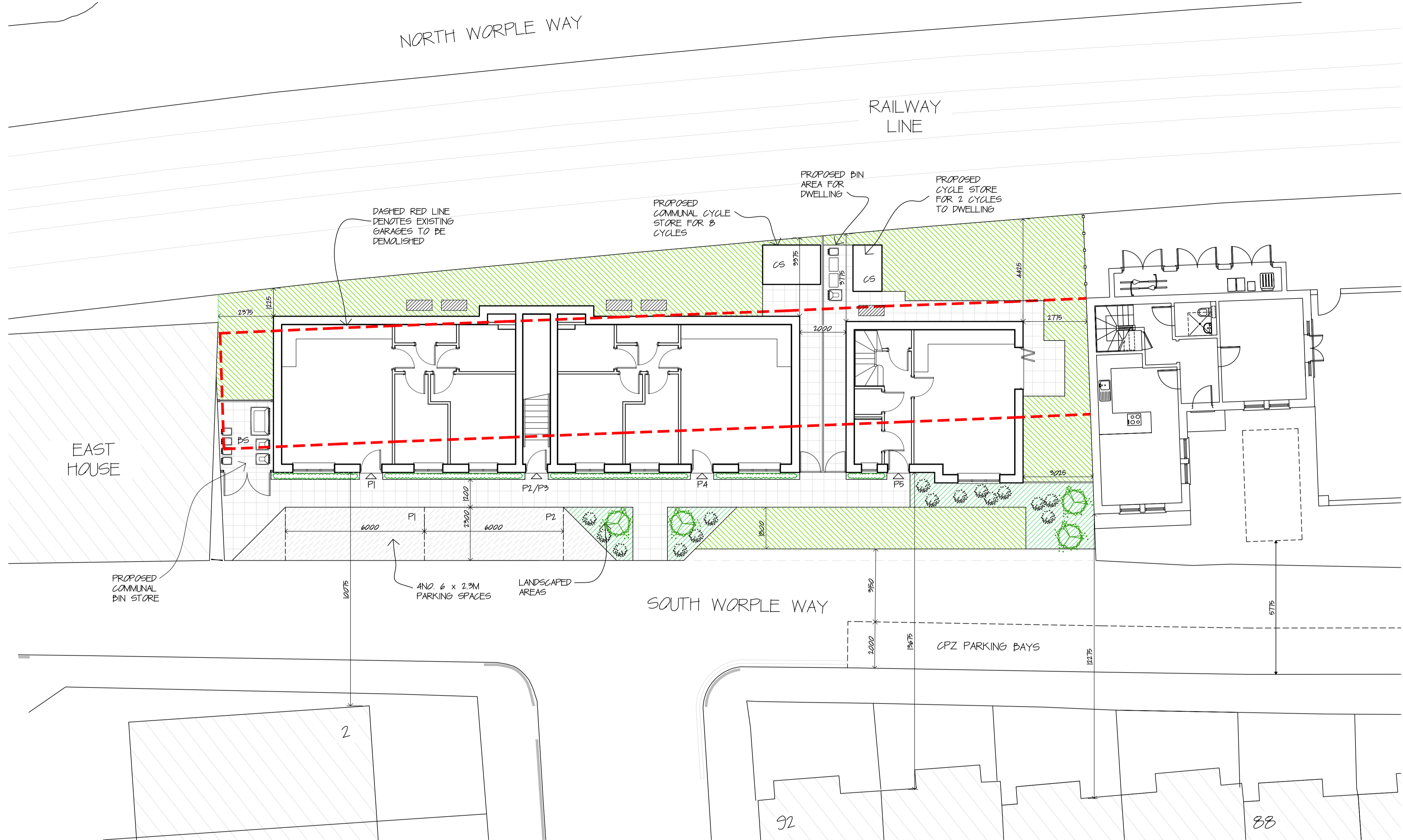

ASHP LOCATIONS

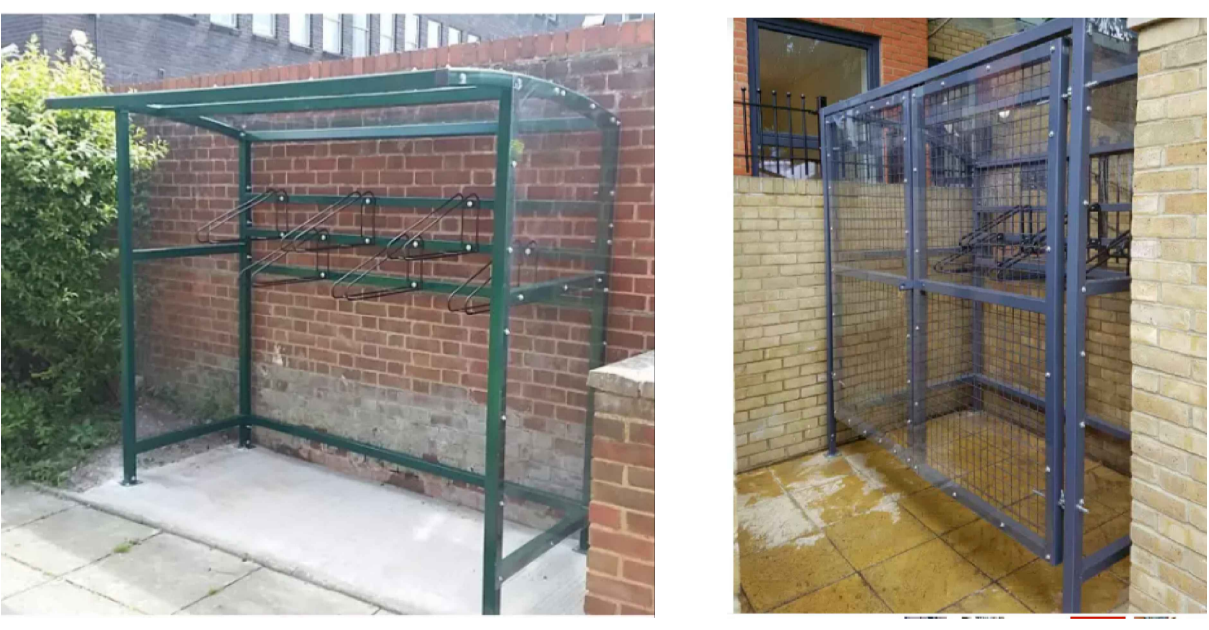

INDICATIVE IMAGE OF PROPOSED COMMUNAL CYCLE STORE

WASTE CALCULATIONS
 IN ACCORDANCE WITH LONDON BOROUGH OF RICHMOND REFUSE AND RECYCLING STORAGE REQUIREMENTS' FOR ONE 2 BEDROOM HOUSE THE FOLLOWING SHOULD BE PROVIDED:
 240L REFUSE
 102L DRY RECYCLING (2 NO 55 LITRE RECYCLING BOXES)
 29L FOOD PER UNIT
 FOR FOUR 2 BEDROOM FLATS THE FOLLOWING SHOULD BE PROVIDED:
 560L REFUSE (BASED ON 70 LITRES PER BEDROOM)
 400L DRY RECYCLING (1 NO 240 LITRE BIN FOR MIXED PAPER AND 1 NO 240 LITRE BIN FOR MIXED CONTAINERS)
 29L FOOD PER UNIT

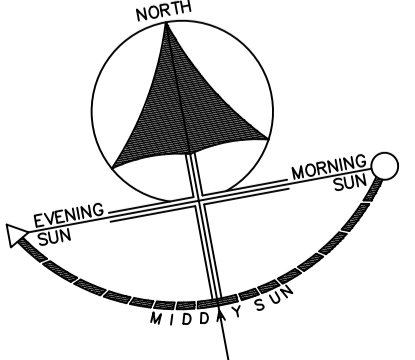

Rev	Date	Details	JC
	05.02.24	PARKING SPACES 3 & 4 OMITTED TO ALLOW FOR FIRE BRIGADE ACCESS FOLLOWING DISCUSSIONS WITH PLANNERS.	JC
			Drawn

Client:

01932 832277

Site Address:
 SOUTH WORPLE WAY
 EAST SHEEN, LONDON

Description:
 PROPOSED SITE PLAN

Status:	PLANNING		
Date:	NOV 2022	Scale:	1:100@A1
Drawn:	MN	Checked:	TCA
Job Number:	1332	Drawing Number:	03
		Revision:	A

Dorset House,
 297-299 Kingston Road,
 Leatherhead,
 KT22 7PL
 Tel: 01372 466443
 Email: info@tcalimited.com
 www.tcalimited.com

THIS DRAWING IS THE COPYRIGHT OF TAYLOR COX ASSOCIATES AND MUST NOT BE USED IN CONJUNCTION WITH ANY OTHER PROJECT WITHOUT WRITTEN CONSENT.