

Notes

Simon Merryon Architects Limited has prepared this document in accordance with the instructions of the Client under the agreed appointment.

This document is for the sole and specific use of the Client. Simon Merryon Architects shall not be responsible for any use of its contents for any purpose other than that for which it was prepared and provided.

This drawing must not be used on site unless issued for construction.

Do not scale from this drawing. All dimensions to be site checked and verified. Any deviations to be reported and confirmed. If in doubt ask.

No encroachment is permitted over adjoining neighbours' boundary without prior written agreement between both parties. True line of boundary and ownership to be established on site.

Neighbouring properties have not been surveyed.

Should the Client pass copies of this document to other parties, this should be for co-ordination purposes only. In this case no professional liability or warranty shall be extended to the other parties without the explicit written agreement of Simon Merryon Architects Limited.

© Simon Merryon Architects 2024

Revision	Date	Comment	Published by
A	07.08.24	PLANNING	HAB

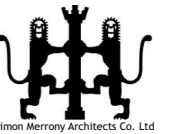

SIMON MERRYON ARCHITECTS
 34 Thames Street
 Sunbury-on-Thames
 TW16 6AF

Job Title
**219 Staines Road
 Twickenham
 TW2 5AY**

Drawing Name
Proposed Site Plan

Drawing Status
PLANNING

Published by
SG Date 07/08/2024

Checked by
SM Date 07/08/2024

Drawing Scale
As Shown @ A3

Drawing no. Revision
2024/08/PP01 A

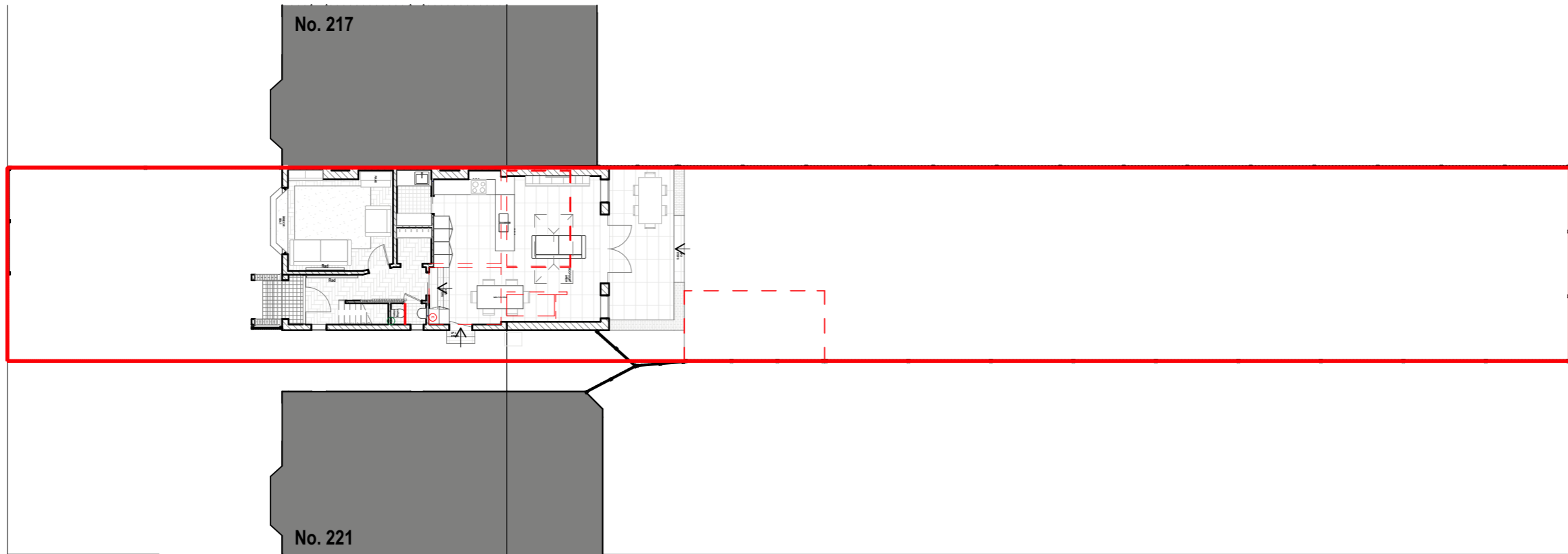

Site Plan

1:200