

DO NOT SCALE FROM THIS DRAWING - STATED DIMENSIONS REFER TO THE ORIGINAL DRAWING. CONTRACTORS SHALL BE RESPONSIBLE FOR CHECKING OF ALL DIMENSIONS AND SPECIFICATIONS PRIOR TO ANY CONSTRUCTION OR FABRICATION WORKS COMMENCING.

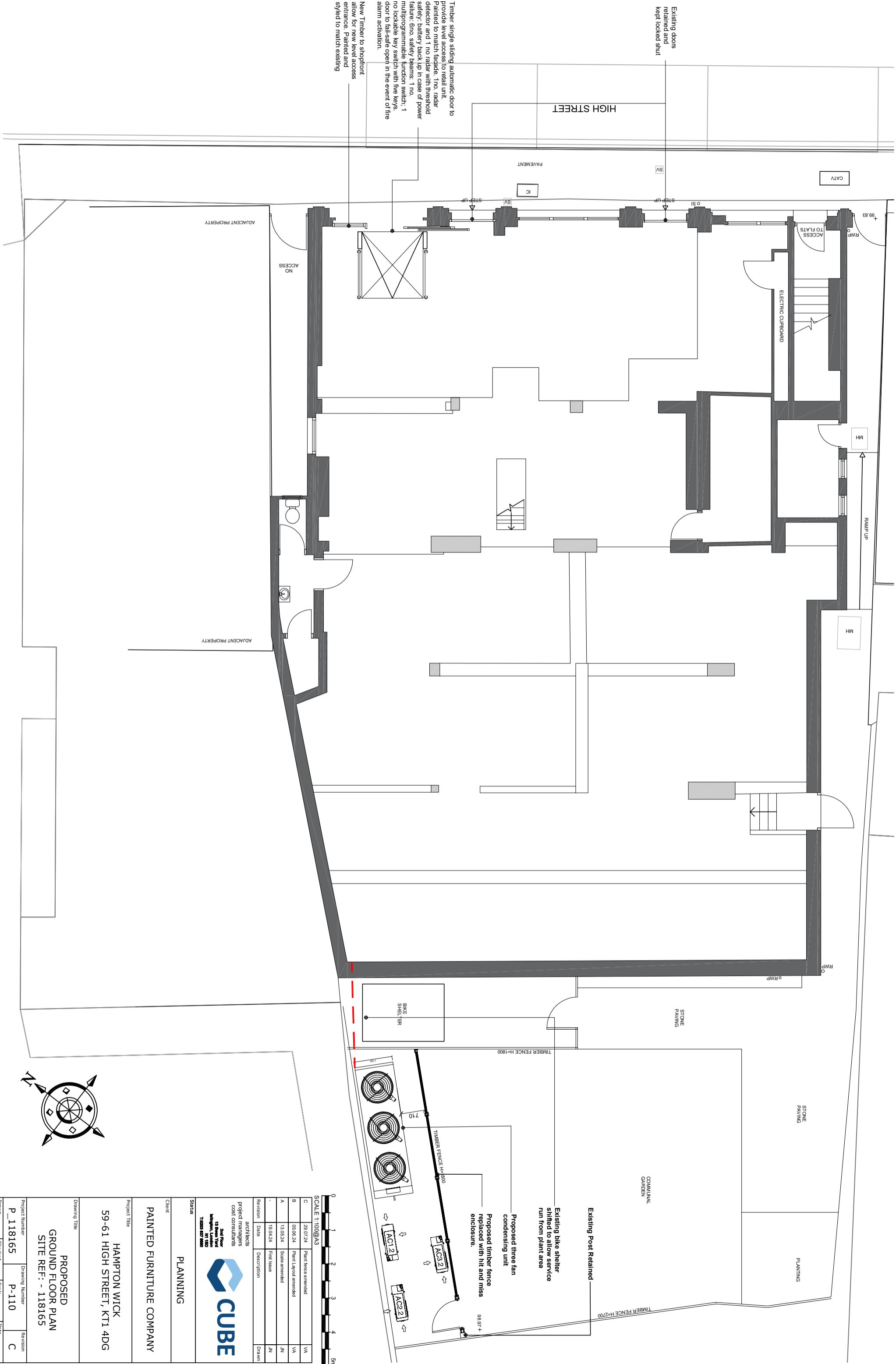

Existing doors retained and kept locked shut

Timber single sliding automatic door to provide level access to retail unit. Painted to match facade. 1 no. radar detector and 1 no radar with threshold safety. battery back up in case of power failure. 6no safety beams. 1 no multiprogrammable function switch. 1 no lockable key switch with five keys. door to fail-safe open in the event of fire alarm activation.

New Timber to shopfront allow for new level access entrance. Painted and styled to match existing

0 1 2 3 4 5m
SCALE 1:100@A3

Revision	Date	Description	Drawn
A	13.05.24	Scale amended	JN
B	05.06.24	Plant layout amended	VA
C	28.07.24	Plant fence amended	VA



And Power
49 St. Andrew's Place
Willesden, London
NW10 2SD
Tel: 020 899 8899

architects
project managers
cost consultants

Client
PLANNING
PAINTED FURNITURE COMPANY

Project Title
HAMPTON WICK
59-61 HIGH STREET, KT1 4DG

Drawing Title
PROPOSED GROUND FLOOR PLAN
SITE REF: - 118165

Project Number	Drawing Number	Revision
P_118165	P-110	C

Drawn	Checked	Scale	Date
JN	VA	AS SHOWN@A3	19.04.2024

The content of this drawing is the property of J.A. Limited and may not be copied in whole or part without formal consent.