

- Notes:
- 1- This drawing is not for construction;
 - 2- All Dimension are in millimeters;
 - 3- This drawing has been drawn to scale for the purposes of obtaining local authority approval. Dimensions are not to be scaled directly from drawings;
 - 4- All dimensions are to be checked on site and the Structural Engineer is to be inform of any discrepancies before construction commences;
 - 5- All structural elements to be agreed with local authority Building Control prior to commencement of works.
 - 6- All references to drawings refer to current revision of that drawing;
 - 7- The Copyright of this drawing belongs to Revive Renovations & Licensing.
 - 8- Attention is drawn to the provisions of the party wall act 1996. Legal boundaries should be determined by others.

FOR PLANNING ONLY

700+
Planning Approvals
In The
Borough Of
Wandsworth

400+
Planning Approvals
In All
Other SW
Boroughs

450+
Planning Approvals
In All Other
London
Boroughs



**Revive
Renovations**

Planning Consultancy
Planning Applications
Drawings & Appeals
revive-renovations.com
0208 914 7877
reception.revive@outlook.com

client
10 The Hermitage, Barnes
London - SW13 9RF

project
HOUSEHOLDER APPLICATION

PART SINGLE / PART TWO STOREY REAR EXTENSION,
REAR ROOF EXTENSIONS AND INSERTION OF FRONT
ROOFLIGHTS, ALTERATIONS TO GARAGE AND
CONVERSION TO HABITABLE ROOM, ALTERATIONS TO
FRONT PORCH AND FAÇADE

drawing title
PROPOSED SECTIONS A-A' & B-B'

date August 2024	scale 1:100@A3	dwn AD
---------------------	-------------------	-----------

drawing number 09	sheet no. 09 of 09	rev -
-----------------------------	-----------------------	----------

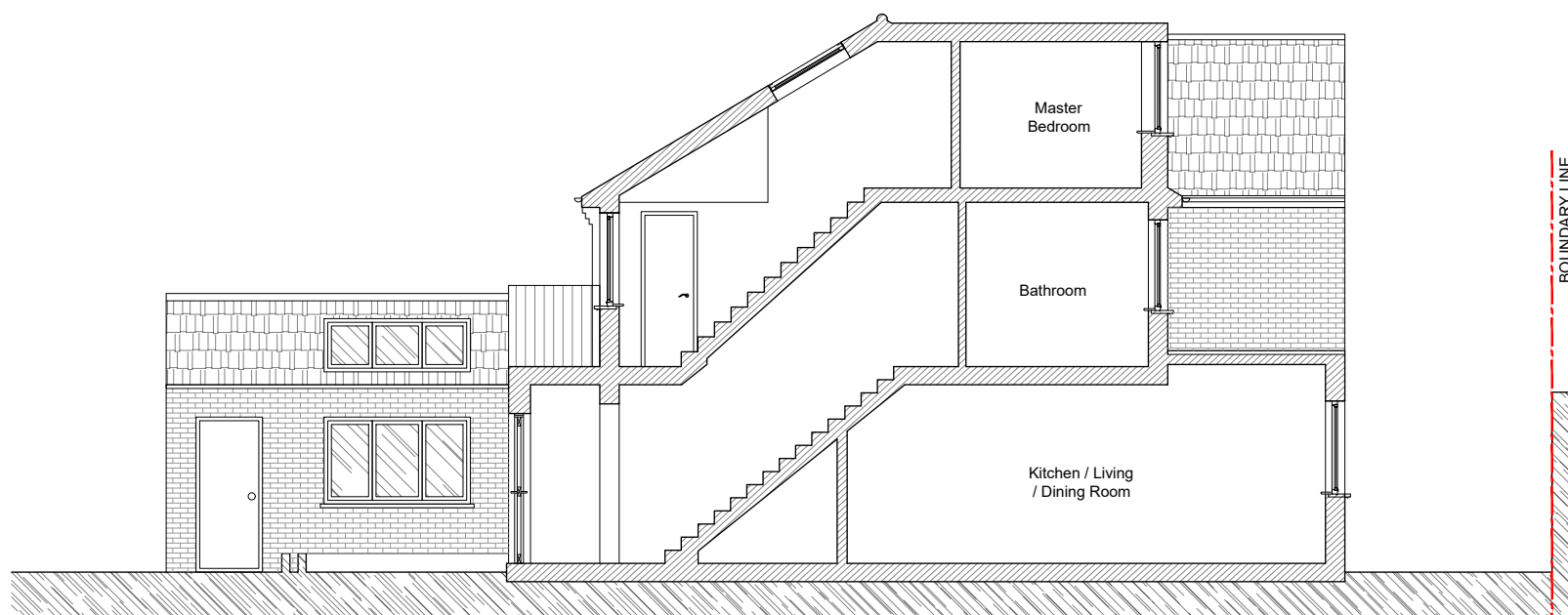

PROPOSED SECTION A-A'



PROPOSED SECTION B-B'