

**KEY:**  
 CHB - EXISTING CHIPBOARD PANELS  
 PBL - EXISTING MODERN PLASTERBOARD LININGS

**TO BE READ IN CONJUNCTION WITH SCHEDULE OR WORKS**

**DISCLAIMER**  
 THE HARD COPY ACCOMPANYING THE ELECTRONIC DATA IS THE LEGAL TRANSMISSION OF INFORMATION. THE ELECTRONIC DATA ARE ISSUED ONLY FOR CONVENIENCE OF USE. NO RESPONSIBILITY FOR THE ACCURACY OR FOR ANY CONSEQUENCE RESULTING FROM THE USE OR ALTERATION OF THIS INFORMATION IS ACCEPTED. THIS DRAWING IS SUBJECT TO CHANGE DURING THE DESIGN DEVELOPMENT PROCESS. THIS DRAWING IS SUBJECT TO SURVEY AND STATUTORY APPROVALS. ALL DIMENSIONS ARE INDICATIVE ONLY AND ARE TO BE CONFIRMED ON SITE.  
**COPYRIGHT IS RESERVED**  
 COPYING OR REPRODUCTION OF THIS DRAWING OR ELECTRONIC DATA WITHOUT THE WRITTEN PERMISSION IS NOT PERMITTED.

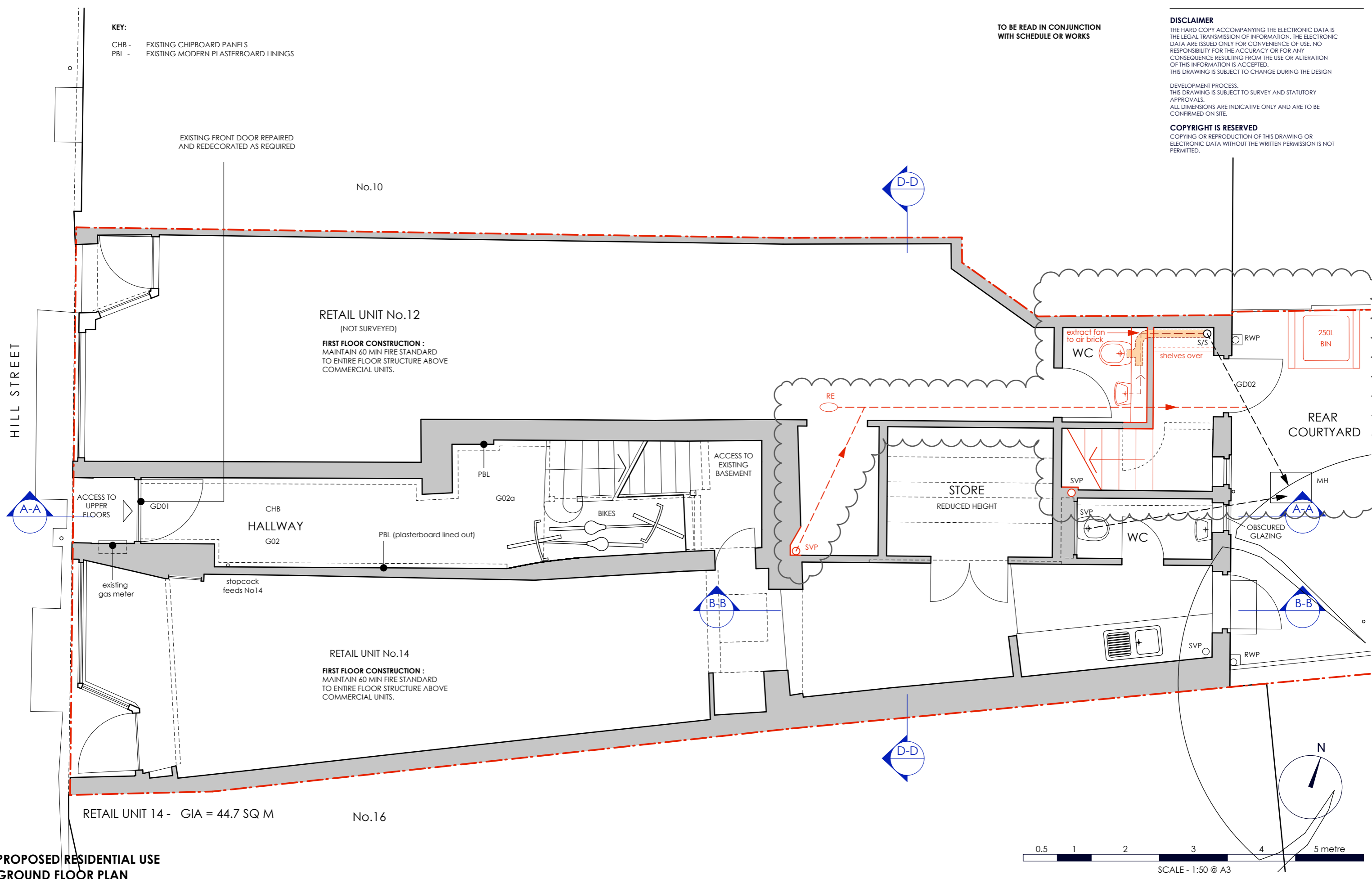

**PROPOSED RESIDENTIAL USE  
 GROUND FLOOR PLAN**

**12 - 14 HILL STREET**  
 TW9

REV	DATE	NOTE
B	03.05.2023	-
C	11.05.2023	-
D	31.05.2024	New stair and alterations to rear facade
E	13.06.2024	Rear facade fenestration retained and used. New SVP position within unit 12.

Drawing Title: GROUND FLOOR PLAN  
 PROPOSED RESIDENTIAL USE  
 Scale: 1:50 @ A3  
 Date: March 2023  
 Drawing Number: AM\_2308\_PL203\_E

**ALASTAIR MACLEOD  
 RIBA**  
 e:info@alastairmacleod.uk  
 mob:07740 793086