

Copyright in the design and this drawing is the property of RESI. Reproduction in whole or in part is forbidden without written sanction of RESI. This drawing must be read in conjunction with all other relevant documentation and drawings.

RESI accepts no liability for any expense, loss or damage of whatsoever nature and however arising from any variation which has not been referred to them and their approval obtained.

Print out to actual scale. Do not scale, except unless for Planning purposes. All dimensions to be cross-checked on-site prior to manufacture and construction. Any discrepancies to be reported to RESI immediately.

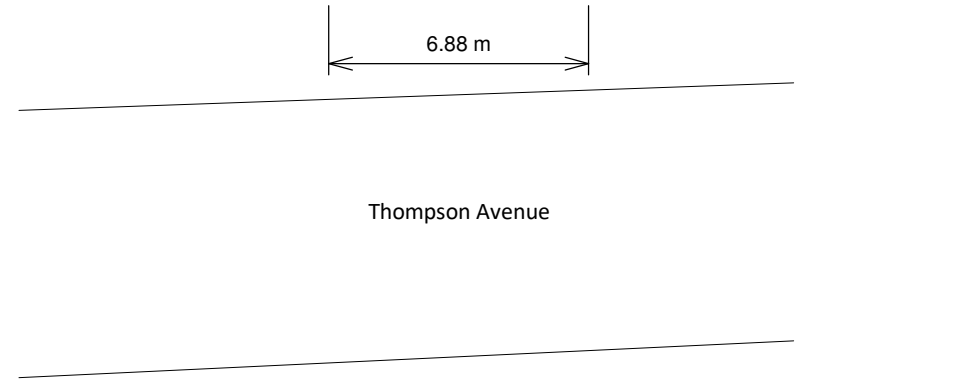
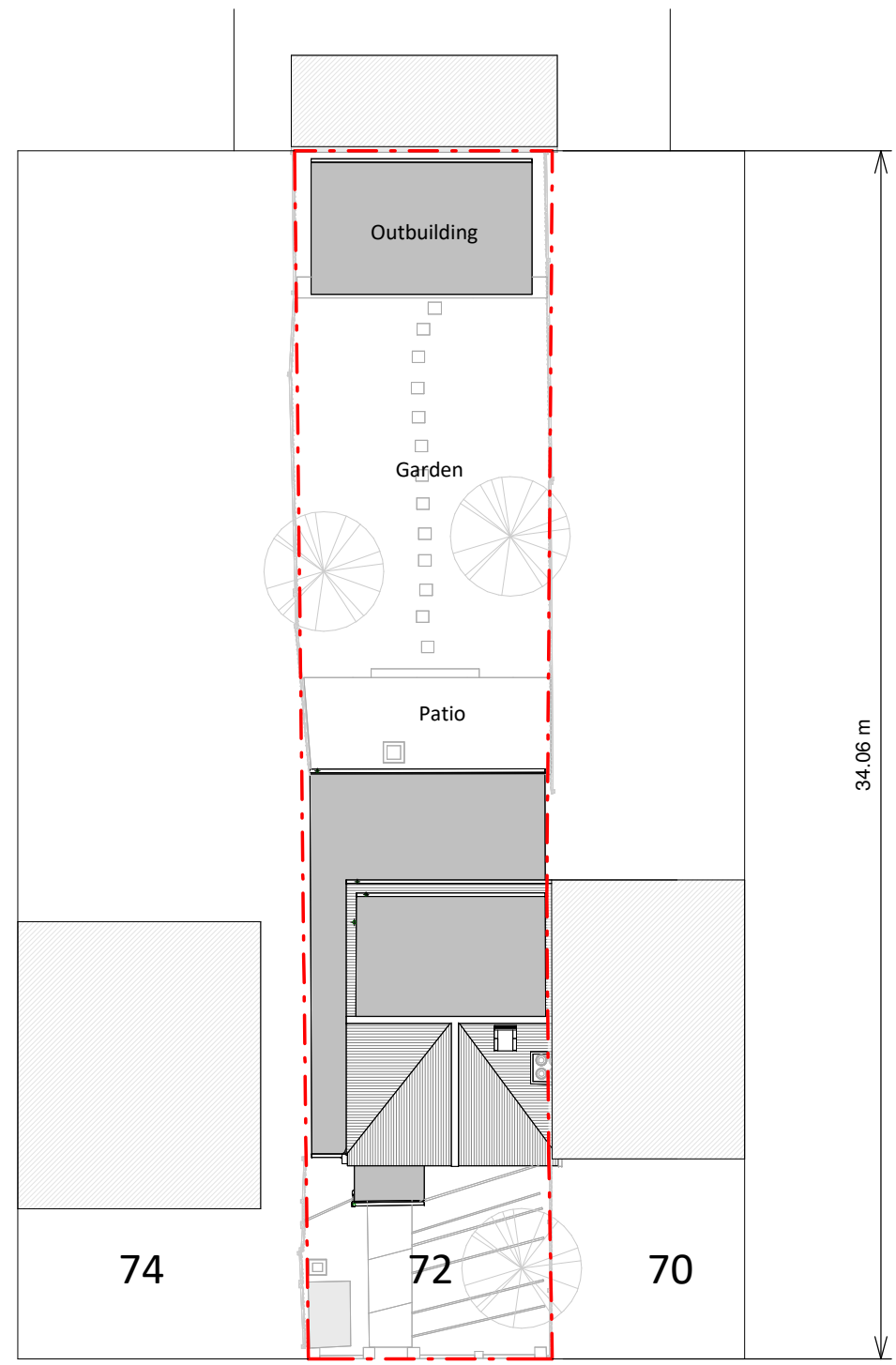

Existing Block Plan

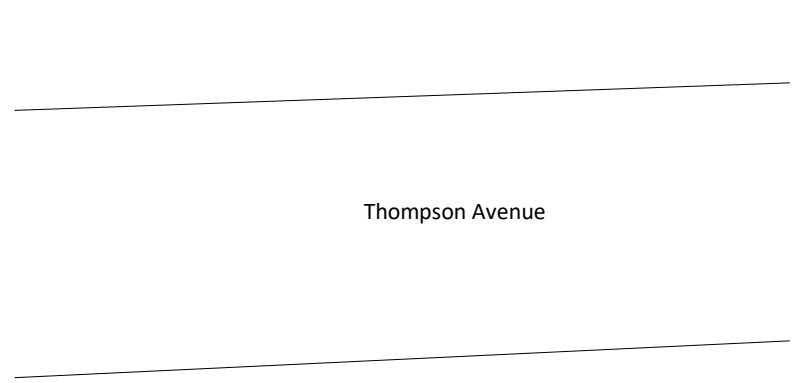
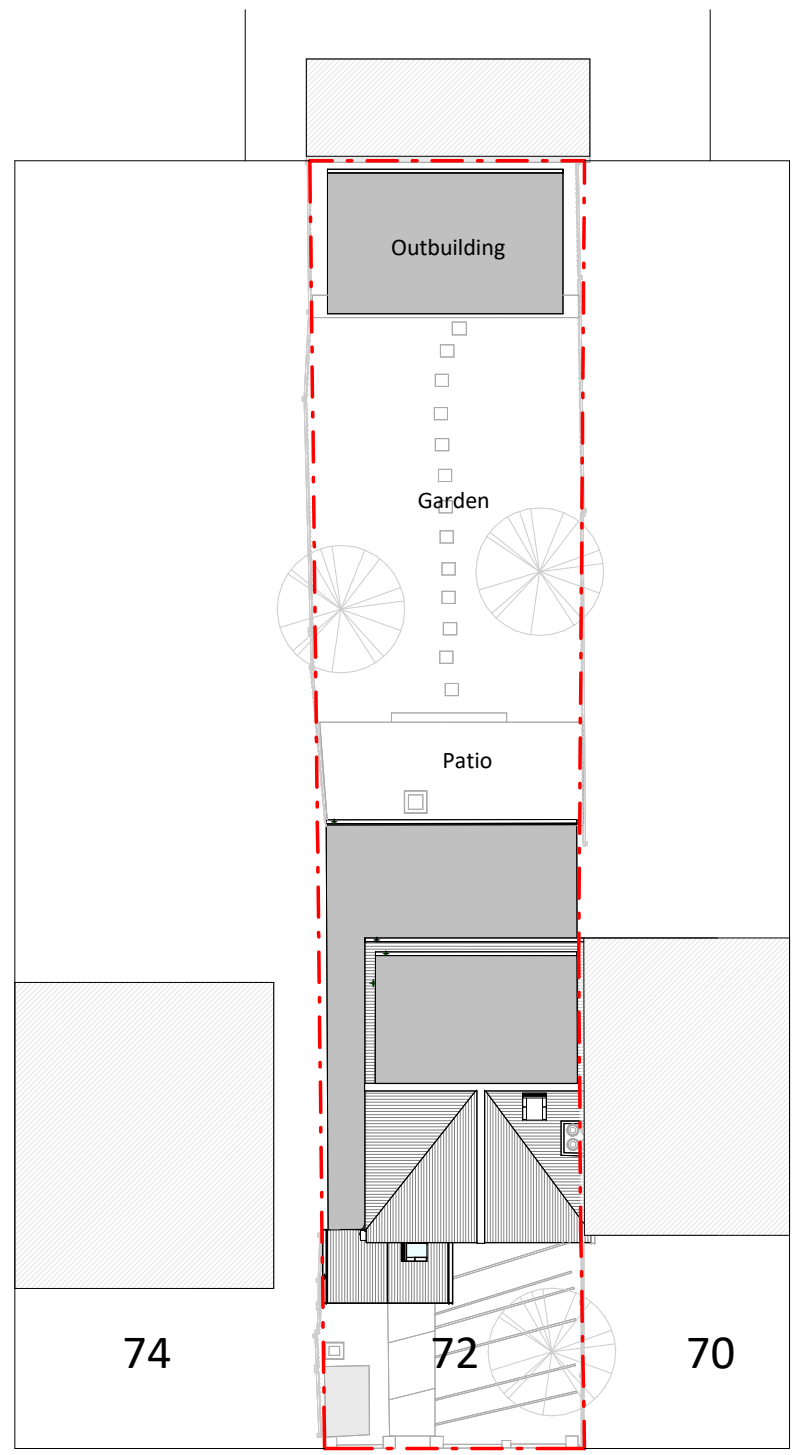

Proposed Block Plan

NOTES

KEY

Neighbouring context Boundary line

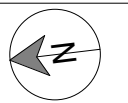

Revision

Rev	Notes	Date
A	Planning	19/08/2024



Job Title
Proposed porch extension, outbuilding internal alterations and all associated works at 72 Thompson Avenue, Richmond, TW9 4JW, GB

Drawing Status
Planning

Client
Stefan Sarkadi

Drawing Title
Block Plans

Scale
1 : 200 @ A3

Drawn
AR

Date
Aug 2024

Checked
BV

Drawing No.
B255811-3000

REV
A

