

**2 Planning - Proposed Hard Landscaping - SCTL**  
1 : 200

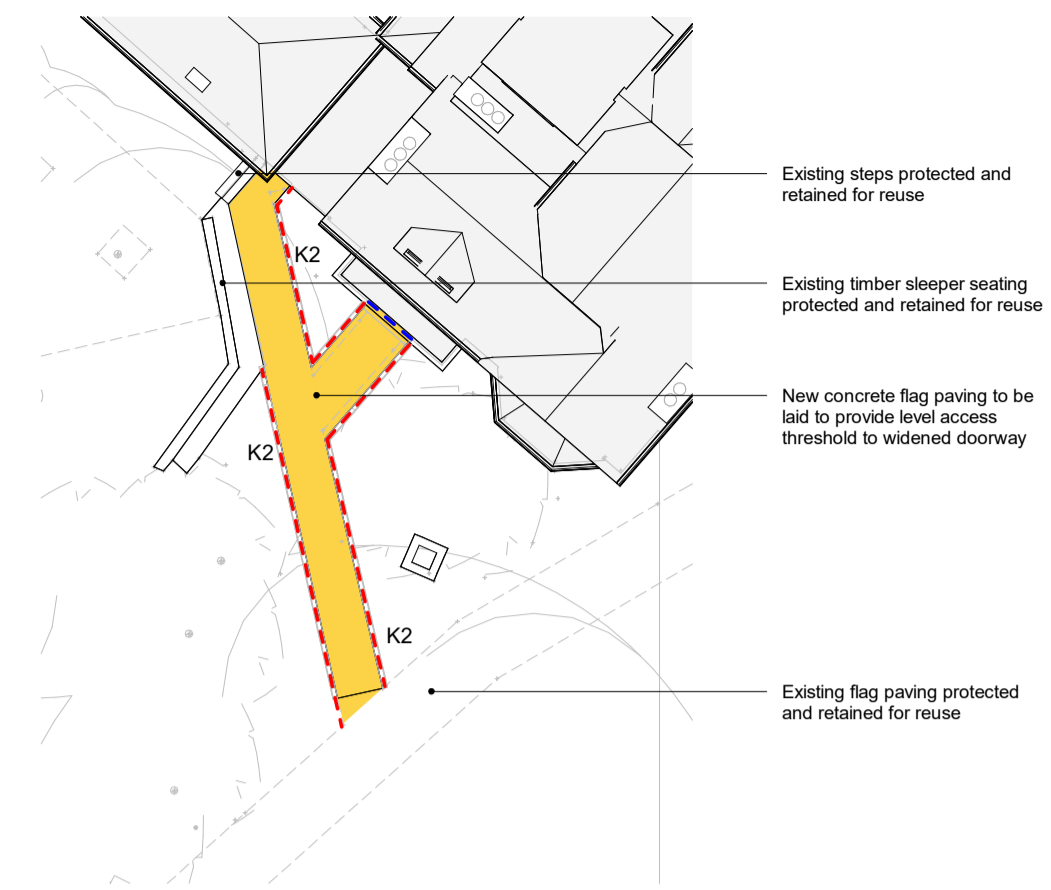

**3 Planning - Proposed Hard Landscaping - Red House**  
1 : 200

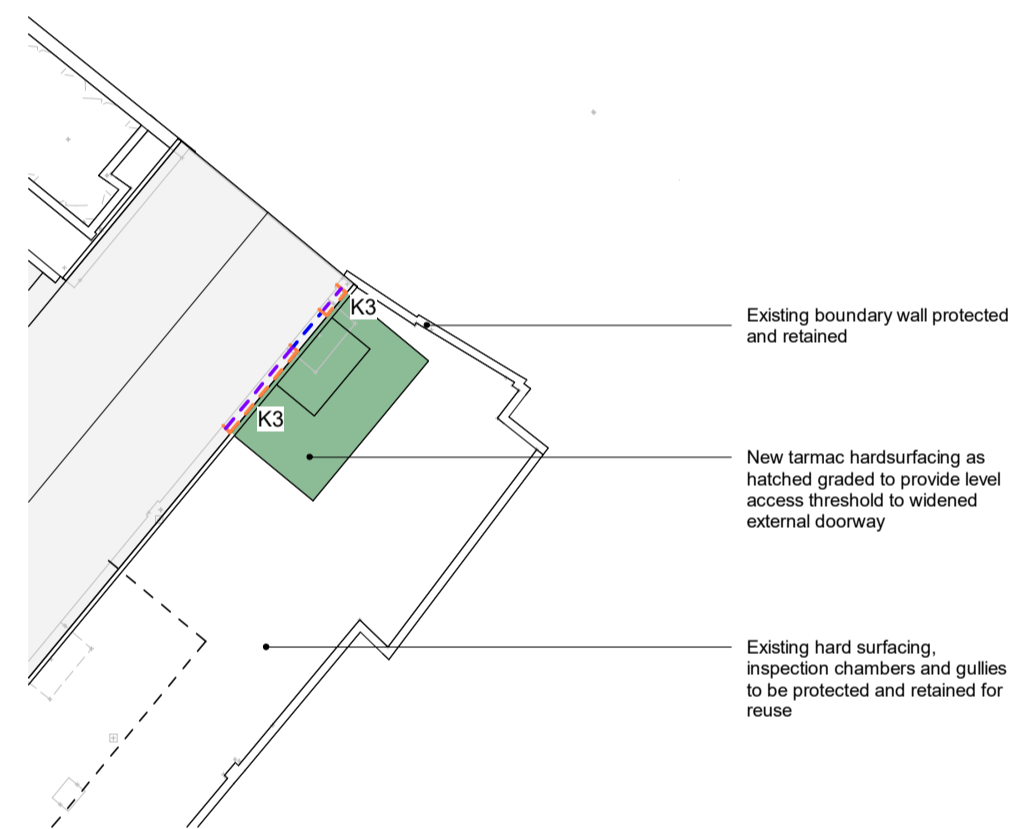

**4 Planning - Proposed Hard Landscaping - Longley**  
1 : 200

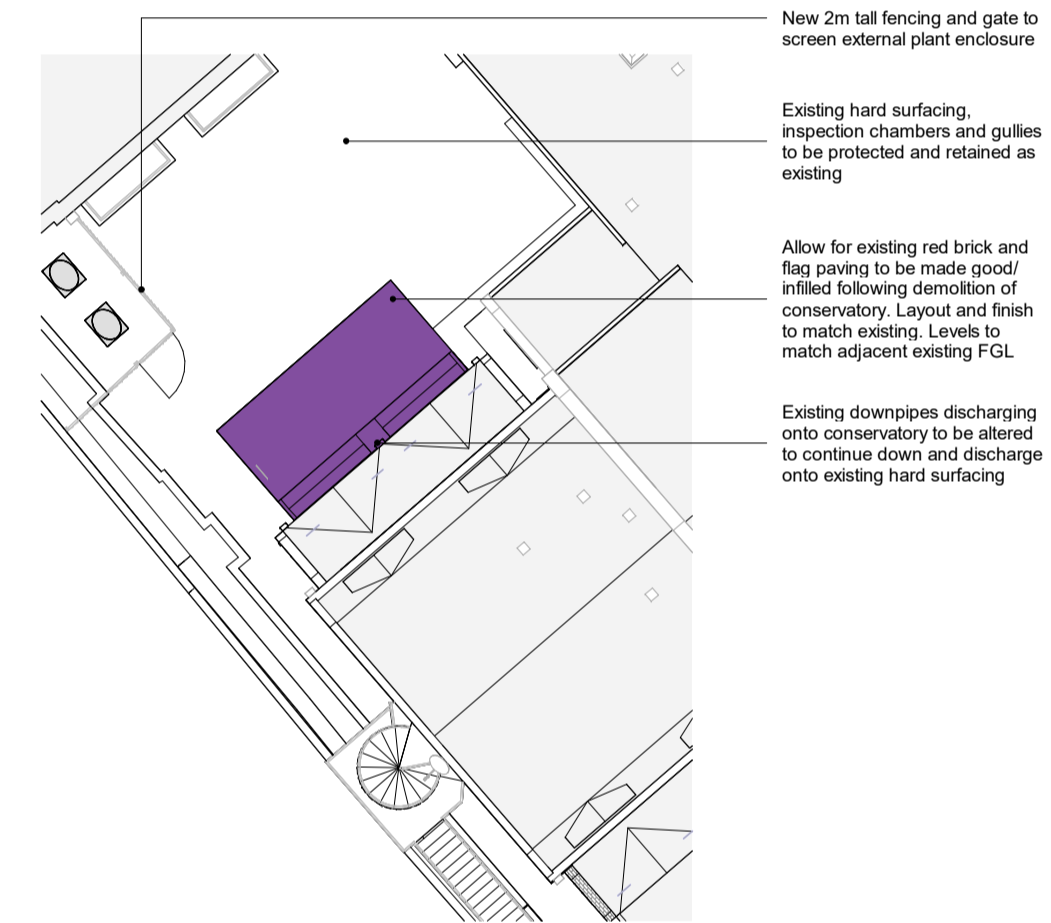

**5 Planning - Proposed Hard Landscaping - Main Building 01**  
1 : 200

Landscaping Legend	
	<b>Concrete Flags</b> 600x600mm stack bonded
	<b>Tarmac</b> Surface finish to match existing adjacent
	<b>Brick/ Flag Paving Courtyard</b> Existing red brick and flag paving to be made good/infilled following demolition of conservatory
	<b>Yorkstone Paving Slabs</b> 600x300mm in stretcher bond
	<b>Thermoplastic Line Markings</b> White or yellow road markings
	<b>Planting Bed Soil System</b> 450mm topsoil with geotextile membrane and mulch cover
	<b>Existing Kerb Dropped (K1)</b> Replacement units to match existing finish and size
	<b>Kerb Type (K2)</b> Half battered concrete kerb system
	<b>Kerb Type (K3)</b> Thin concrete flat top edging
	<b>Gravel Drainage Border</b> Grey graded 10mm single size, over Terram Woodguard membrane
	<b>Linear drainage</b>

- Notes:**
- All substrate build ups below new and amended hardsurfacing as C.Eng's detail specification.
  - Proposed new replacement planting TBA with client.
  - Soil condition to be confirmed by C.Eng.
  - UNO, allow for new and amended hard surfacing to discharge towards existing gully outlets to prevent ponding.

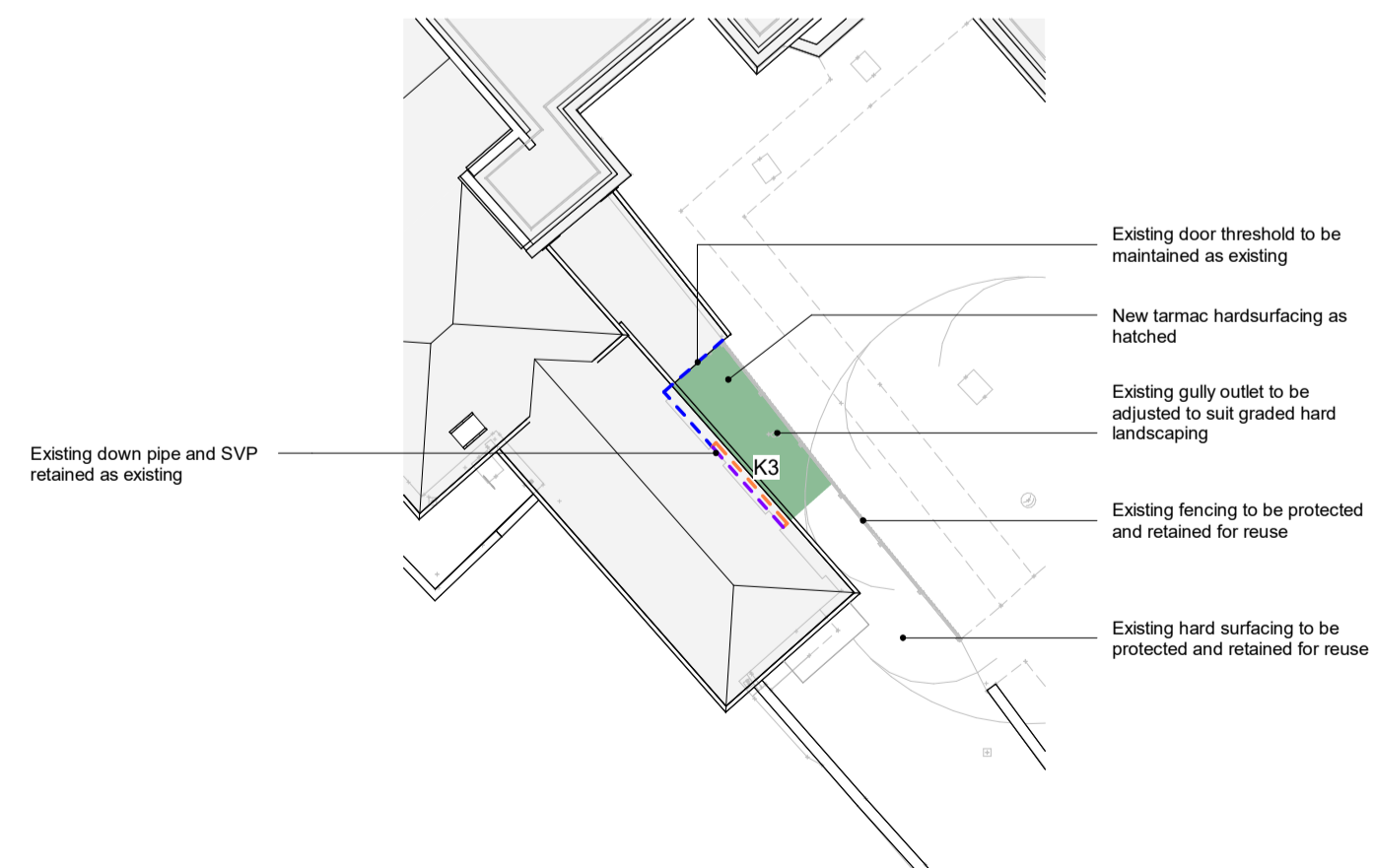

**6 Planning - Proposed Hard Landscaping - Main Building 02**  
1 : 200

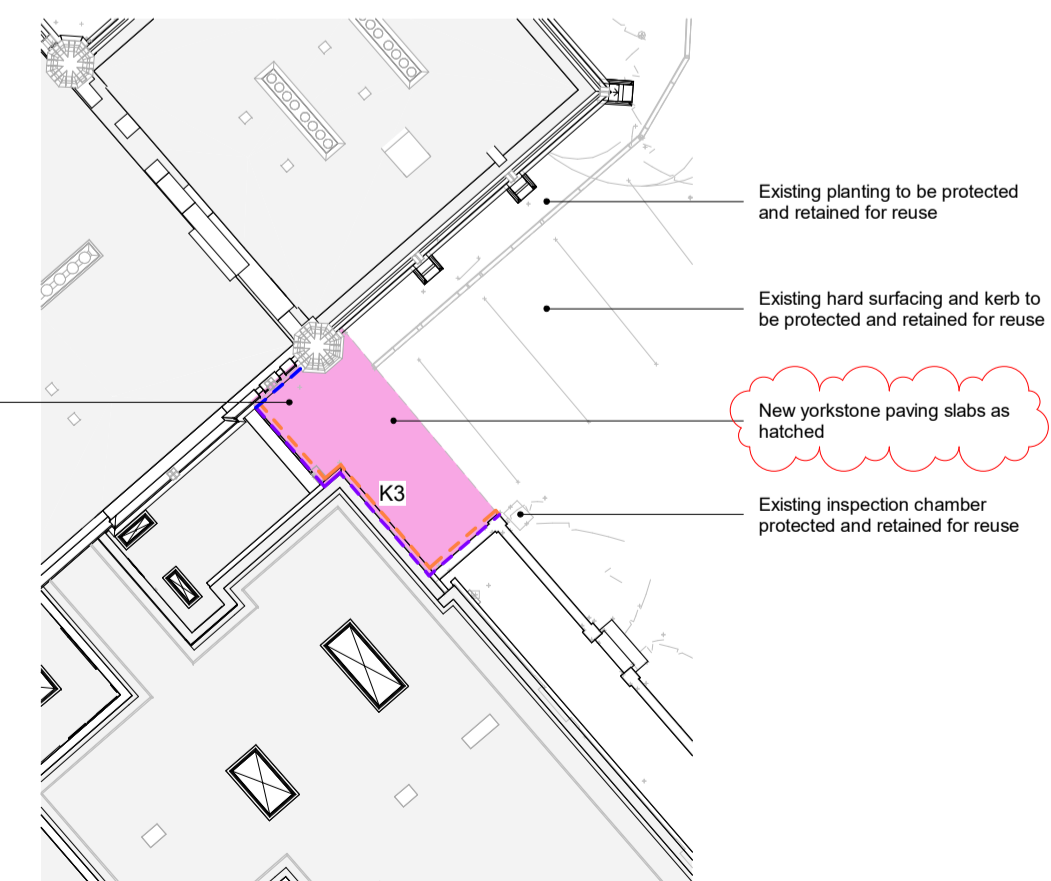

**7 Planning - Proposed Hard Landscaping - Main Building 03**  
1 : 200

REV	DESCRIPTION	DATE
P04	Revised for Planning	21.06.24
P03	Revised for Planning	01.07.24
P02	Revised for Planning	21.06.24
P01	WIP Issue	14.06.24

**IID** 10 Archway  
Richmond Place  
15 Pinnerham Road  
Richmond  
TW10 6TP

info@iid.co.uk  
020 3774 1000  
www.iid.co.uk

<b>CLIENT</b> Thomas's London Day Schools
<b>PROJECT</b> Thomas's College
<b>DRAWING TITLE</b> Proposed Landscaping Plan
<b>SCALE:</b> As indicated @ A1

DRAWING NUMBER	REV
1714 IID PL XX DR A-1005 P04	