



Chartered Architects
Building & Party Wall Surveyors
CDM H&S Services
Sustainability & PassivHaus Consultants

FIRE SAFETY STRATEGY

**112 High Street,
Hampton TW12 2ST**

12.08.August 2024

Rev:-

Produced by: GBP

Authoring Competency

The Fire Safety Strategy was prepared by the agent of the current Planning Application, Geoff Beardsley & Partners.

Geoff Beardsley & Partners has over 40 years' experience designing residential projects in London and surrounding areas

Criteria 1 – Space provisions for fire appliances and assembly points

Fire appliances (fire extinguisher and fire blanket) will be located in the Ground Floor of the property. A designated cupboard will be used to store the appliances. See the diagram on the following page for the location.

An assembly point will be located outside of the property via the main egress route through the front entrance. It is recommended that the assembly point be located outside of the control of the property to allow a safe distance from the property in the event of a fire.

Criteria 2 – Passive and active safety measures

The property will be fit with smoke, heat and carbon monoxide detectors. The locations will be checked by an approved building control inspector to comply with the current building regulations.

The property will be fit with appropriately rated fire doors in all corridors and rooms as recommended by an approved building control inspector to comply with the current building regulations.

All ceilings and walls with steel structure will be closed with fire rated plasterboard rated to one hour minimum as per building regulations or alternatively coated with 1hour FR intumescent paint.

Criteria 3 – Information and data on construction products and materials

This information is not yet known. All works and materials will be inspected by an approved building control inspector.

Criteria 4 – Information on means of escape and evacuation strategy



The main means of escape from Ground Floor property will be from the rear through the protected hallway and out of the main entrance to the assembly point.

The path of egress is outlined on the diagram on the last page of the report.

Criteria 6 – Information on access and equipment for firefighting

The main access for firefighting is via the front door of the property which is to remain as per the original design of the property. The proposed works do not alter the access to the property from the street. It will be possible for fire appliances to be used near and within the building.

LEGEND:

-  Egress Route
-  Fire Appliances
-  Assembly Point

Note: The assembly point will be outside of the control of the property for safety

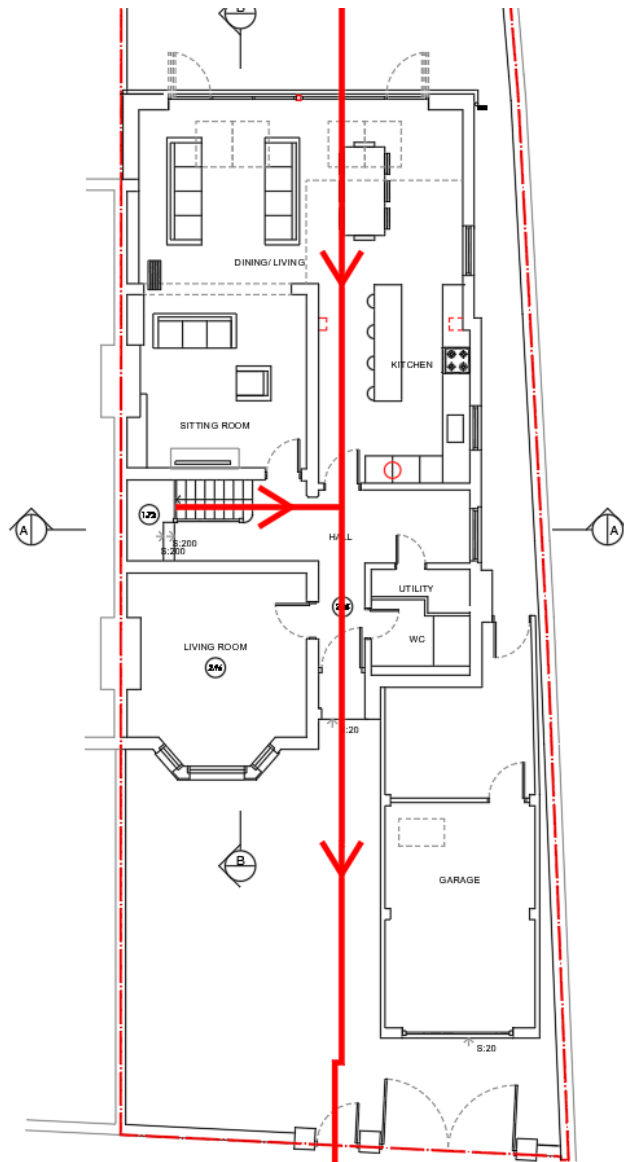

PROPOSED GROUND FLOOR PLAN