

A Bin Store - Elevation A-A'
Scale 1:25@A1

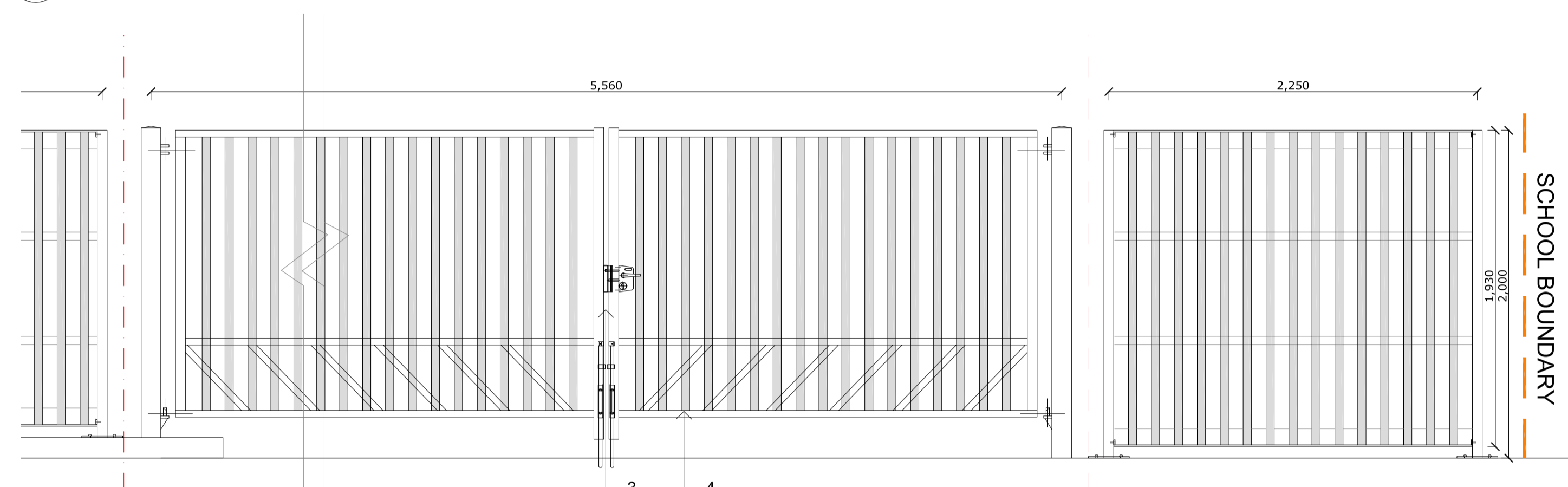

B Bin Store - Elevation A-A'
Scale 1:25@A1

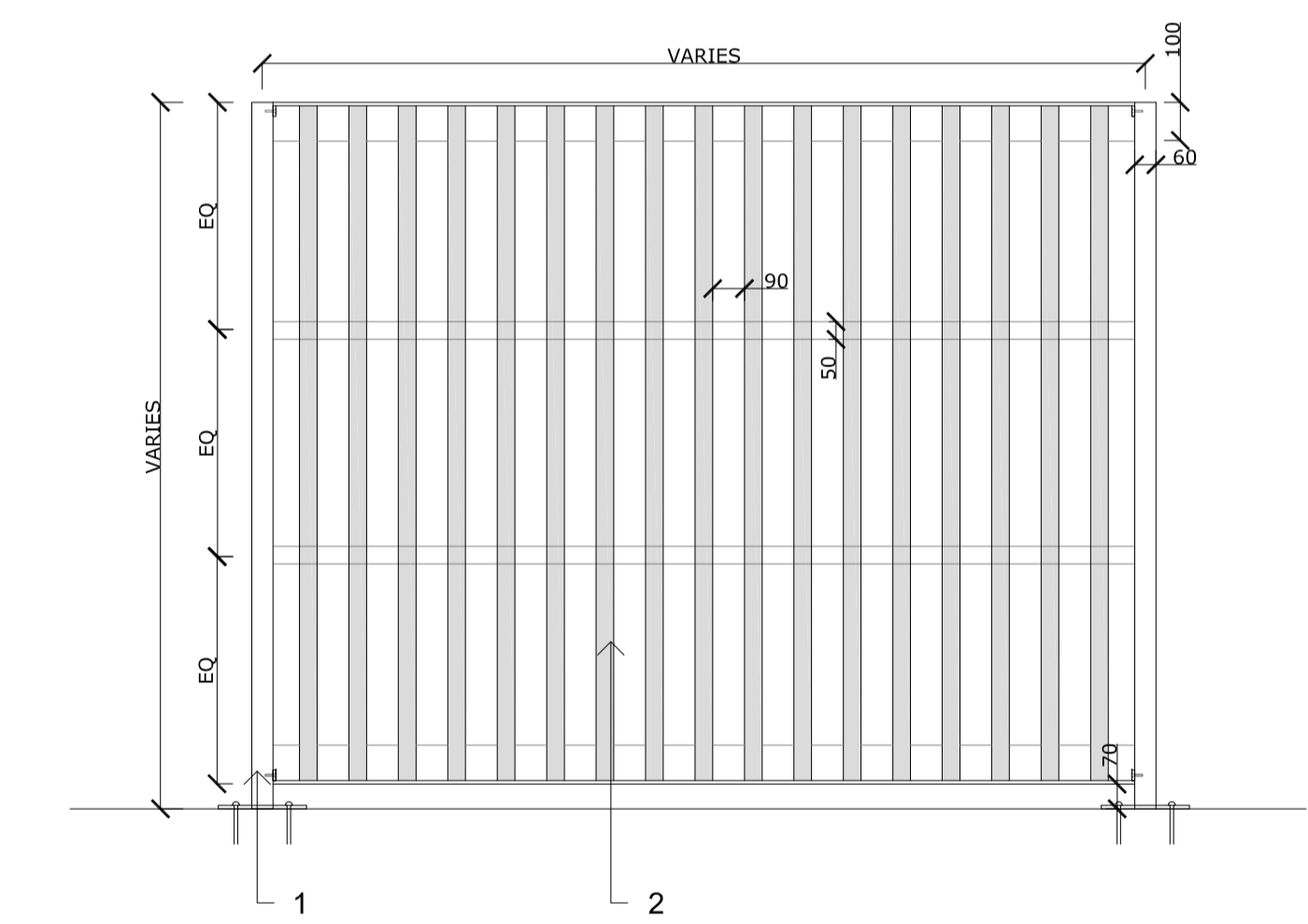

C Timber & Steel Fence - Typical Elevation
Scale 1:20@A1

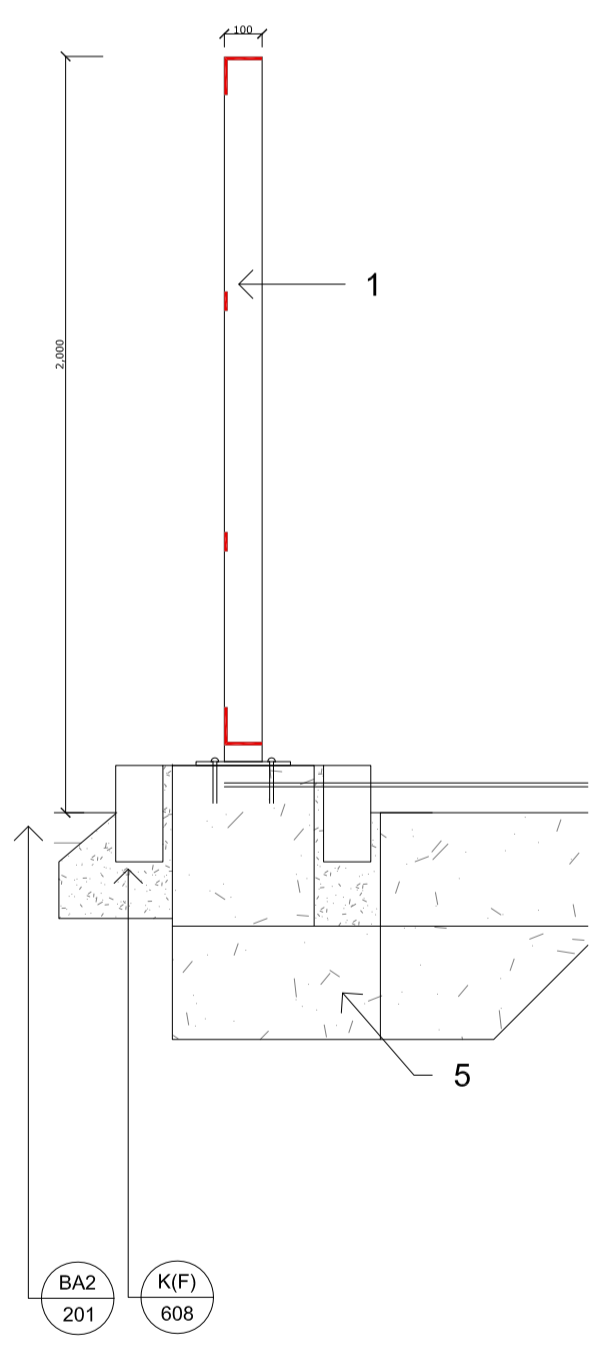

D Timber Fence - Cross Section B-B'
Scale 1:20@A1

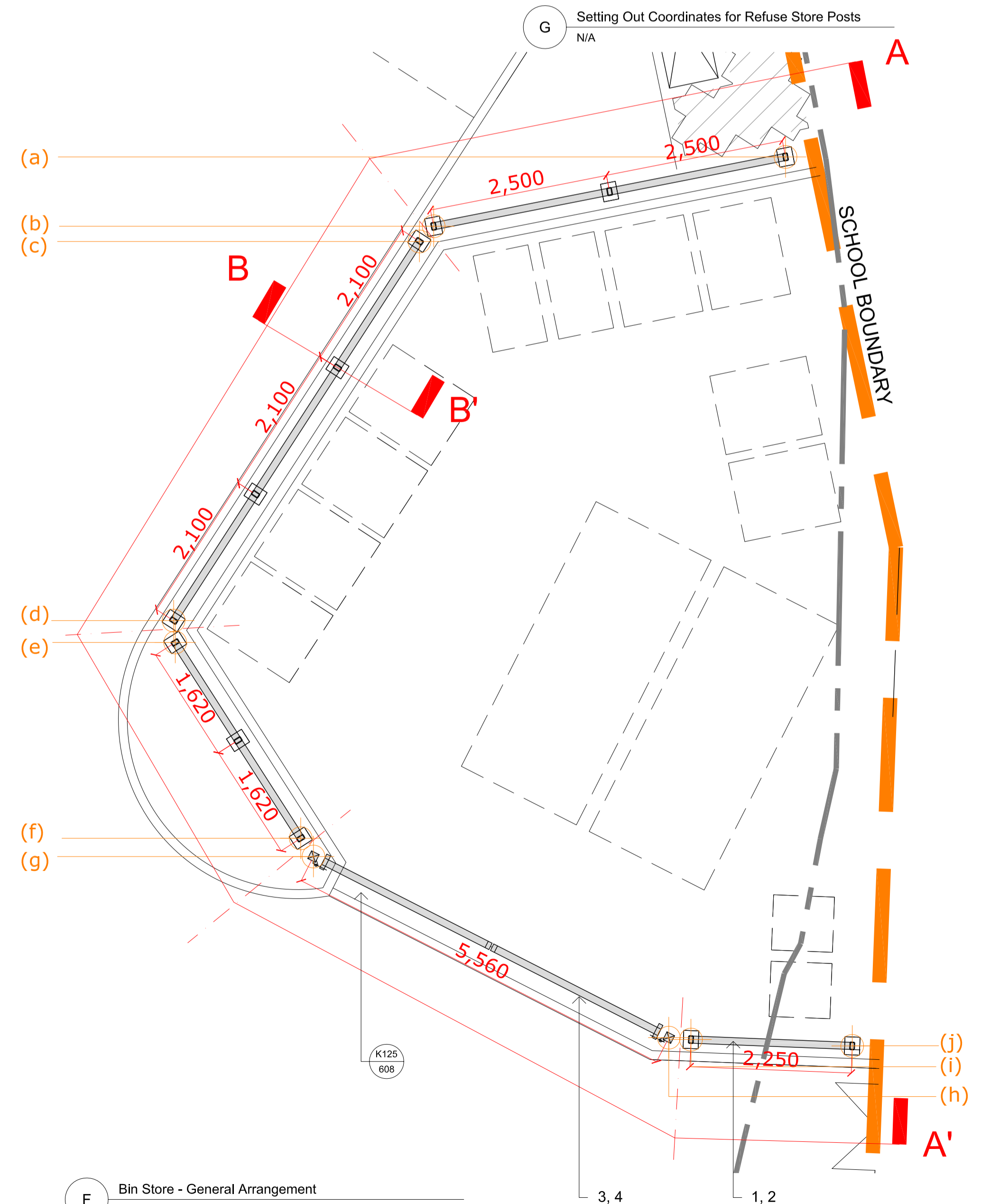

F Bin Store - General Arrangement
Scale 1:50@A1

Rev C04
Removed reference to Hardwood.
Added notching note for timber pales

- Notes**
- Do not scale from this drawing, use only written dimensions.
 - All dimensions are drawn in mm unless otherwise noted.
 - All dimensions must be checked on site and any discrepancies verified with landscape architect.
 - Landscape drawing only - to be read in conjunction with architect and engineers drawings.
 - All materials/items used to be as specified or alternatives to be approved by landscape architect.
- CDP item, final designs to engineers specification.
- 60 x 100 x 8mm steel RHS post, welded onto base plate with 4nr pre-drilled holes, to be resin anchored to concrete slab, to engineer details. Columns set @ 2.5m centres. Bin store enclosure no higher than 2m from ground level, 100 x 100 x 8mm steel angle bracket and 50 x 8mm flat bar horizontals @750mm centres, fixed to steel posts.
 - 50 x 100mm timber pales @140mm centres, back fixed to angle brackets and horizontals. Timber to be notched to remain flush on front face of fence.
 - 2m high lockable bespoke steel gate frame by Jackson's Security or similar approved. 120 x 120 x 3mm RHS posts (as standard) at 5560mm centres, with double hinges to open 180°. Height of gate to match fence. Posts set in concrete footings to manufacturers specification. Falls 40 x 100mm RHS, Stiles 60 x 100mm RHS. Double leaf gate swings outwards and to be lockable from the outside. Double drop down bolt and sockets for approval.
 - Timber pales to match fence panel specification, 1850mm height. Submit proposals for method of fixing to steel frame.
 - Concrete foundations. To engineers detail 5165798-ATK-MB-00-DR-S-0152 BIN STORE FOUNDATION

Iss	Date	Issue Notes	ML	JB	EP
C	26.01.18	Stage 4 V/E			

LUC 43 Chalton Street
London, NW1 1JD
T: 020 7383 5764
F: 020 7383 4798
london@landuse.co.uk
www.landuse.co.uk

Project
Richmond Upon Thames College
Phase 1

Client
Atkins

Title
Boundary Treatments
Timber & Steel Railing

Scale
Varies@A1

Status
for Planning

Job No. 6377	Drawing No. LD-DET-604	Issue D
------------------------	----------------------------------	-------------------

Do not scale from this drawing
© Drawing & Design Copyright of LUC