

**NOTES**

ALL DRAWINGS TO BE PRINTED AT 100% SCALE. DO NOT FIT TO PRINTER MARGINS WHEN PRINTING. DO NOT SCALE DIMENSIONS FROM THE DRAWING. USE FIGURED DIMENSIONS ONLY.

1. This drawing is copyright of HollandGreen Ltd. Reproduction is only to take place with written authority.
2. These plans are subject to Planning & Building Regulation approval or any other statute in law before building work commences.
3. Any structural work where mentioned on this drawing is subject to a qualified structural and civil engineer calculations before building work commences.
4. All boundaries are assumed. To be confirmed on site before building work commences.
5. Any discrepancies are to be brought to the attention of HollandGreen Ltd for rectification. If in doubt, ASK.
6. Only drawings marked as CONSTRUCTION status can be used to build or manufacture from.
7. All windows and doors shown on schedules and drawings are indicative only and no manufacturing should be carried out until a site survey has been conducted by manufacturer.
8. The survey information shown on this drawing is based on a survey prepared by a third party. HollandGreen accept no responsibility for the accuracy or completeness of the survey.

**Key**

-  Existing tree
-  Proposed tree
-  Proposed orchard tree
-  Hardscape
-  Gravel
-  Decking
-  Enhanced grassland
-  Planting/Vegetation
-  Lawn
-  Hedge
-  Pond
-  Bark Chipping Path
-  Basement area
-  Rooftop terrace area
-  Site boundary



**Existing Habitat**  
Scale: 1:500

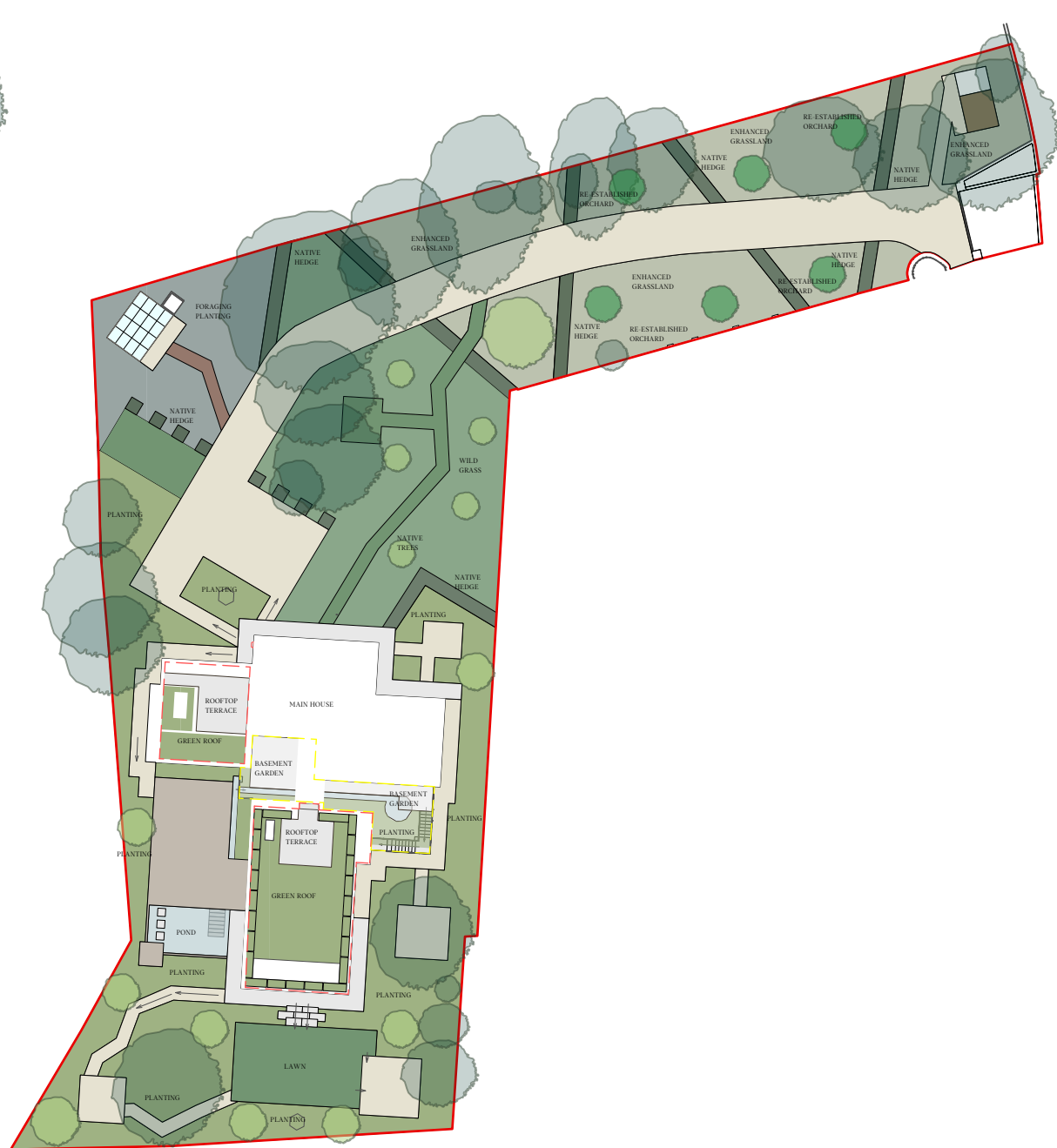

**Proposed Habitat**  
Scale: 1:500

Stage: **PLANNING**  
Drawing: **Habitat Enhancement Plan**

Revision	Date	Details
PL01	03/09/2024	Original drawing issue

Project: **Ross - Sevenoaks**

Project Number: **1602**  
Project Address: **Sevenoaks, 101a High Street Hampton Middlesex TW12 2SX**

Project Leader: **Josh Handrick**

Scale: **1:500**  
Date: **03 September 2024**

Drawing Number: **712-102**  
Revision: **PL01**

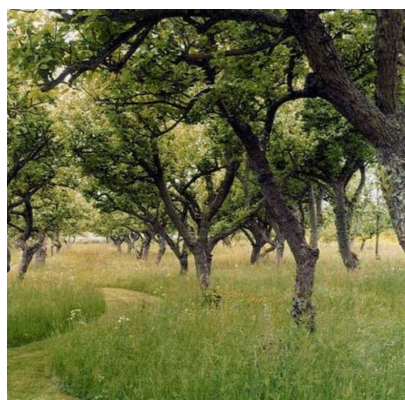

Native Trees & Wild Grass



Orchard with Enhanced Grassland

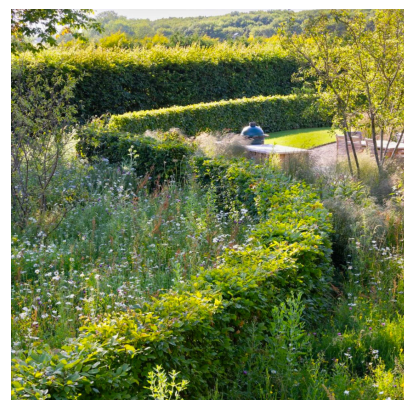

Native Hedging

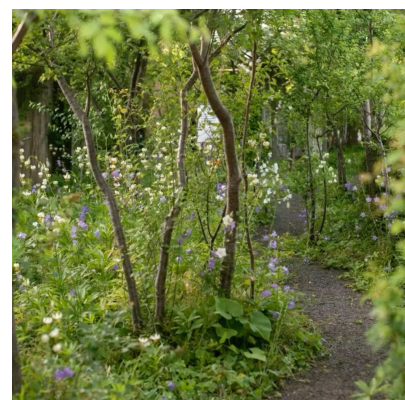

Native & Pollinator Friendly Planting

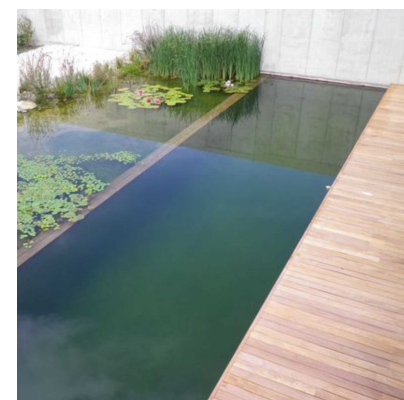

Ornamental Wildlife Pond



The Old Grammar School  
Church Road  
Thame  
Oxon  
OX9 3AJ

hello@hollandgreen.co.uk  
hollandgreen.co.uk  
T: 01844 390 381

**HOLLAND GREEN**