

- NOTES:
- DO NOT SCALE FROM THIS DRAWING
 - ALL DIMENSIONS TO BE CHECKED ON SITE PRIOR TO FABRICATION
 - THIS DRAWING SHOULD BE READ IN CONJUNCTION WITH STRUCTURAL ENGINEER'S DRAWINGS
 - THIS DRAWING SHOULD BE READ IN CONJUNCTION WITH SERVICE ENGINEER'S DRAWINGS
 - COPYRIGHT OF THIS DRAWING REMAINS WITH JOHN RICH ARCHITECTS
 - ANY DISCREPANCY FOUND BETWEEN THIS DRAWING AND ANY OTHER DOCUMENTS MUST BE REPORTED IMMEDIATELY BY THE CONTRACTOR
 - ALL PROPRIETARY MATERIALS TO BE INSTALLED IN ACCORDANCE WITH MANUFACTURERS INSTRUCTIONS
 - ALL TIMBERS TO BE PRESSURE IMPREGNATED

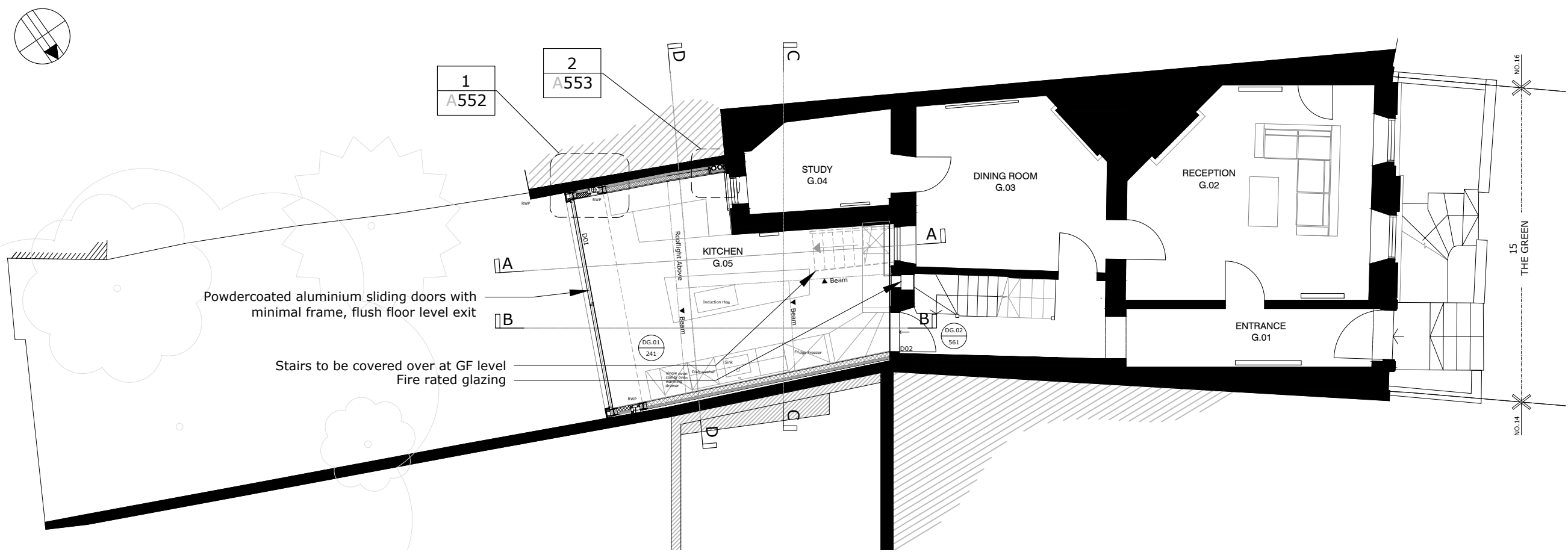

EXISTING AND PROPOSED GROUND FLOOR PLAN

REVISIONS

NO.	DESCRIPTION

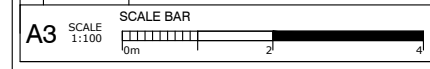

CLIENT
MR R. LEIGH

PROJECT
15 THE GREEN, RICHMOND, TW9 1PX

PROJECT DESCRIPTION
NEW GREEN ROOF TO CONSERVATORY

DRAWING NAME:
EXISTING AND PROPOSED GROUND FLOOR PLAN

John Rich Architect
6a Royal Parade | Kew
Richmond | Surrey | TW9 3QD
t: 020 8940 0416 | f: 020 8940 3303
e: mail@johnricharchitects.com
w: www.johnricharchitects.com

DATE: JULY 15
DRAWN: AY
CHECKED: JR
JOB NO:
RG
DWG NO: REV:
RG 02 -