

500mm ADDITIONAL REAR EXTENSION

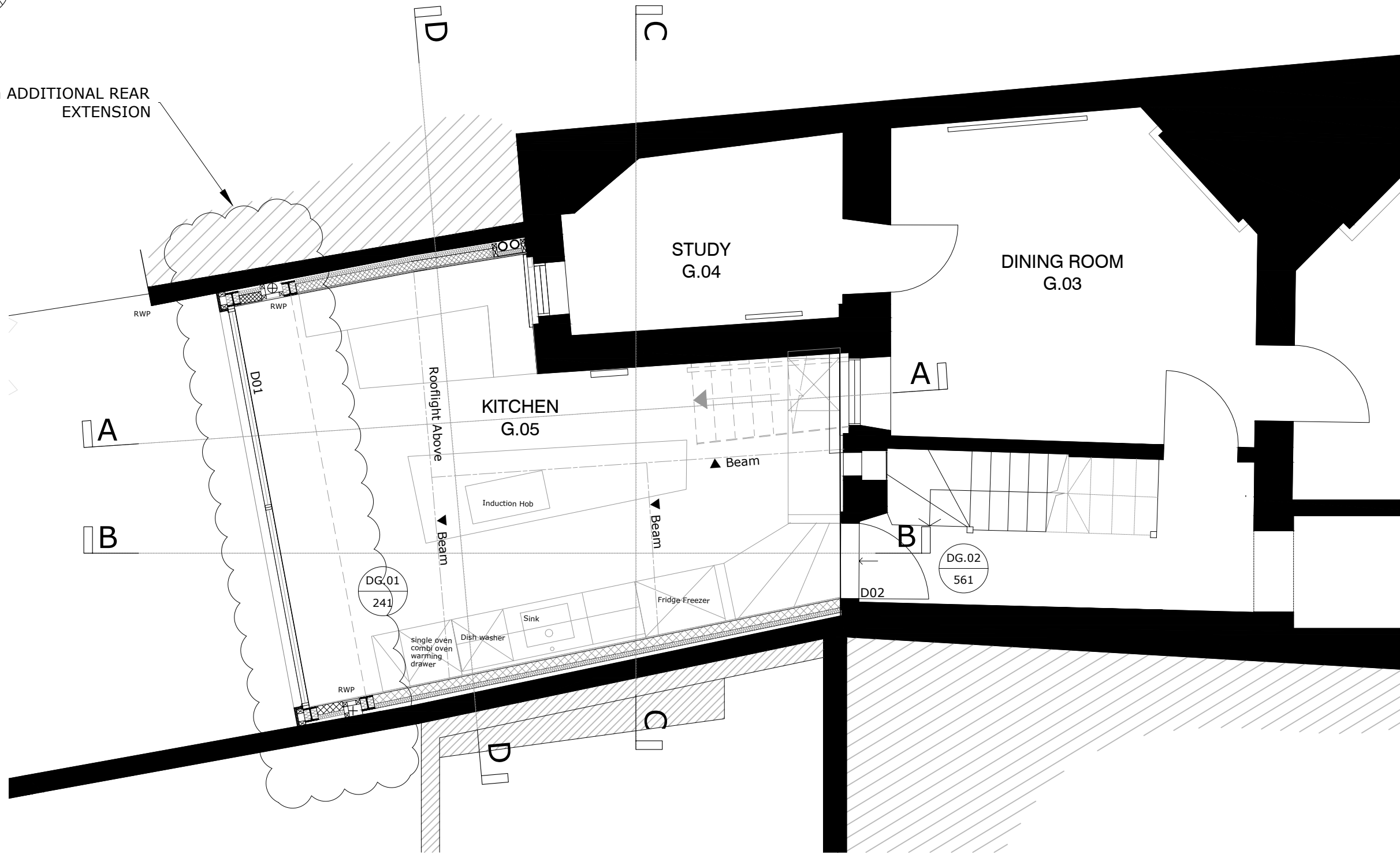

# EXISTING GROUND FLOOR PLAN (PART)

STATUS  
**TOWN PLANNING**

- NOTES:
- DO NOT SCALE FROM THIS DRAWING
  - ALL DIMENSIONS TO BE CHECKED ON SITE PRIOR TO FABRICATION
  - THIS DRAWING SHOULD BE READ IN CONJUNCTION WITH STRUCTURAL ENGINEER'S DRAWINGS
  - THIS DRAWING SHOULD BE READ IN CONJUNCTION WITH SERVICE ENGINEER'S DRAWINGS
  - COPYRIGHT OF THIS DRAWING REMAINS WITH JOHN RICH ARCHITECTS
  - ANY DISCREPANCY FOUND BETWEEN THIS DRAWING AND ANY OTHER DOCUMENTS MUST BE REPORTED IMMEDIATELY BY THE CONTRACTOR
  - ALL PROPRIETARY MATERIALS TO BE INSTALLED IN ACCORDANCE WITH MANUFACTURERS INSTRUCTIONS
  - ALL TIMBERS TO BE PRESSURE IMPREGNATED

NOTE:  
**DAMP PROOFING WORKS BY SPECIALIST CONTRACTOR DIRECTLY APPOINTED BY EMPLOYER.**  
 ENABLING WORKS FOR DAMP PROOFING, TO BE BY MAIN CONTRACTOR INCLUDING:  
 (SEE NOTES FOR DETAILS)

### REVISIONS

NO.	DESCRIPTION

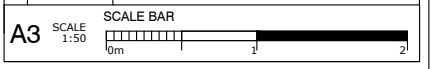

CLIENT  
**MR R. LEIGH**

PROJECT  
**15 THE GREEN, RICHMOND, TW9 1PX**

PROJECT DESCRIPTION  
**NEW GREEN ROOF TO CONSERVATORY**

DRAWING NAME:  
**EXISTING GROUND FLOOR PLAN (PART)**

**John Rich Architect**  
 6a Royal Parade | Kew  
 Richmond | Surrey | TW9 3QD  
 t: 020 8940 0416 | f: 020 8940 3303  
 e: mail@johnricharchitects.com  
 w: www.johnricharchitects.com

DATE: JULY 15  
 DRAWN: AY  
 CHECKED: JR  
 JOB NO:  
**RG**  
 DWG NO: REV:  
**RG 03 -**