

EXISTING GROUND FLOOR DRAINAGE PLAN

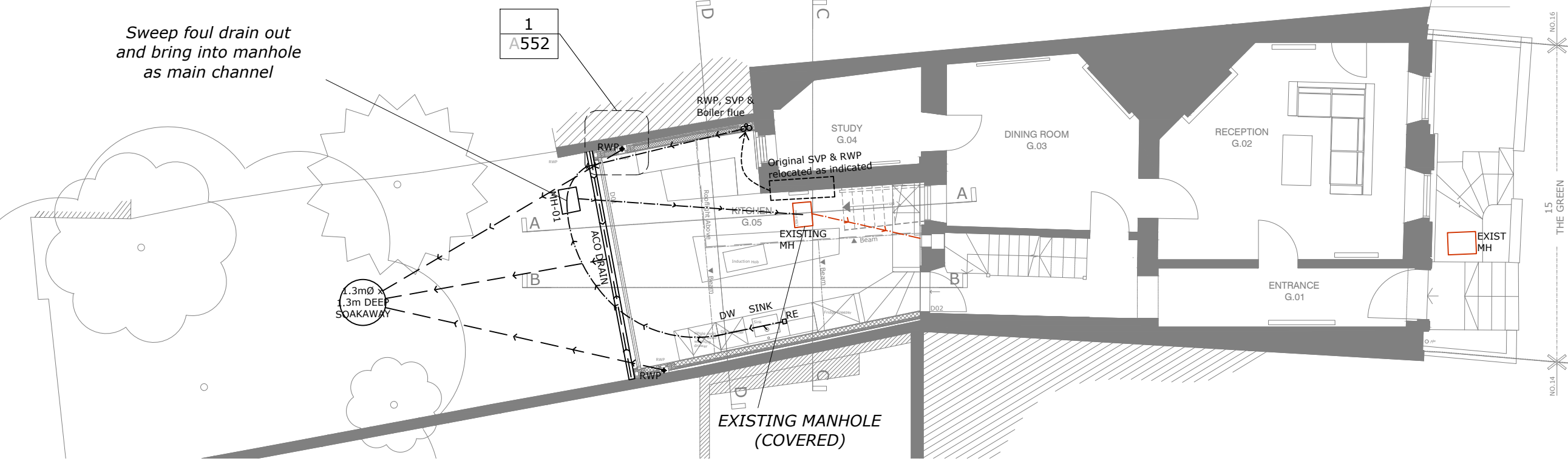

EXISTING BASEMENT DRAINAGE PLAN

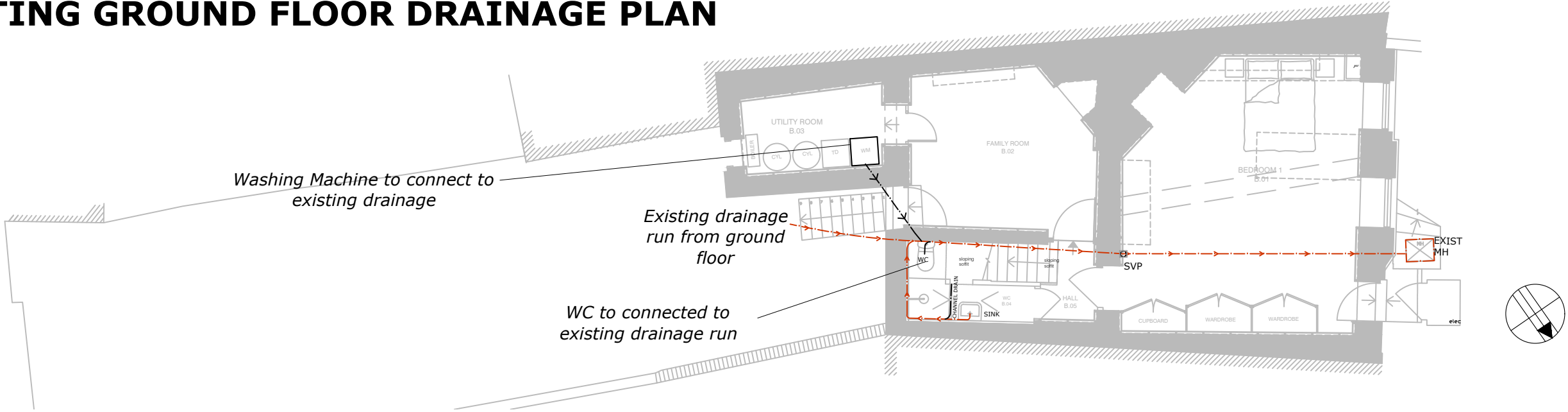

STATUS

TOWN PLANNING

NOTES:

1. DO NOT SCALE FROM THIS DRAWING

2. ALL DIMENSIONS TO BE CHECKED ON SITE PRIOR TO FABRICATION

3. THIS DRAWING SHOULD BE READ IN CONJUNCTION WITH STRUCTURAL ENGINEER'S DRAWINGS

4. THIS DRAWING SHOULD BE READ IN CONJUNCTION WITH SERVICE ENGINEER'S DRAWINGS

5. COPYRIGHT OF THIS DRAWING REMAINS WITH JOHN RICH ARCHITECTS

6. ANY DISCREPANCY FOUND BETWEEN THIS DRAWING AND ANY OTHER DOCUMENTS MUST BE REPORTED IMMEDIATELY BY THE CONTRACTOR

7. ALL PROPRIETARY MATERIALS TO BE INSTALLED IN ACCORDANCE WITH MANUFACTURERS INSTRUCTIONS

8. ALL TIMBERS TO BE PRESSURE IMPREGNATED

NOTE:

DAMP PROOFING WORKS BY SPECIALIST SUBCONTRACTOR DIRECTLY APPOINTED BY EMPLOYER

EXISTING DRAINAGE RUN

PROPOSED DRAINAGE RUN

REVISIONS

SCALE BAR

A3 SCALE 1:100 0m 1 2 4

CLIENT

MR R. LEIGH

PROJECT

15 THE GREEN, RICHMOND, TW9 1PX

PROJECT DESCRIPTION

NEW GREEN ROOF TO CONSERVATORY

DRAWING NAME:

EXISTING GROUND FLOOR AND BASEMENT DRAINAGE PLAN

John Rich Architect

6a Royal Parade | Kew
Richmond | Surrey | TW9 3QD
t: 020 8940 0416 | f: 020 8940 3303
e: mail@johnricharchitects.com
w: www.johnricharchitects.com

DATE: JULY 15
DRAWN: AY
CHECKED: JR

JOB NO:
RG

DWG NO: REV:

RG 09 -