

- NOTES:
- DO NOT SCALE FROM THIS DRAWING
 - ALL DIMENSIONS TO BE CHECKED ON SITE PRIOR TO FABRICATION
 - THIS DRAWING SHOULD BE READ IN CONJUNCTION WITH STRUCTURAL ENGINEER'S DRAWINGS
 - THIS DRAWING SHOULD BE READ IN CONJUNCTION WITH SERVICE ENGINEER'S DRAWINGS
 - COPYRIGHT OF THIS DRAWING REMAINS WITH JOHN RICH ARCHITECTS
 - ANY DISCREPANCY FOUND BETWEEN THIS DRAWING AND ANY OTHER DOCUMENTS MUST BE REPORTED IMMEDIATELY BY THE CONTRACTOR
 - ALL PROPRIETARY MATERIALS TO BE INSTALLED IN ACCORDANCE WITH MANUFACTURERS INSTRUCTIONS
 - ALL TIMBERS TO BE PRESSURE IMPREGNATED

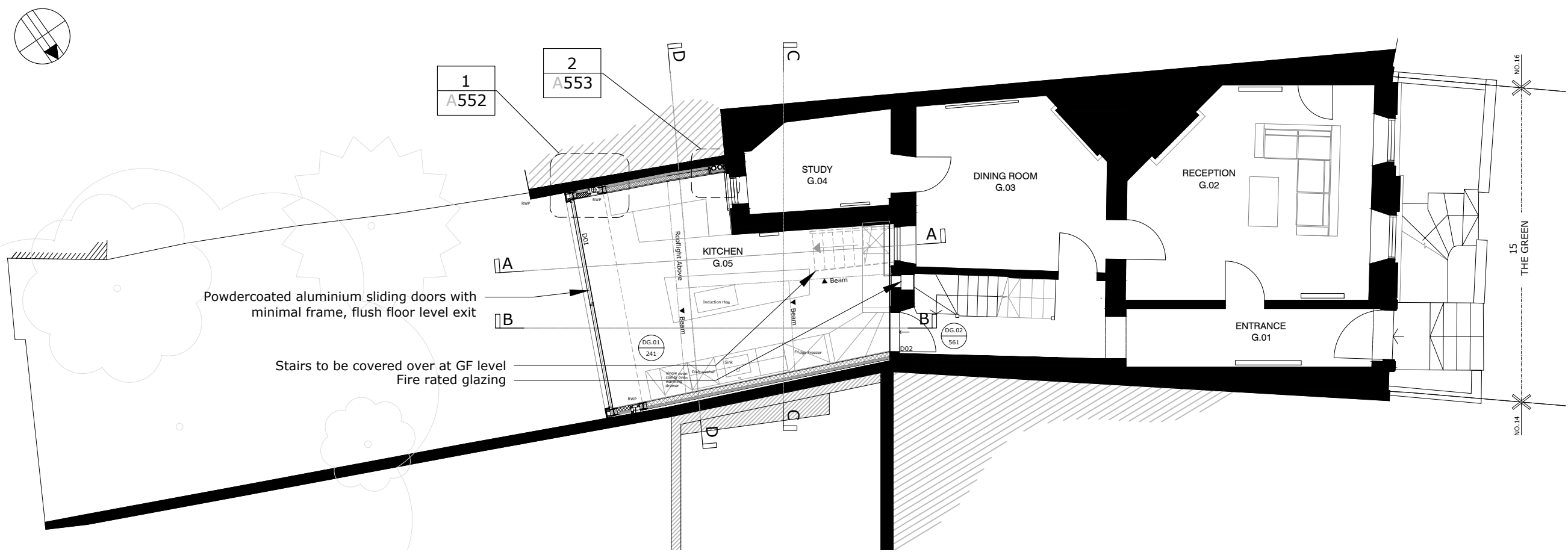

EXISTING AND PROPOSED GROUND FLOOR PLAN

REVISIONS

| NO. | DESCRIPTION |
|-----|-------------|
| | |
| | |

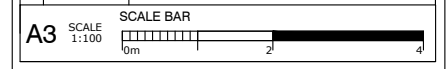

CLIENT
MR R. LEIGH

PROJECT
15 THE GREEN, RICHMOND, TW9 1PX

PROJECT DESCRIPTION
NEW GREEN ROOF TO CONSERVATORY

DRAWING NAME:
EXISTING AND PROPOSED GROUND FLOOR PLAN

John Rich Architect
6a Royal Parade | Kew
Richmond | Surrey | TW9 3QD
t: 020 8940 0416 | f: 020 8940 3303
e: mail@johnricharchitects.com
w: www.johnricharchitects.com

DATE: JULY 15
DRAWN: AY
CHECKED: JR
JOB NO:
RG
DWG NO: REV:
RG 02 -