

500mm ADDITIONAL REAR EXTENSION

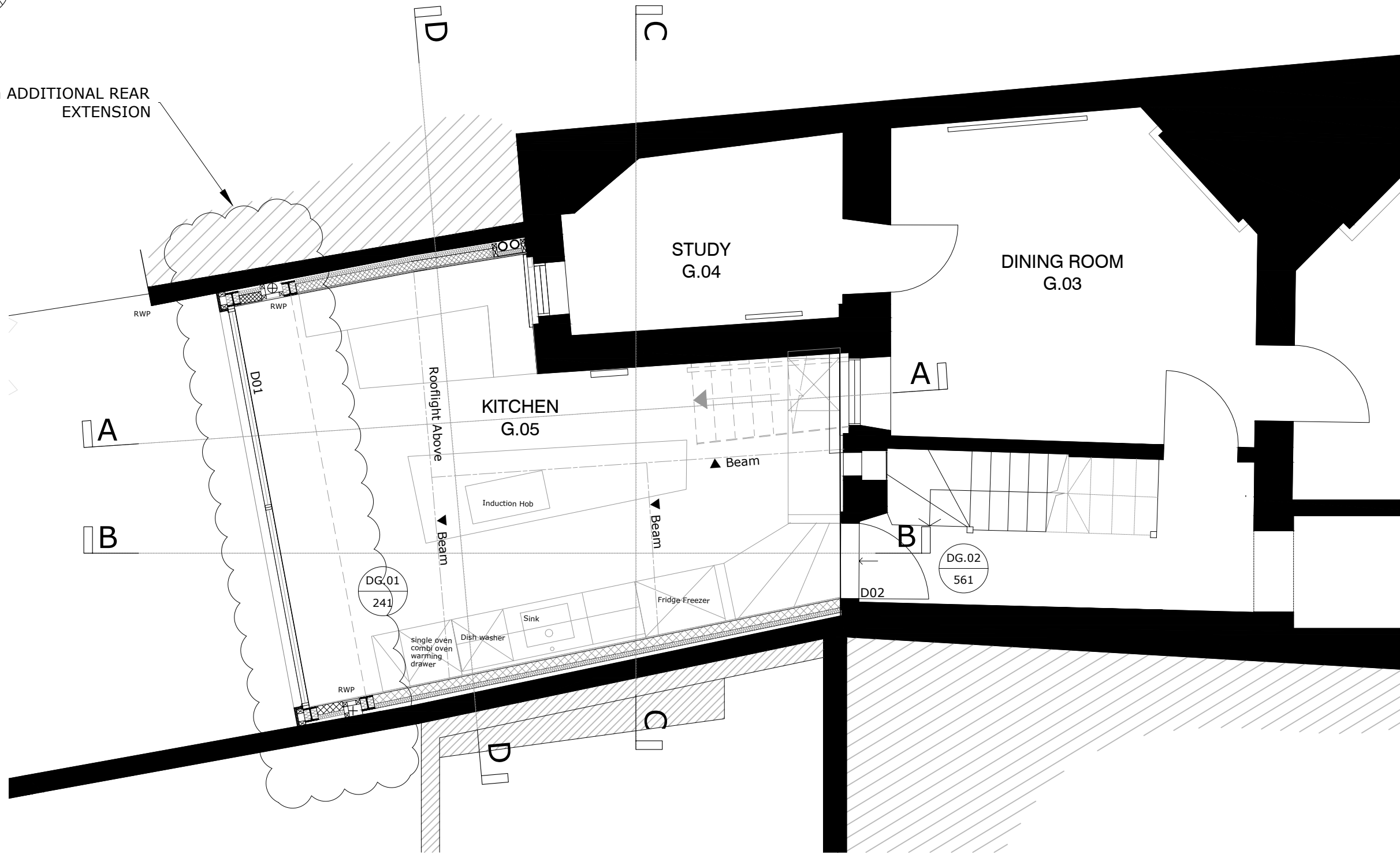

EXISTING GROUND FLOOR PLAN (PART)

STATUS
TOWN PLANNING

- NOTES:
- DO NOT SCALE FROM THIS DRAWING
 - ALL DIMENSIONS TO BE CHECKED ON SITE PRIOR TO FABRICATION
 - THIS DRAWING SHOULD BE READ IN CONJUNCTION WITH STRUCTURAL ENGINEER'S DRAWINGS
 - THIS DRAWING SHOULD BE READ IN CONJUNCTION WITH SERVICE ENGINEER'S DRAWINGS
 - COPYRIGHT OF THIS DRAWING REMAINS WITH JOHN RICH ARCHITECTS
 - ANY DISCREPANCY FOUND BETWEEN THIS DRAWING AND ANY OTHER DOCUMENTS MUST BE REPORTED IMMEDIATELY BY THE CONTRACTOR
 - ALL PROPRIETARY MATERIALS TO BE INSTALLED IN ACCORDANCE WITH MANUFACTURERS INSTRUCTIONS
 - ALL TIMBERS TO BE PRESSURE IMPREGNATED

NOTE:
DAMP PROOFING WORKS BY SPECIALIST CONTRACTOR DIRECTLY APPOINTED BY EMPLOYER.
 ENABLING WORKS FOR DAMP PROOFING, TO BE BY MAIN CONTRACTOR INCLUDING:
 (SEE NOTES FOR DETAILS)

REVISIONS

NO.	DESCRIPTION

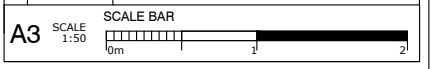

CLIENT
MR R. LEIGH

PROJECT
15 THE GREEN, RICHMOND, TW9 1PX

PROJECT DESCRIPTION
NEW GREEN ROOF TO CONSERVATORY

DRAWING NAME:
EXISTING GROUND FLOOR PLAN (PART)

John Rich Architect
 6a Royal Parade | Kew
 Richmond | Surrey | TW9 3QD
 t: 020 8940 0416 | f: 020 8940 3303
 e: mail@johnricharchitects.com
 w: www.johnricharchitects.com

DATE: JULY 15
 DRAWN: AY
 CHECKED: JR
 JOB NO:
RG
 DWG NO: REV:
RG 03 -