

KEY

- 30-minute protected staircase enclosure, with any glazing to be 30-minute fire rated
- Main escape route
- Alternative escape route

⊕
FIT MARK A

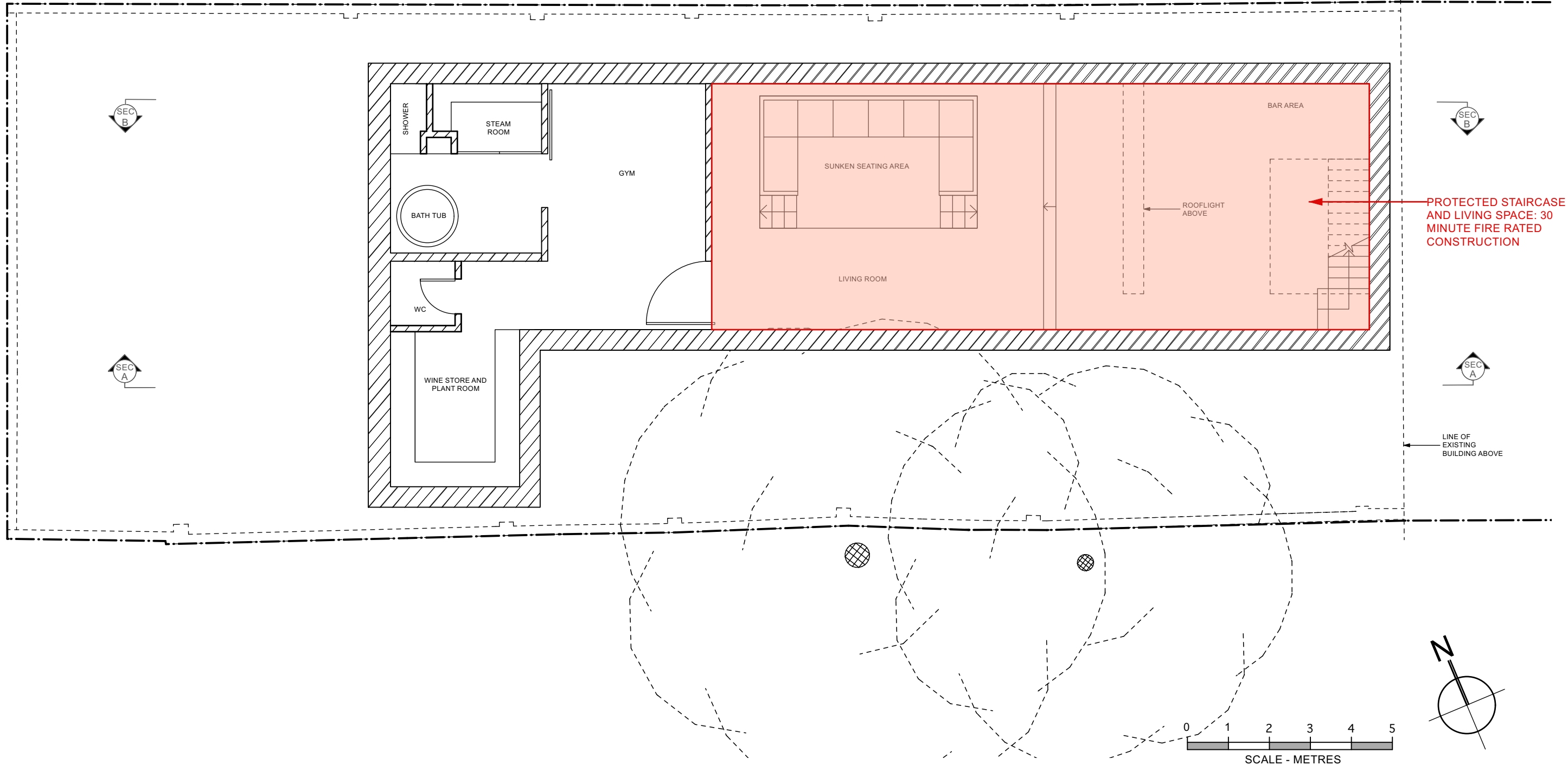

PROTECTED STAIRCASE AND LIVING SPACE: 30 MINUTE FIRE RATED CONSTRUCTION

LINE OF EXISTING BUILDING ABOVE

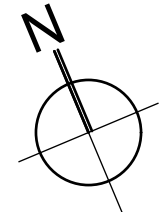
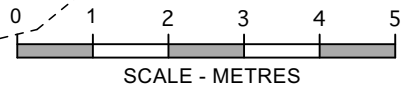

<p>Revisions</p>	<ol style="list-style-type: none"> 1. This drawing remains copyright of DyerGrimes Architects Limited and may not be reproduced or copied without consent in writing. 2. Do not scale drawing use figured dimensions only. 3. Any discrepancies between site and drawings to be reported to the architect immediately. 4. Read in conjunction with all relevant structural and mechanical & electrical engineers drawings. 5. Dimensions critical to proposed building works must be checked on site before building works commences, as certain assumptions have been made due to lack of accessibility and anomalies in the existing building. 	<p>Client & Address Mr Dyalan Nayager 107 Castelnau, Barnes, London, SW13 9EL</p>		<p>Title Fire Safety - Basement Plan</p>	
		<p>Date 03.09.24</p>	<p>Scale 1: 100 @ A3</p>	<p>No. 0654(01)21</p>	<p>Rev. A</p>

DyerGrimes Architecture | Studio 2, Three Eastfields Avenue
Riverside Quarter, London, SW18 1GN
T: 020 8874 0551 | info@dyergrimesarchitects.com
dyergrimesarchitects.com