

GROSVENOR ROAD

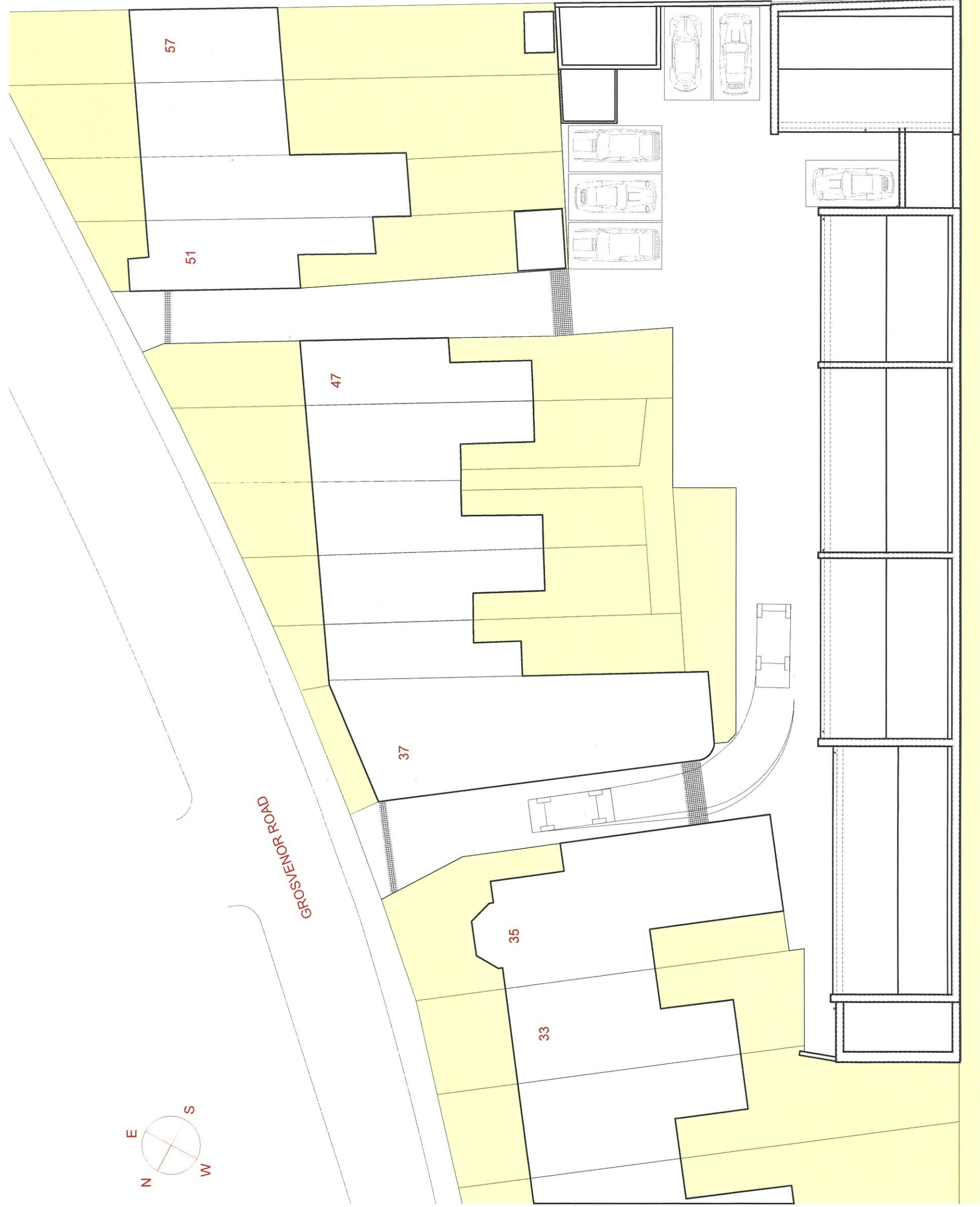

EXISTING

<small>© 2013 2402.003</small>	<small>scale bar 0 5m 10m 20m 0 10m 20m</small>	<small>notes</small>	<small>sheet</small> EXISTING & SITE PLAN @ ROOF LEVEL scale 1:100@A1 / 1:200@A3 date 13.05.24	<small>client</small> Charles Richards	<small>drawing number</small> 2402.003
				<small>project</small> Office Conversion Messom Mews 33 - 57 Grosvenor Road Twickenham, Middlesex TW1 4AD Genevieve Theissell Architecture & Interiors 19 Seymour Place London W1H 5FG t: 07504 974 056 e: mail@gtai.co.uk	<small>drawn</small> GT