

Proposed ASHPS Location to be checked and installed by the Manufacturer's Details and the Energy assessment Report

10 Meter

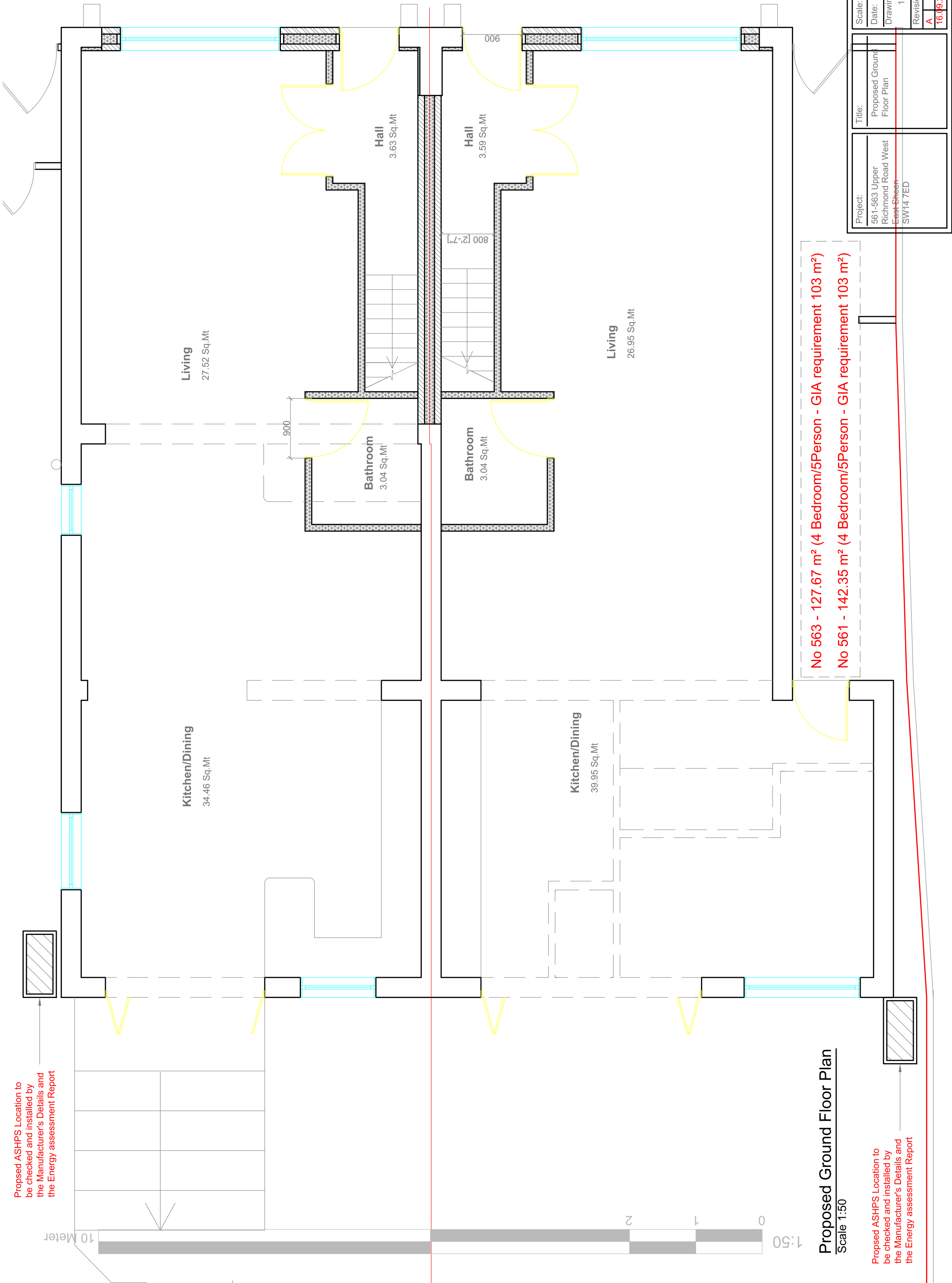

No 563 - 127.67 m<sup>2</sup> (4 Bedroom/5Person - GIA requirement 103 m<sup>2</sup>)  
No 561 - 142.35 m<sup>2</sup> (4 Bedroom/5Person - GIA requirement 103 m<sup>2</sup>)

### Proposed Ground Floor Plan

Scale 1:50

Proposed ASHPS Location to be checked and installed by the Manufacturer's Details and the Energy assessment Report

Project:	561-563 Upper Richmond Road West East Sheen SW14 7ED	Title:	Proposed Ground Floor Plan	Scale:	1:50 @ A3
				Date:	03 . 2024
				Drawing No.:	175 - 03/MT
				Revision	A
					16/09/2024