

Front Elevation

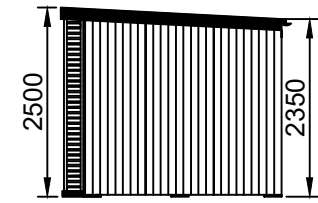

Right Elevation

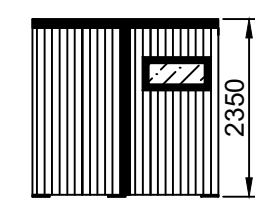

Rear Elevation

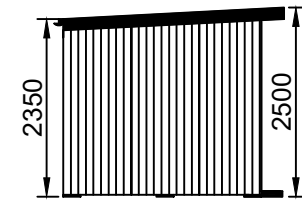

Left Elevation

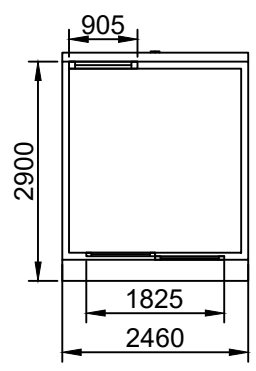

Floor Plan

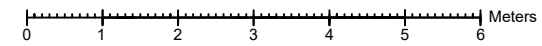

**General Construction:**

**Roof:**  
80mm insulated steel panel that is reinforced with a 1mm powder-coated steel.

**Floor:**  
80mm polyurethane insulation is supported by a 1mm powder-coated steel.

**Walls:**  
9mm white MDF board with 75mm thick eco-polymer foam insulation and 9mm LPStrongcore.

**Cladding:**  
Vinyl Coated PVC Oak Coloured Cladding.

**Doors:**  
Sliding doors (1825mm x 2070mm, fully glazed) with Planitherm glass.

**Windows:**  
Lozenge Window (905mm x 440mm, Opening: top-hung) with Planitherm glass.

Drawing Title: Alison Archibald	Number: 1.	Scale: 1:100 All measurements in mm, setup for A3 printing.
Designed By: Becky Harper	Date: 12/09/2024	
Installation Address: Chestnuts Day Nursery 22 Trafford Road Twickenham TW1 3AE	Design: Basebox - 2.44m x 2.44m	
		Reference: 240700270MBS1