

1. All boundaries, dimensions and levels are to be checked on site before construction and any discrepancies are to be reported to the Architect. 2. Drawings may be scaled from for planning purposes. 3. Drawings not supplied in paper format by Will Aust Architecture may not be to the scale indicated in the size box. 4. This drawing is copyright and may not be reproduced or used for any purpose other than that intended without the prior written agreement of the Architect. 5. Any parts of the drawing based on Ordnance Survey maps are executed with the sanction of the controller of H.M. Stationery Office - Crown Copyright Reserved.

1. Proposed Site Section / Typical Elevation 1:500

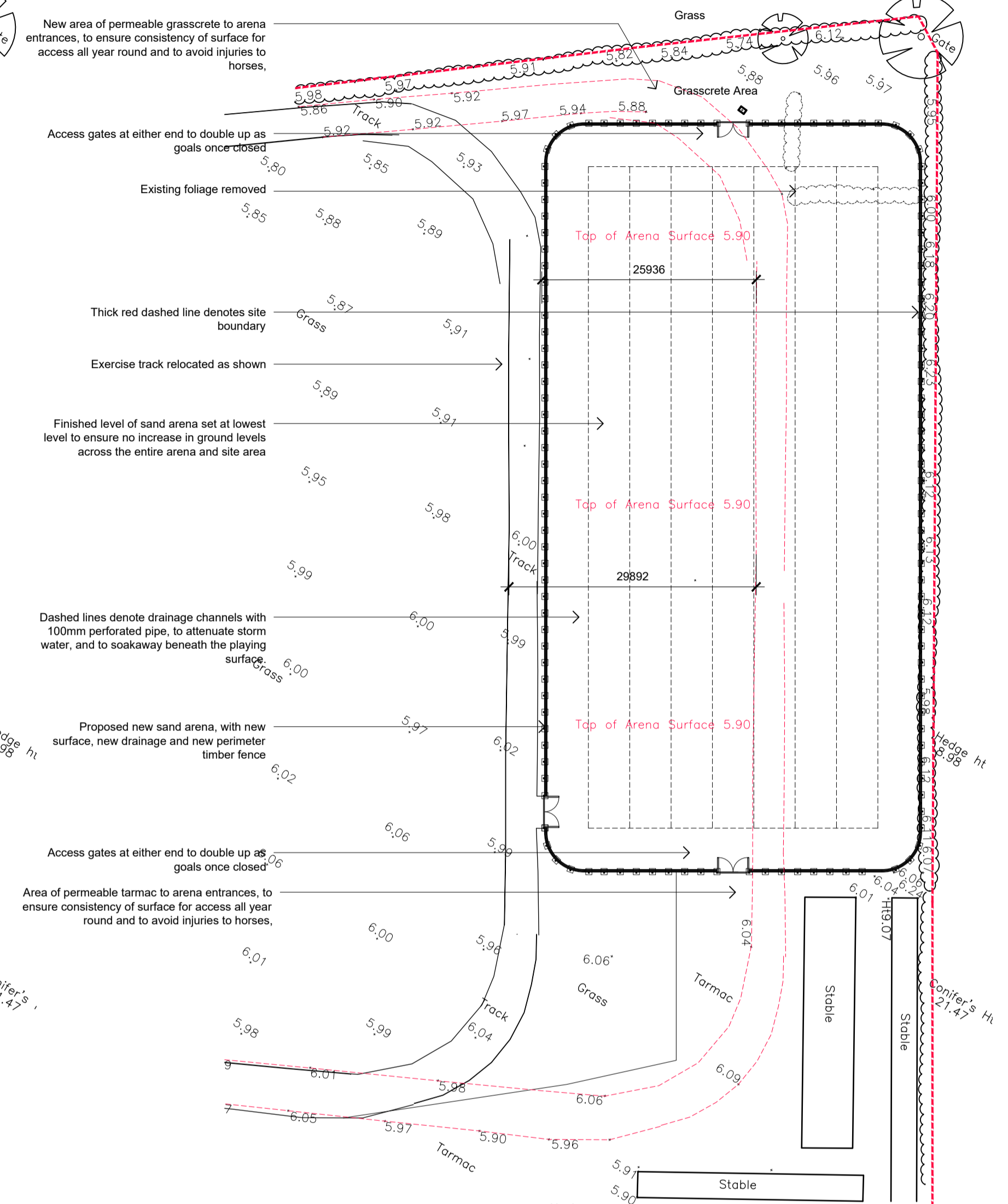

2. Existing Site Plan 1:500

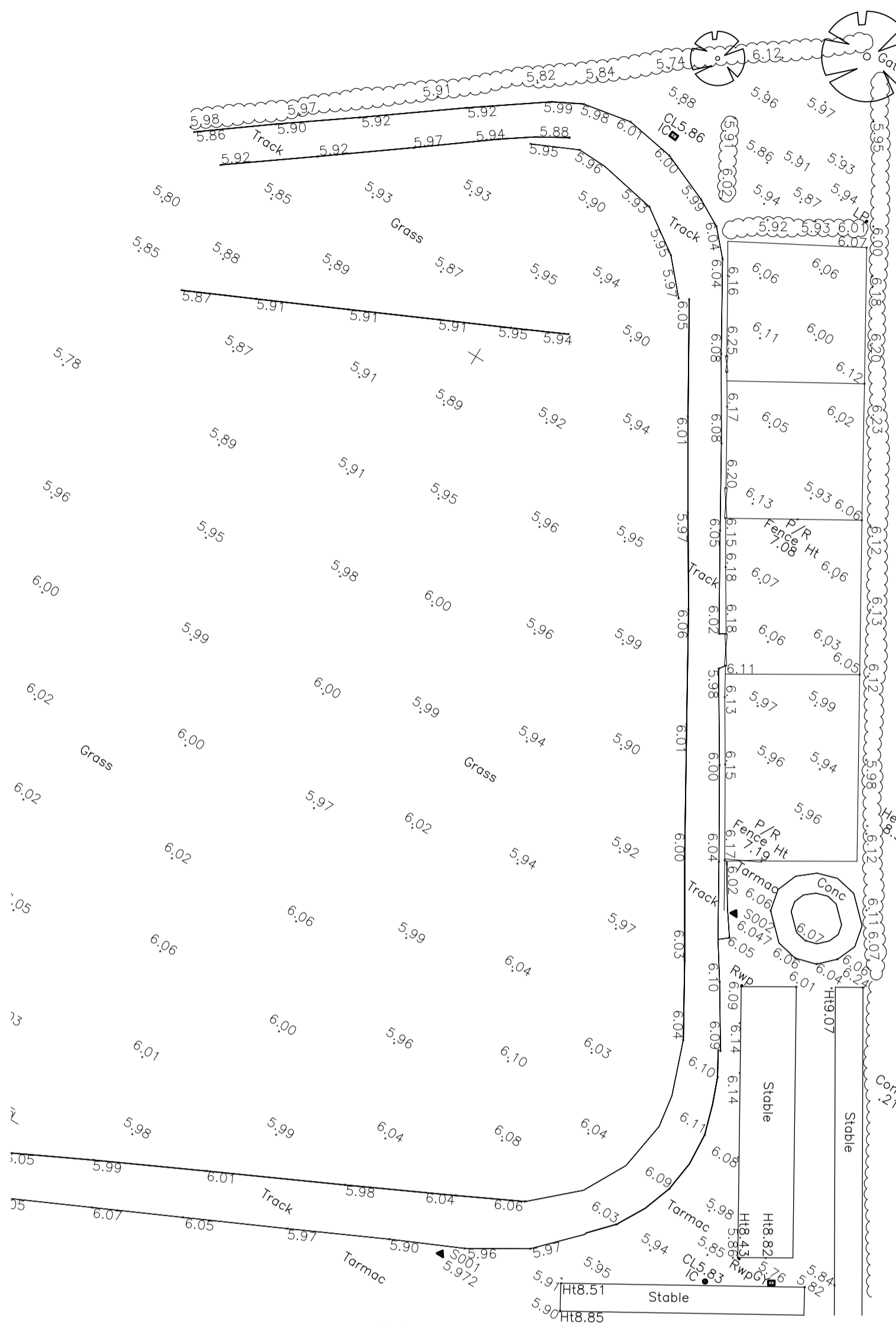
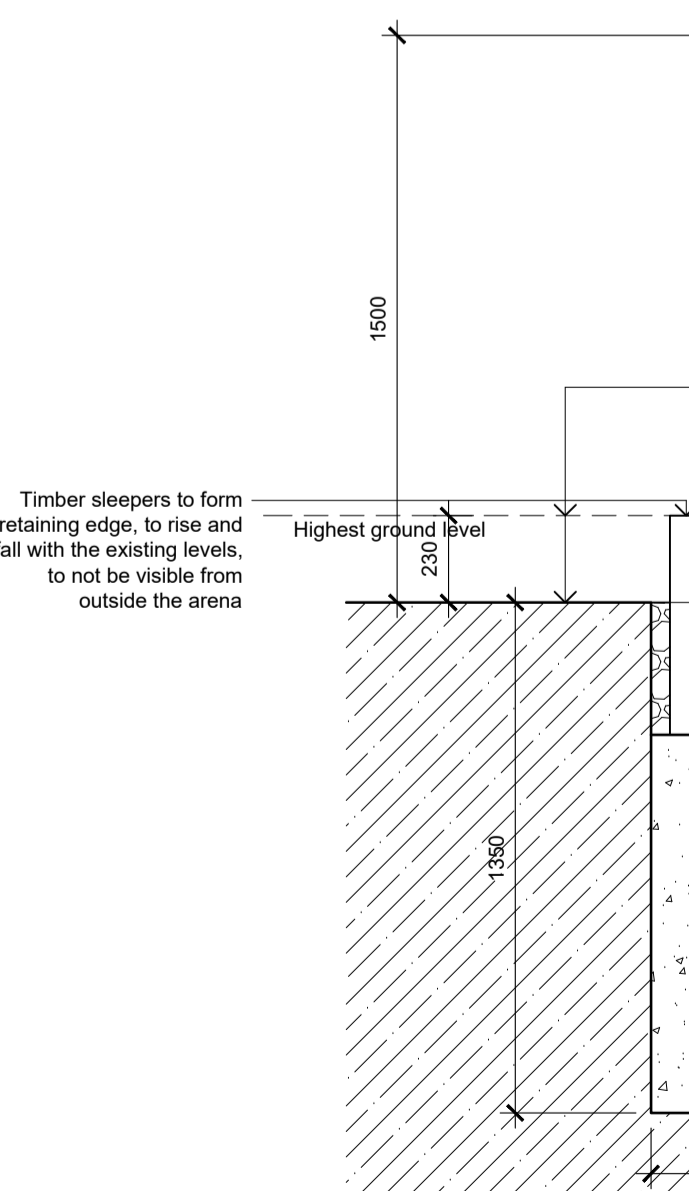

4. Fence / Arena Floor Detail 1:20

3. Proposed Site Plan 1:500

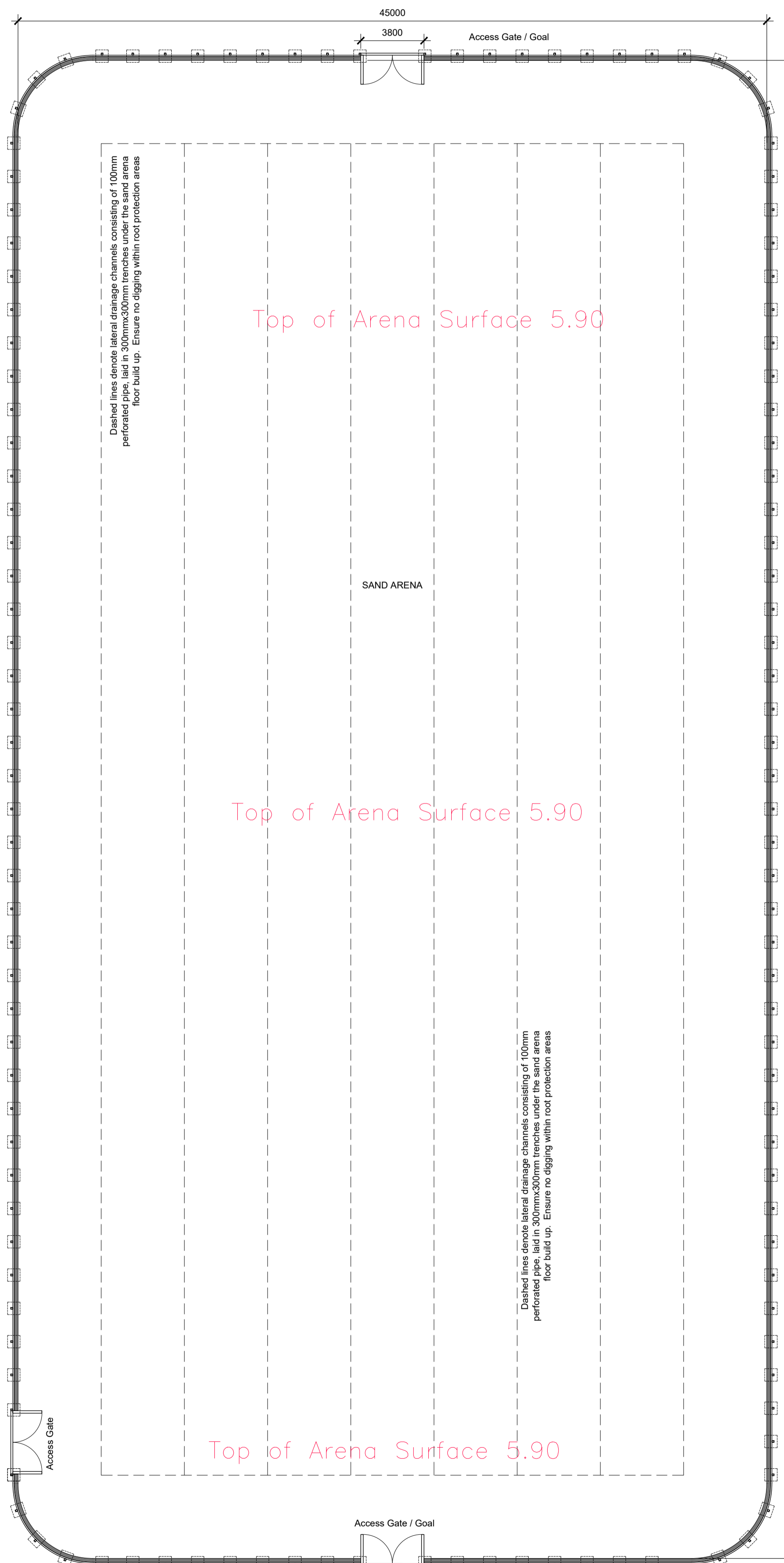

5. Proposed Arena Plan 1:200

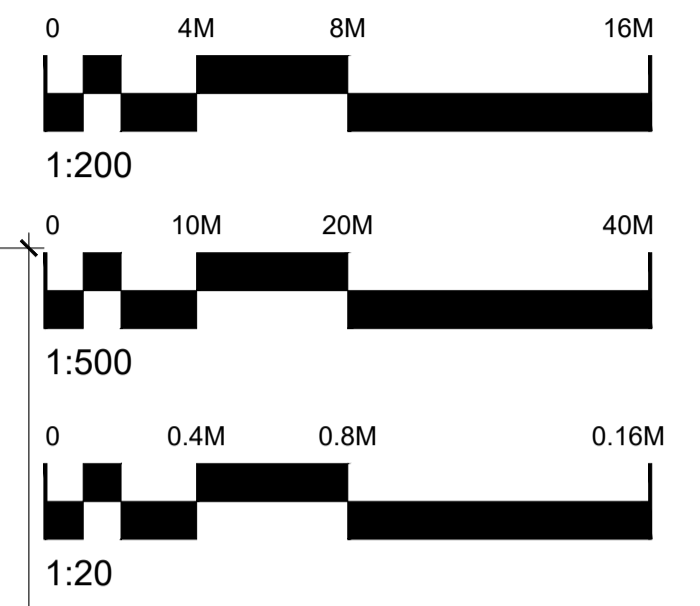

Rev	Date	Description	By	Chk

WILLAUSTARCHITECTURE
162 Julian Road
West Bridgford
Nottingham
NG2 5AN
t: 07738260093
e: wil@willaust.co.uk
w: www.willaust.co.uk

Client:
Ham Polo Club

Project:
Proposed Sand Arena Extension

Drawing title:
Proposed Plans and Details

Scale(s): Varies	Size: A1	First issue: 24.07.24	Drawn: WA
Job no: LTD34a	Drawing no: 10	Rev: C	

PLANNING