

PROPOSED LOFT PLAN

PERMITTED DEVELOPMENT VOLUME
CALCULATION

Volume 01 - Hip
Area base = $1/2 (4.5m \times 9.025m) = 20.3m^2$
Volume hip = $1/3 (20.3m^2 \times 3.4m) = 23m^3$

Volume 02 - Dormer
 $5.23m \times 3.05m \times 2.5m = 37.0m^3 / 2 = 20m^3$

Total Additional Volume
 $23m^3 + 20m^3$
 $m^3 = 43m^3 < 50m^3 = OK$

note : the existing loft conversion , ref
planning application number 87 / 0505
granted is to be demolished. the proposed
loft remains under 50m³.

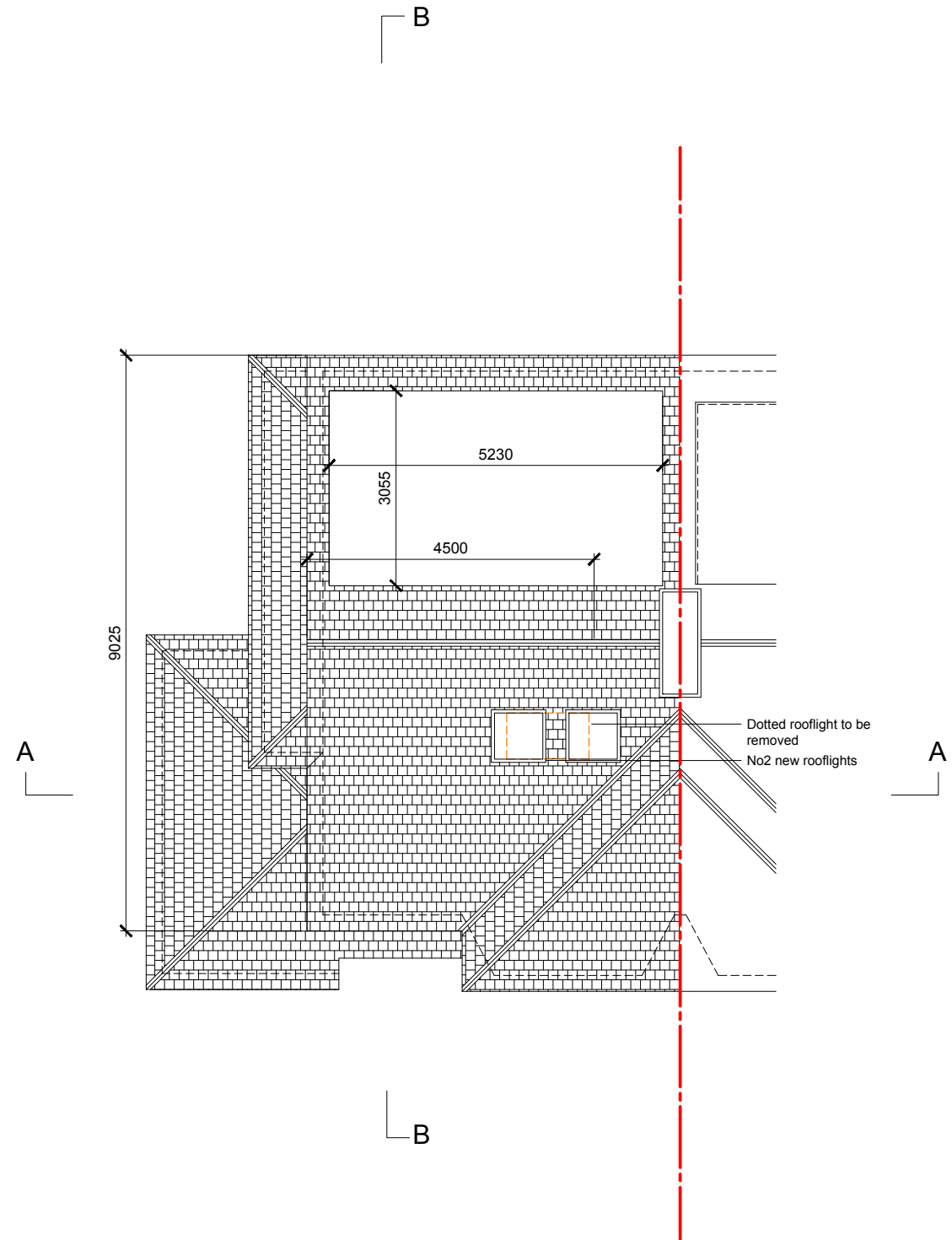

PROPOSED ROOF PLAN

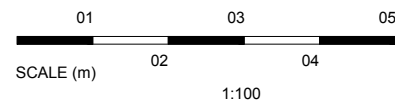
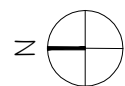

drawn GD	project	38 Grange Avenue	purpose of issue	PLANNING	Giovanna Daldello ARB RIBA ARCHITECT gdaldello@icloud.com 07736506701
	scale @ A3	1:100	drawing	Proposed Loft and Roof Plan	
	date	20.08.2024			