

**EXISTING PLAN**

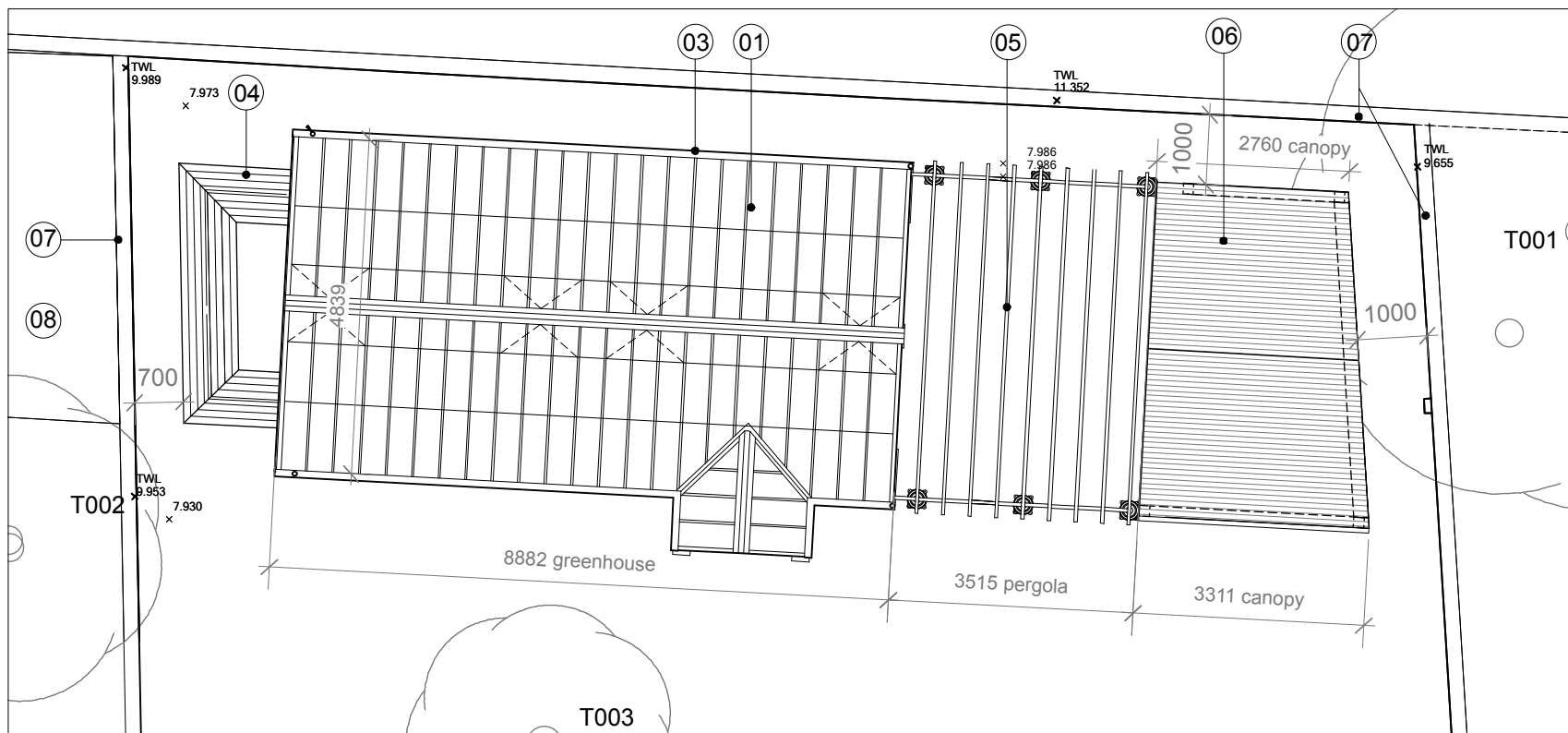

**PROPOSED ROOF PLAN**

1	Greenhouse - glass/ green/grey frame
2	Ridge cresting and finial to match framing
3	Reclaimed brick wall
4	Tiled pitched roof
5	Pergola with ornate columns to match greenhouse
6	Canopy with open front and back and side, with reclaimed slate tiles and oak columns
7	Brick boundary wall
8	Outbuilding no15

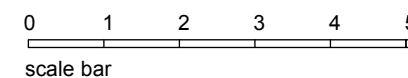
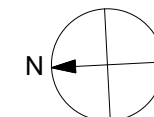

30/09/24 Planning submission  
27/09/24 Draft HB issue

<b>SOPHIE BATES ARCHITECTS</b>	SADBROOK GARDENS			
	<b>GREENHOUSE</b> existing/ proposed roof plan			
29 ST. GEORGES ROAD, KINGSTON, KT2 6DL T-07725 501683 E-SOPHIE@SOPHIEBATES.COM WWW.SOPHIEBATES.COM	job no	scale	drawing no	revision
	047	1:100	<b>GP-04</b>	