

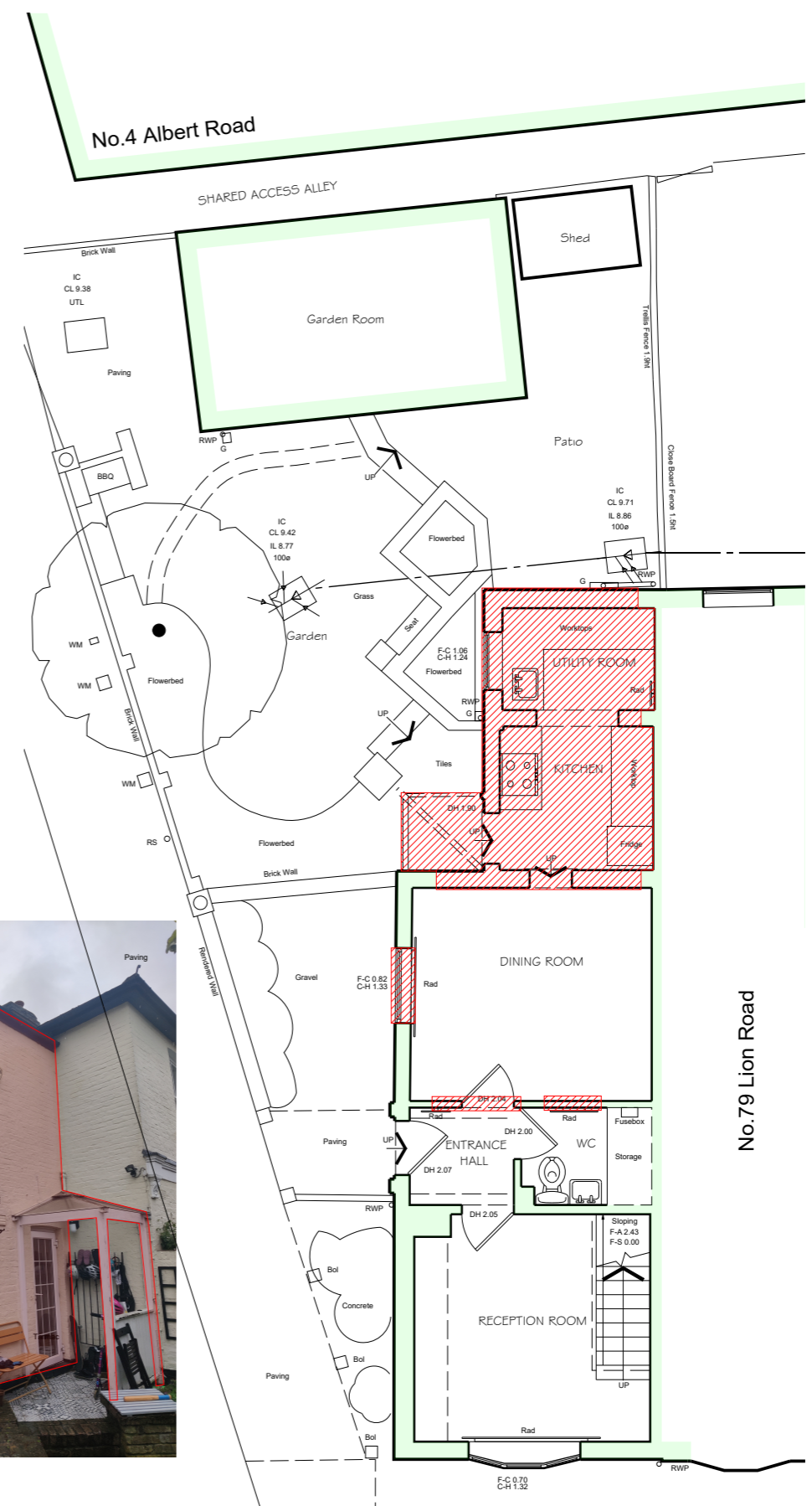

Existing Site Plan



Photo of rear wing to be demolished



Existing Site Plan (with demolition shown hatched)

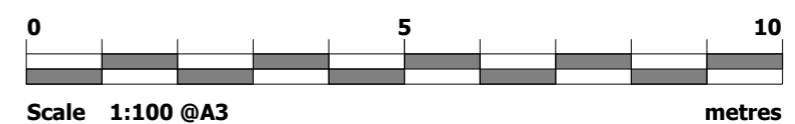
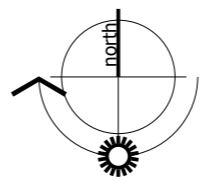

Scale 1:100 @A3

© Copyright belongs to Green Cu3ed ©

This drawing is to be scaled for planning purposes only. All dimensions to be checked on site before production or work begins on site. Any discrepancies to be notified immediately to Green Cu3ed.

Project Address
77 Lion Rd TW1 4HT

Project No. 2402
Drawing No. EX 01
Revision B
Date July 2024

Drawing Title
Existing Site Plan (+ Scope of Demolition)

Status
EXISTING

77 Lion Road

Green Cu3ed
The Bathhouse Design Studio
100 Bathhouse Lane
Teddington TW11 9NN
T 020 8973 0064
E office@greencu3ed.co.uk
W www.greencu3ed.co.uk

1. This drawing is to be read in conjunction with all relevant Architectural, Services and Structural drawings.
2. Contractors, sub-contractors and suppliers to verify any critical dimensions on site prior to fabrication of any building element, with any discrepancies to be reported immediately.
3. This drawing is to be read in conjunction with all relevant specifications and consultants information and any discrepancies reported prior to installation.