

Notes

THIS DRAWING READ IN CONJUNCTION WITH :

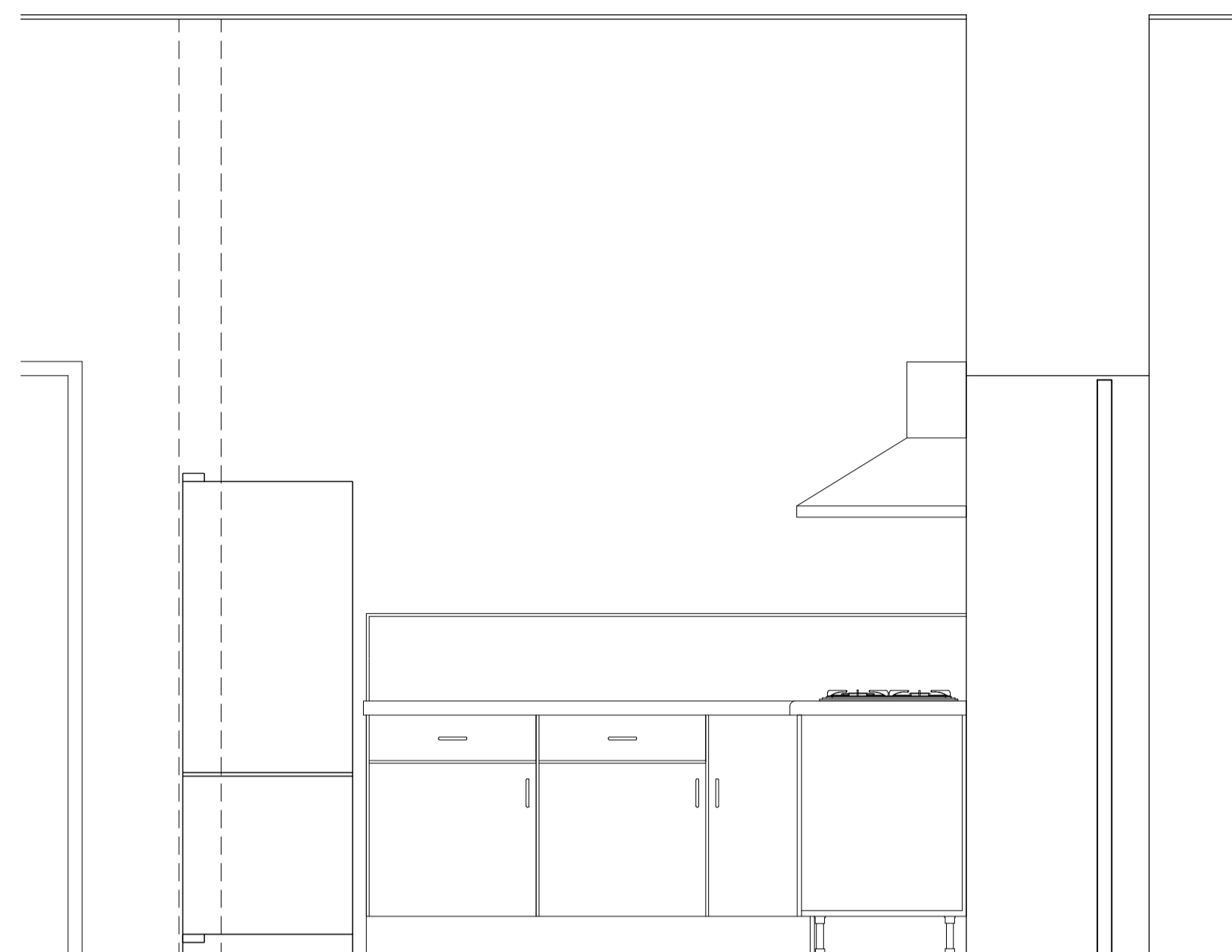

Proposed Kitchen Elevation (2 Bed)

Scale 1:20@ A1



Proposed Kitchen Elevation (2 Bed)

Scale 1:20@ A1



Proposed Kitchen Elevation (2 Bed)

Scale 1:20@ A1

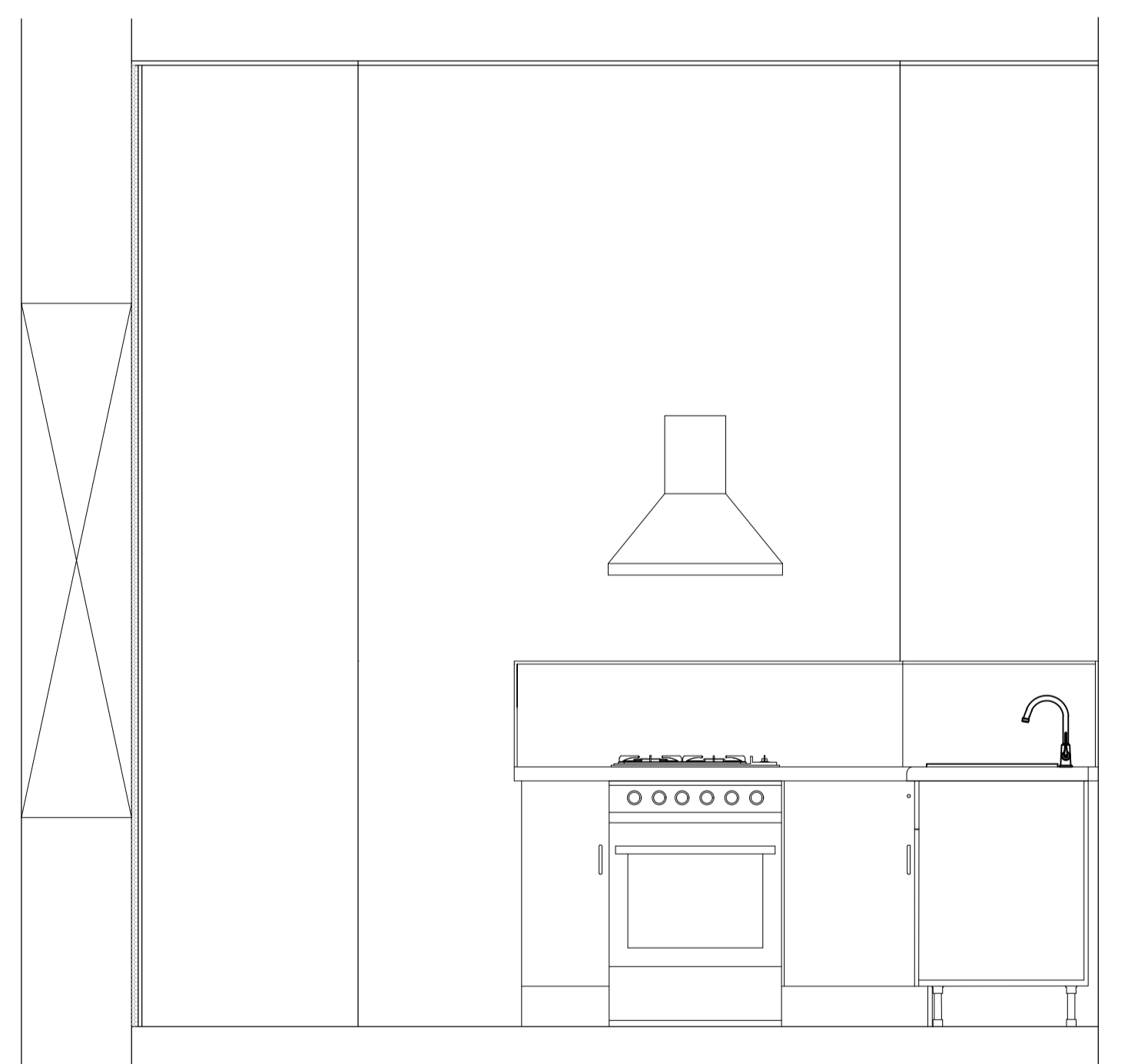

Proposed Kitchen Elevation (1 Bed)

Scale 1:20@ A1

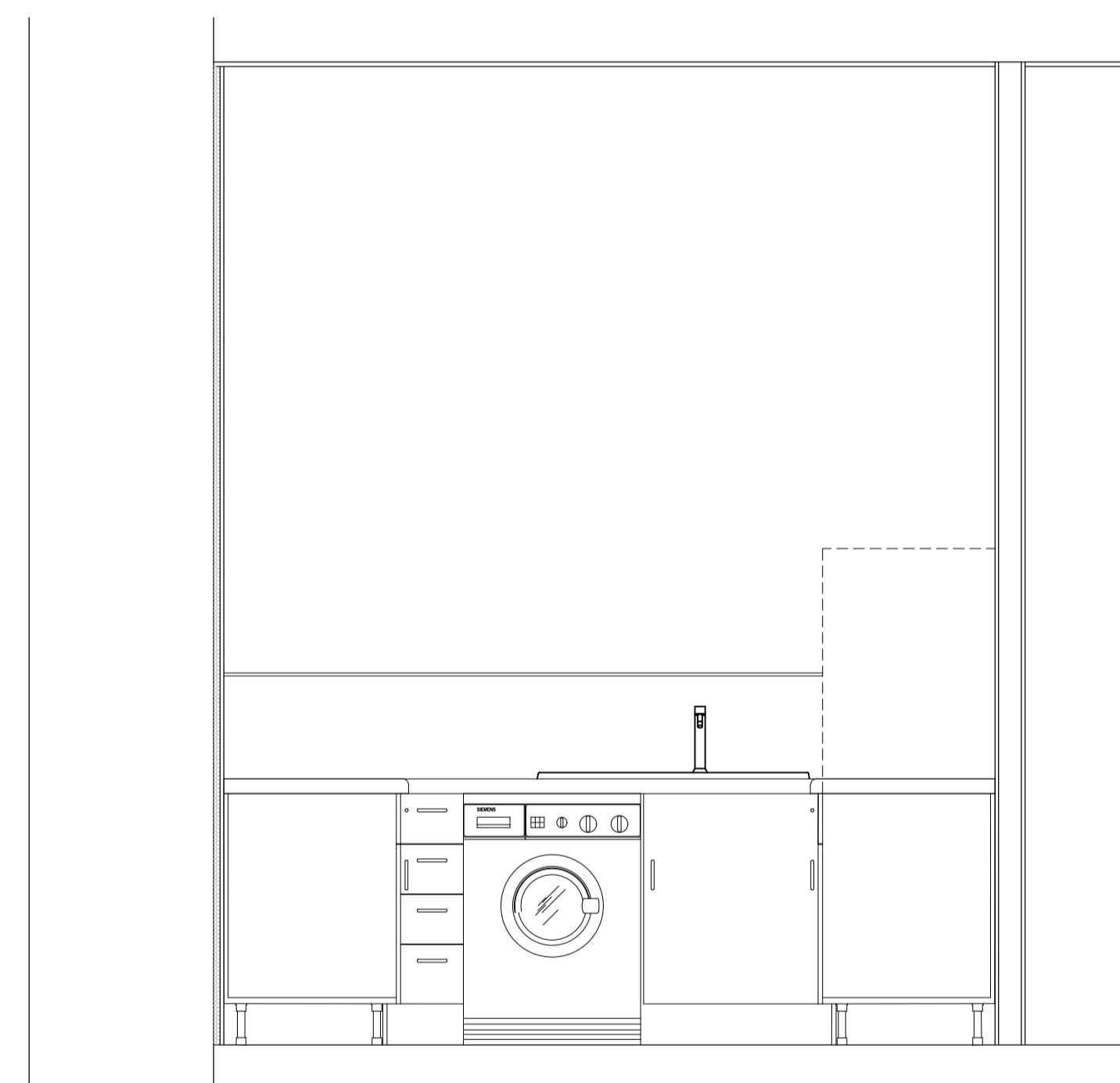

Proposed Kitchen Elevation (1 Bed)

Scale 1:20@ A1

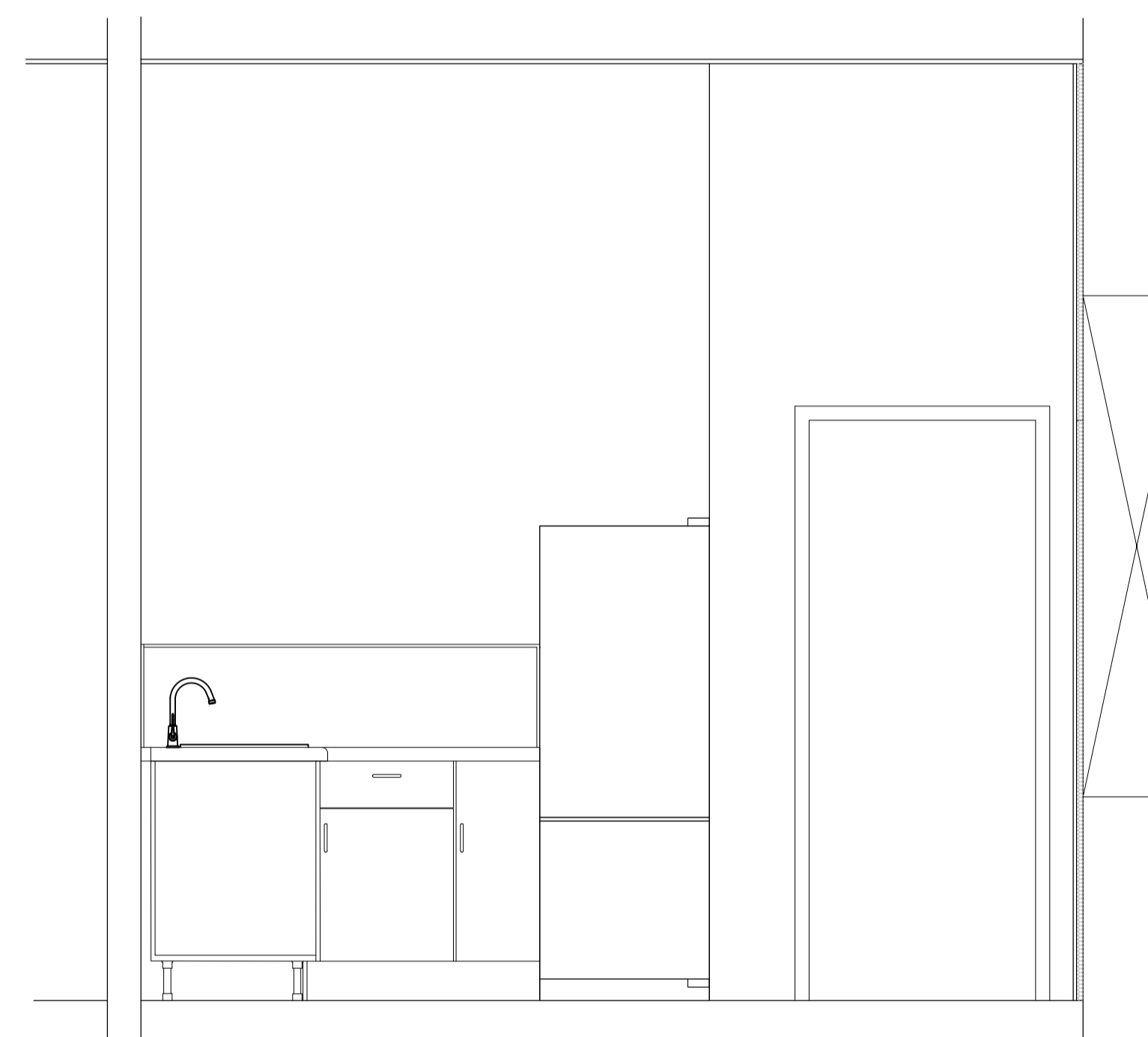

Proposed Kitchen Elevation (1 Bed)

Scale 1:20@ A1

GENERAL NOTES :

- Howdens Hockley Range with quartz work tops and matching splashbacks.
- Integrated Appliances, include boss appliances, Fridge Freezer, Hob, Over, Microwave, Washer Drier, Dish Washer.
- Karndean Opus Grandio flooring in Kitchen

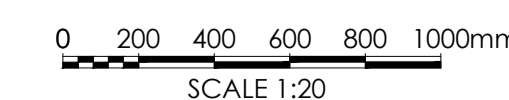

| | | | | |
|-------------|--------------|--------|-------------|--------|
| A | LBC Issue | Oct.24 | IM | AB |
| Rev | Description | Date | Dr by | App by |
| | date created | Aug.24 | | AB |
| original by | | | Approved by | |
| im | | | | |

AHR AHR Building Consultancy Ltd
 Vintry Building
 Wine Street
 Bristol
 BS1 2BD
 United Kingdom

T +44(0)117 9299146
 E bristol@ahr.co.uk
 www.ahr.co.uk

| | |
|---------|--|
| client | South Western Railway |
| project | Teddington Railways Station Station House Accommodation Refurbishment |
| drawing | Station House Proposed Internal Elevations |

| | | | | |
|----------------|----------------|-------|--------------|--------------|
| project number | 2024.00490.001 | scale | As Indicated | @A1 |
| drawing number | 009 | rev | A | issue status |
| | | | LBC | |

This drawing is to be read in conjunction with all related drawings. All dimensions must be checked and verified on site before commencing any work or producing shop drawings. The originator should be notified immediately of any discrepancy. This drawing is copyright and remains the property of AHR.