

- Existing retained
- Existing to be removed
- Proposed

BUSHY PARK

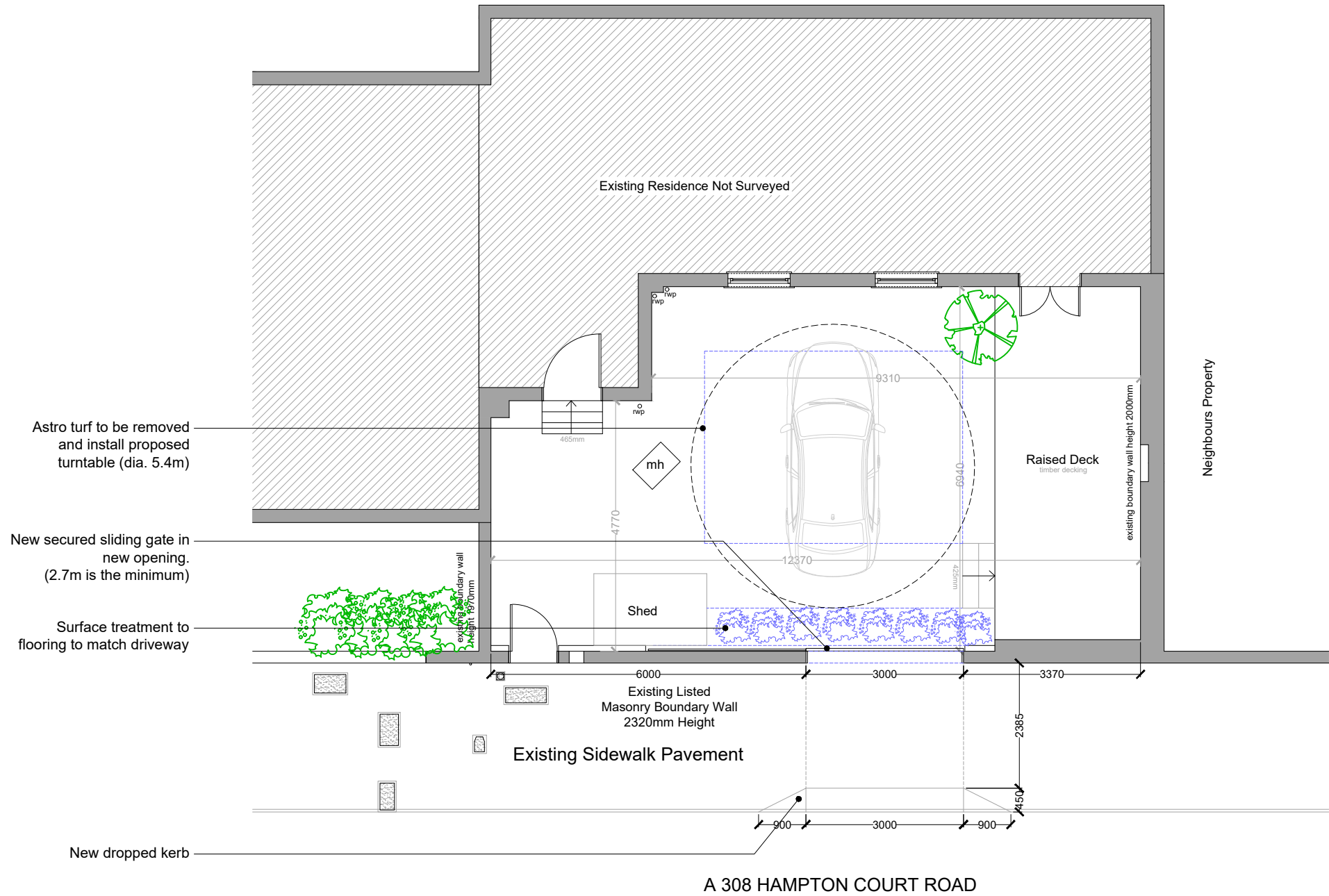

01 Proposed Ground Floor Plan

1:100 @ A3

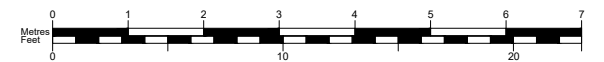

50° North

50° North Architects
The Hut, 187 Kew Road
Richmond, Surrey TW9 2AZ

info@50degrees.co.uk
020 8744 2337
50degrees.co.uk

project north



notes

1. This drawing is for early-stage design and planning applications only, and therefore should NOT be used for construction.
2. The red line is to identify the property only, and is based on Ordnance Survey data only. It is not intended to identify physical or ownership boundaries.
3. Any dimensions shown are indicative only, and are subject to change at technical drawing stage.
4. Do not scale off this drawing.

key plan
not to scale

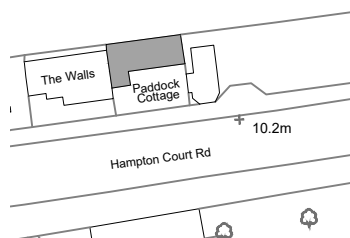

revisions

REV	DATE	DRAWN BY	APPR. BY	NOTES
-	25.04.2024	OG	LB	first issue
A	24.06.24	OG	LB	revised issue
B	08.11.2024	OG	LB	revised issue

client:

DEBORA BERARDI

project:

**PADDOCK COTTAGE
HAMPTON COURT KT8 9DA**

status:

PROPOSED

revision:

B

title:

GROUND FLOOR PLAN

drawn by:

OG

approved by:

LB/TB

date:

22.04.2024

job no:

2749

scale:

1:100@A3

drawing no:

010_B