

- General**
- 1.1. Refer to MNP drawing S-000 for full notes.
  - 1.2. This drawing is to be read in conjunction with all Architect's, Engineer's and Services Engineer's drawings and specifications.
  - 1.3. Do not scale from any of the structural drawings. All dimensions to be verified on site and any discrepancies should be highlighted.
  - 1.4. All waterproofing to the Architect's details.
  - 1.5. All materials to comply with the relevant British Standard.

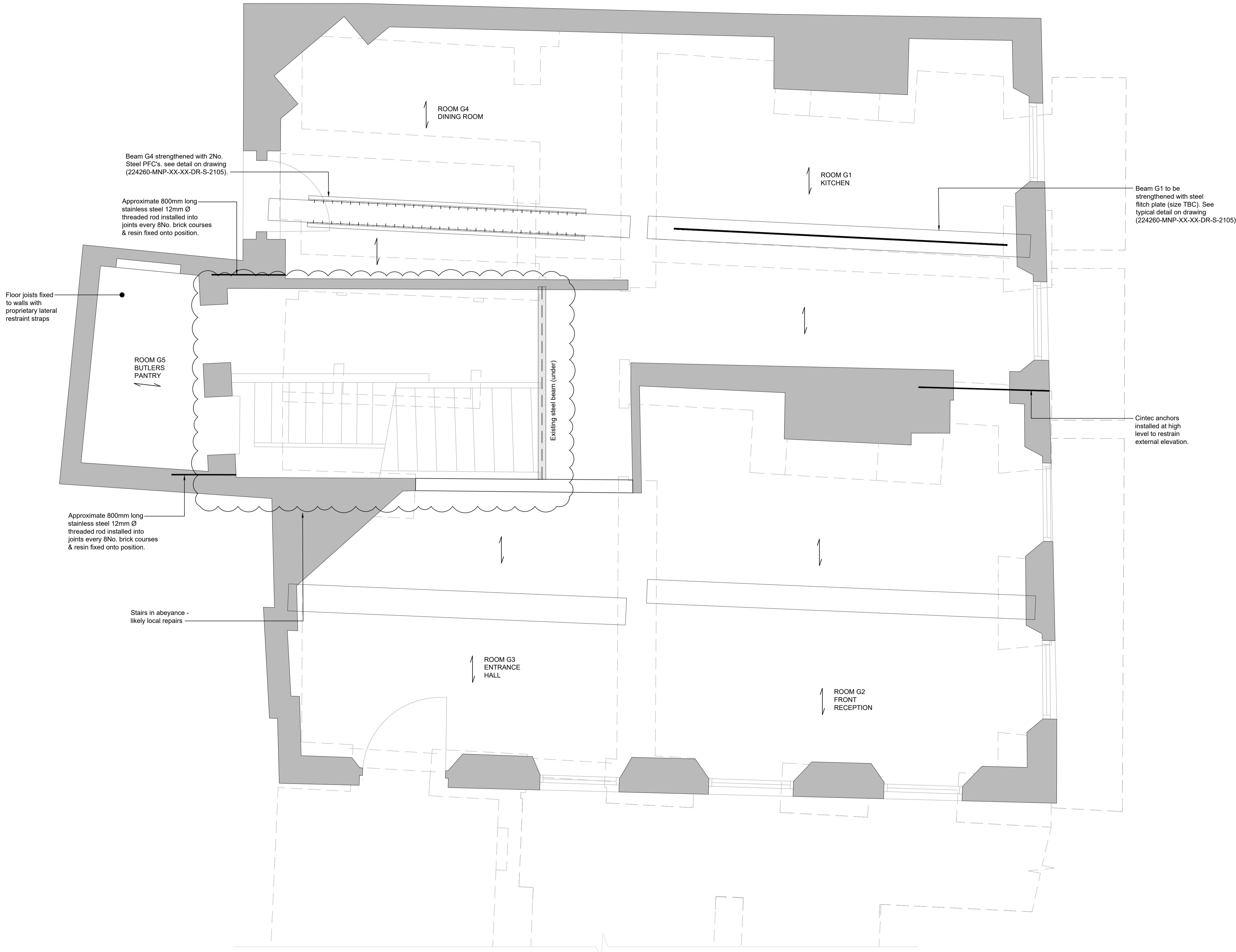

Beam G4 strengthened with 2No. Steel PFC's. see detail on drawing (224260-MNP-XX-XX-DR-S-2105).

Approximate 800mm long stainless steel 12mm Ø threaded rod installed into joints every 8No. brick courses & resin fixed onto position.

Floor joists fixed to walls with proprietary lateral restraint straps

ROOM G5 BUTLERS PANTRY

ROOM G4 DINING ROOM

ROOM G1 KITCHEN

Beam G1 to be strengthened with steel fitch plate (size TBC). See typical detail on drawing (224260-MNP-XX-XX-DR-S-2105).

Existing steel beam (under)

Cintec anchors installed at high level to restrain external elevation.

Approximate 800mm long stainless steel 12mm Ø threaded rod installed into joints every 8No. brick courses & resin fixed onto position.

Stairs in abeyance - likely local repairs

ROOM G3 ENTRANCE HALL

ROOM G2 FRONT RECEPTION

**Key**

	Existing joists
--	-----------------

**Note:**  
Allow for fixing all joists to main beams & walls with 90 x 90 x 60 proprietary steel cleats

**Note:**  
Allow for internal cracking to be repaired with helical ties with 500mm embedment length either side of the cracks.

**Note:**  
Once timber paneling is removed in accordance with conservation architects requirement. MNP to inspect, an allowance for internal cracking to be repaired with Helical ties, with a 500mm embedment length either side of cracks. Furthermore allow for any larger cracks to be repaired with cintec anchors.

P01	PRELIMINARY ISSUE	15.11.24	CM
REV	COMMENTS	DATE	CHK
STATUS			

**PRELIMINARY**

**mason navarro pledge**  
Consulting Civil and Structural Engineers  
LONDON · MANCHESTER · HITCHIN  
0203 9265613 0161 8701197 01462 632012  
Email: office@mnp.co.uk  
www.mnp.co.uk

CLIENT  
**SHAUN BROWN**

PROJECT  
**32 THE GREEN,  
RICHMOND  
LONDON**

DRAWING TITLE  
**PROPOSED  
GROUND FLOOR GA**

SCALE @ A1	DRAWN BY	DATE
1:25	JSE	31.07.24
MNP No.	STATUS CODE	REV
224260	S0	P 01
REF No: 224260-MNP-XX-00-DR-S-1100		