

- General**
- 1.1. Refer to MNP drawing S-000 for full notes.
 - 1.2. This drawing is to be read in conjunction with all Architect's, Engineer's and Services Engineer's drawings and specifications.
 - 1.3. Do not scale from any of the structural drawings. All dimensions to be verified on site and any discrepancies should be highlighted.
 - 1.4. All waterproofing to the Architect's details.
 - 1.5. All materials to comply with the relevant British Standard.

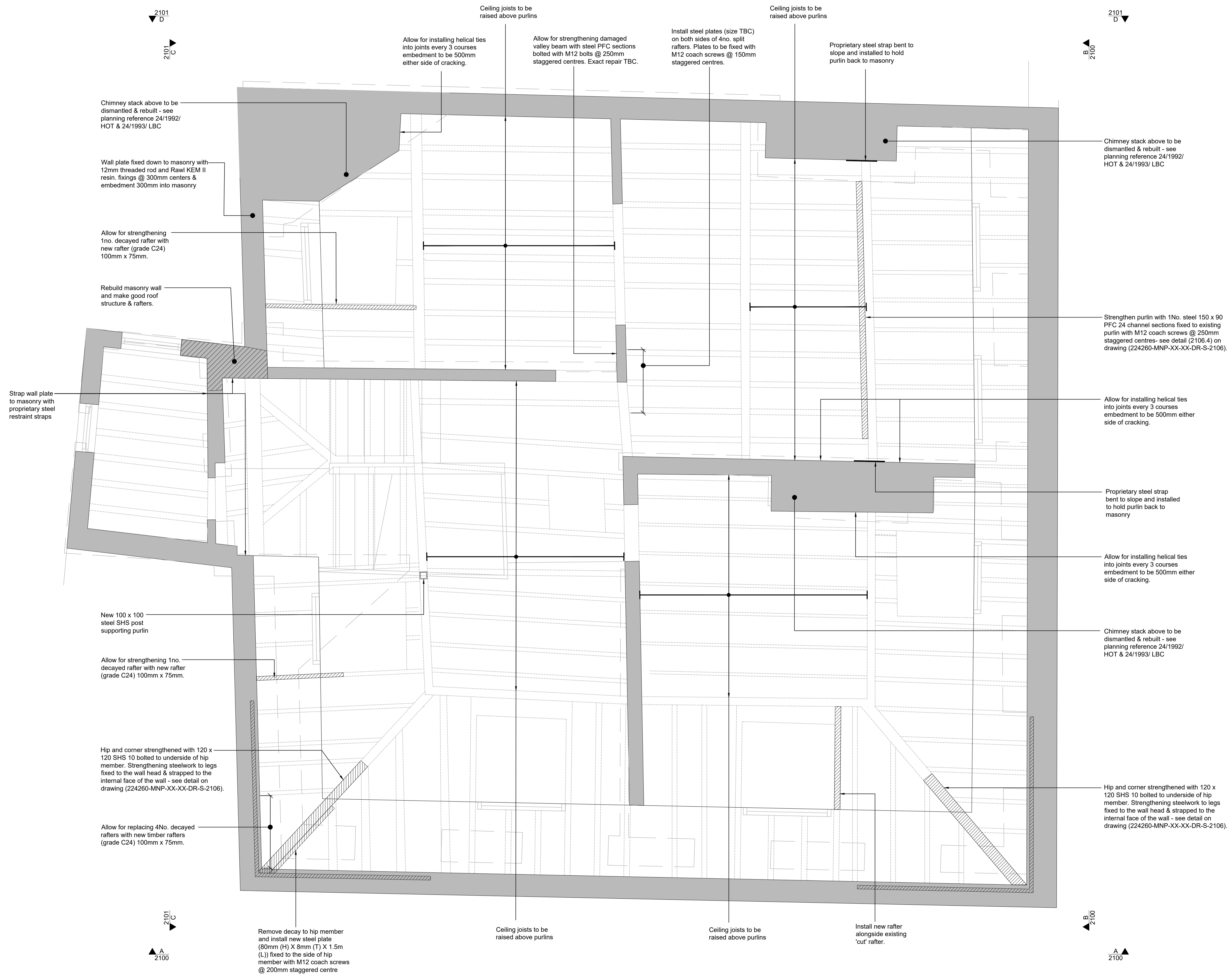

Note:
Install additional timbers 100 x 75 C24 around all roof dormers/ roof lights

P01	PRELIMINARY ISSUE	15.11.24	CM
REV	COMMENTS	DATE	CHK
STATUS			

PRELIMINARY

mason navarro pledge
Consulting Civil and Structural Engineers
LONDON · MANCHESTER · HITCHIN
0203 9265613 0161 8701197 01462 632012
Email: office@mnp.co.uk
www.mnp.co.uk

CLIENT
SHAUN BROWN

PROJECT
**32 THE GREEN,
RICHMOND
LONDON**

DRAWING TITLE
PROPOSED SECOND FLOOR CEILING GA

SCALE @ A1	DRAWN BY	DATE
1:25	JSE	31.07.24
MNP No.	STATUS CODE	REV
224260	S0	P 01
Ref No: 224260-MNP-XX-03-DR-S-1103		