

The following risks are identified as unusual or unfamiliar to a competent contractor

CONSTRUCTION

DEMOLITION RISKS (FUTURE)

It is assumed that all work will be carried out by a competent contractor working, where appropriate, to an approved method statement

Platform Lift

1 : 100

- 1. Entrance at intermediate level from the street
- 2. Cycles exit at lower basement level to storage and showers
- 3. Wheelchair users exit at upper ground floor level into reception

Existing Metal Balustrade and Gates to be extended higher with like-for-like metal finish to raise balustrade level and conceal external bin store. For further Visual obstruction vertical timber slats to be secured to the balustrade internally. Existing Gate to be split and re-hung to swing outwards for bin access'

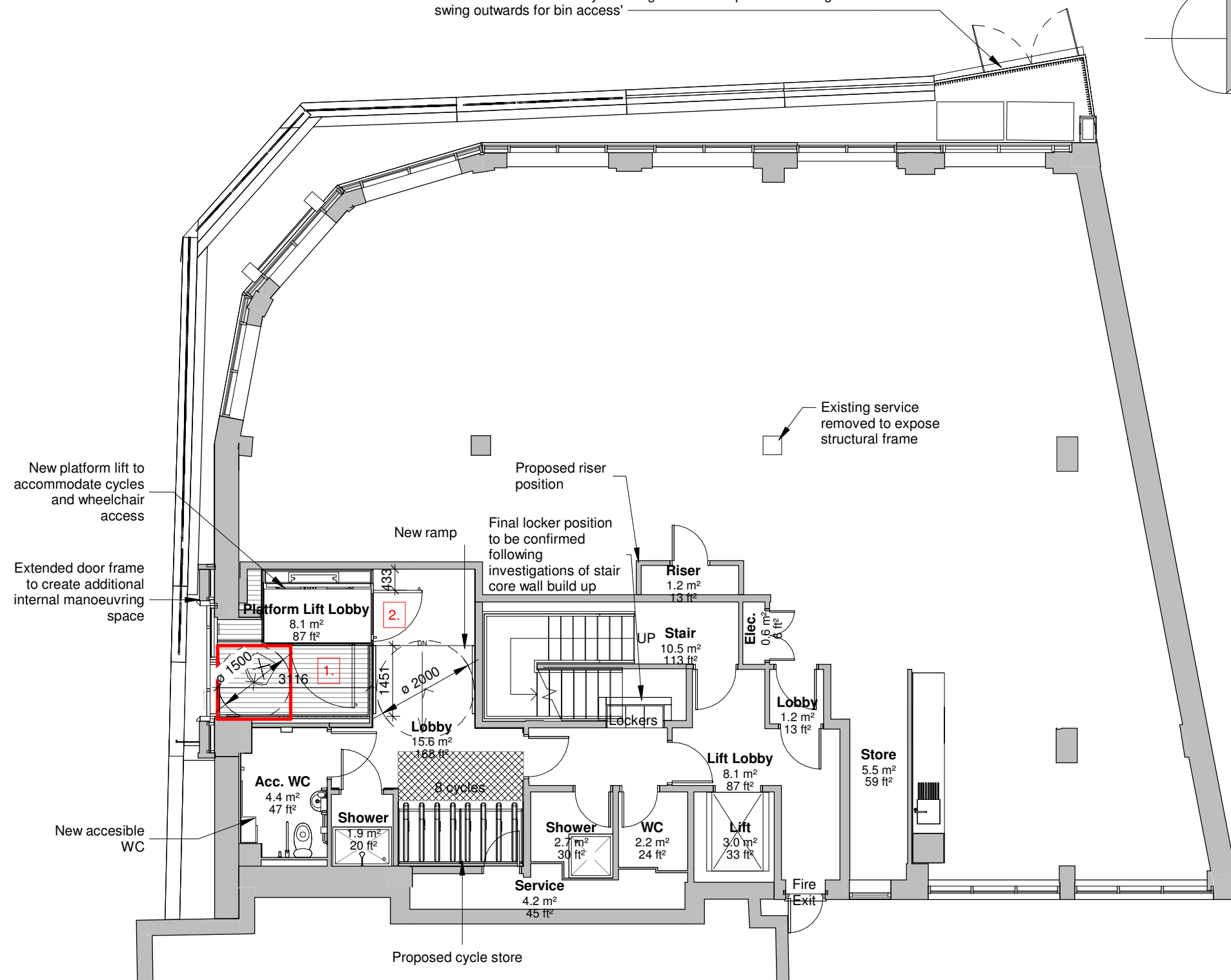
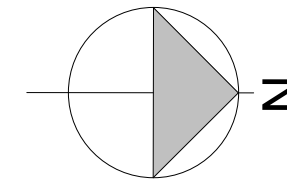

Proposed Lower Ground Plan

1 : 100

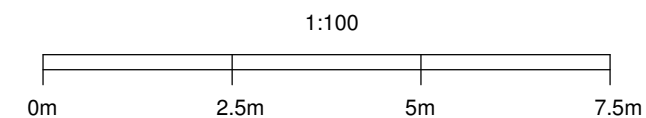

REV	DETAILS	DATE	DRN/CHK
C	Updated for Planning Application Issue - AB	13/05/24	ST
B	Updated notes and Mail Box positions - AB	19/03/24	MH
A	Updated Bin Store Area - MR/AB	11/03/24	MH

mail@bhbarchitects.co.uk

LICHFIELD
01543 254357

CHELTENHAM
01242 521608

RIBA Chartered Practice

Peregrine House, Richmond		DRAWING NO. 4047 - 12	
Proposed Lower Ground Plan		REV	DATE
Guy Wilson		C	JAN '24
PLANNING		DRN	CHK
		AB	MH/ST
		SCALE 1 : 100 @ A3	

ISO 9001 REGISTERED FIRM

ISO 14001 REGISTERED FIRM

The copyright of this drawing and design is vested in the Architect and must not be copied or reproduced without written consent. All dimensions given are to be verified on site by the responsible contractor. Do not scale dimensions from this drawing.

THE Green REGISTER
OF CONSTRUCTION PROFESSIONALS