



The Harris Group Ltd does not accept liability for any deviation to our drawings or specification. This Drawing is copyright and may not be reproduced in whole or part without written authority. Do not scale off this drawing.

Feasibility Drawing

This drawing has been prepared for feasibility purposes. Do not scale from this drawing. Notify any discrepancies to the Architect. Subject to topographical & arboricultural survey, highways, confirmation of legal boundaries, services locations, and easements.

Plan based on OS MAP and Greenhatch plan : 30771_01_P

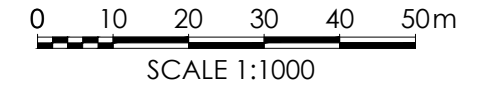

Rev	Date	Description	Drawn	Chk'd

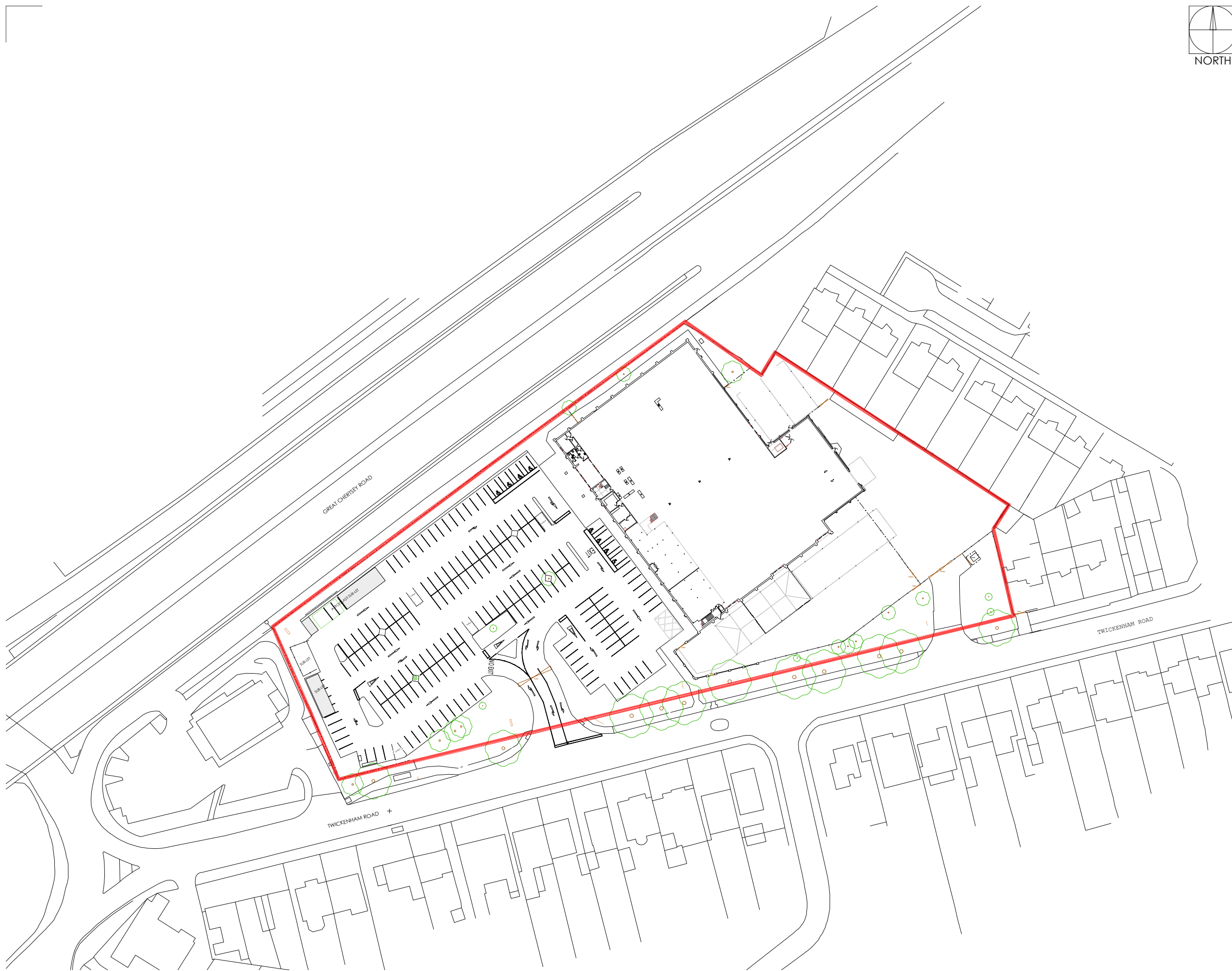

External Areas:

Site Area 14,086sqm/1.4086 hectares/ 3.48acres

184 Parking spaces inc 4 DDA, 4 P&C 2.4m x 4.8m
21 Additional Parking spaces occupied by sub let pods
3 Cycle spaces

Building:

Existing GEA	3391 sqm GEA
Existing GIA	3291 sqm GIA
Existing Mezzanine	480 sqm GIA



**Architecture
Masterplanning
Interior Design**

www.harrispartnership.com
Wakefield Manchester Milton Keynes Reading London Harrogate

Client

Aldi Stores Ltd



Project Title

**Proposed Retail Unit
Homebase Hanworth
Twickenham Road
Twickenham
Feltham, TW13 6EZ**

Drawing Title

Existing Site Plan

Drawn	Checked	Scale @A3	BIM Status	Date
HWG	IC	1:1000	NA	10/24

Drawing Status	Rev.	THP Project No
Planning		18960

Project No.	Originator	Volume	Level	Type	Role	Number
18960	THPK	00	XX	DR	A	0101