

Tree Work Schedule

No.	Species	Works	Category
2	Hollyhock Holly	Fell tree to ground level; remove stump	C.1

All tree work is to be undertaken in accordance with British Standard BS 3988:2010 Tree work - Recommendations. All arising's are to be removed and the site is to be left as found. Care is to be taken of the ground around retained trees to make sure that it does not become compacted as a result of tree surgery operations. No equipment or vehicles such as timber lorries, tractors, excavators or cranes shall be parked or driven beneath the crowns of any retained trees, to prevent subsequent compaction and root death.

Protective Fencing

To be erected prior to the commencement of all works on site, and retained in place throughout construction.
Default Specification: To comprise either 2.4m wooden site hoarding; or a 2.3m high scaffolding framework comprising of vertical and horizontal framework, well braced to resist impacts, with uprights to be spaced at a maximum of 3.0m intervals and driven into the ground by a minimum of 600mm. On to this, standard anti-climb welded mesh panels are to be securely fixed to each other with at least two scaffold clamps and to the scaffold framework with wire.
Secondary Specification: To comprise of 2m tall welded mesh panels on rubber or concrete feet. Panels are to be joined together using a minimum of two anti-lamper couplers, installed so that they can only be removed from inside the fence. The panels should be supported on the inner side by stabilizer struts, which should be attached to a base plate and secured with ground pins.
 All weather notices should be erected at regular intervals on the weld mesh panels with words such as "Construction exclusion zone - Keep out".

Arboricultural Supervision

The arboricultural consultant will be required to attend site to directly supervise all demolition and construction works that have to be undertaken within the root protection areas. This will include:
 1. Pre-commencement site meeting.
 2. Location of protective measures.
 3. Any demolition and/or excavations within or adjacent to RPAs, including foundations, hard surfacing or underground services (a non-exhaustive list).
 4. Arboricultural sign off and removal of protective measures.

Arboricultural Method Statement

Please refer to Arbttech Consulting Ltd. Tree Schedule and Arboricultural Method Statement, for full details on all surveyed trees and how all aspects of the the development may be implemented without detriment to retained trees.

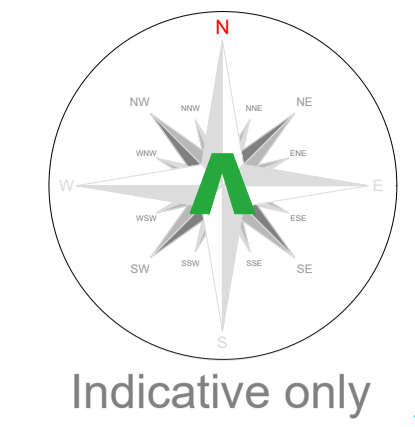

Tree Protection Area
KEEP OUT
 Do not move this fence

(TOWN & COUNTRY PLANNING ACT 1990)
 TREES ENCLOSED BY THIS FENCE ARE PROTECTED BY PLANNING CONDITIONS AND/OR ARE THE SUBJECT OF A TREE PRESERVATION ORDER. CONTRAVENTION OF A TREE PRESERVATION ORDER MAY LEAD TO CRIMINAL PROSECUTION.
 ANY INCURSION INTO THE PROTECTED AREA MUST BE WITH THE WRITTEN PERMISSION OF THE LOCAL PLANNING AUTHORITY

ARBTECH
Arbttech Consulting Limited
 Unit 3, Well House Barns, Chester Road, Chester, CH4 0DH
 https://arbttech.co.uk - 01244 661170

Note:
 No unauthorised excavations are to be carried out within the RPAs of any retained trees.
 Any level changes must form part of a construction method statement and must protect the rooting environment of all retained trees.

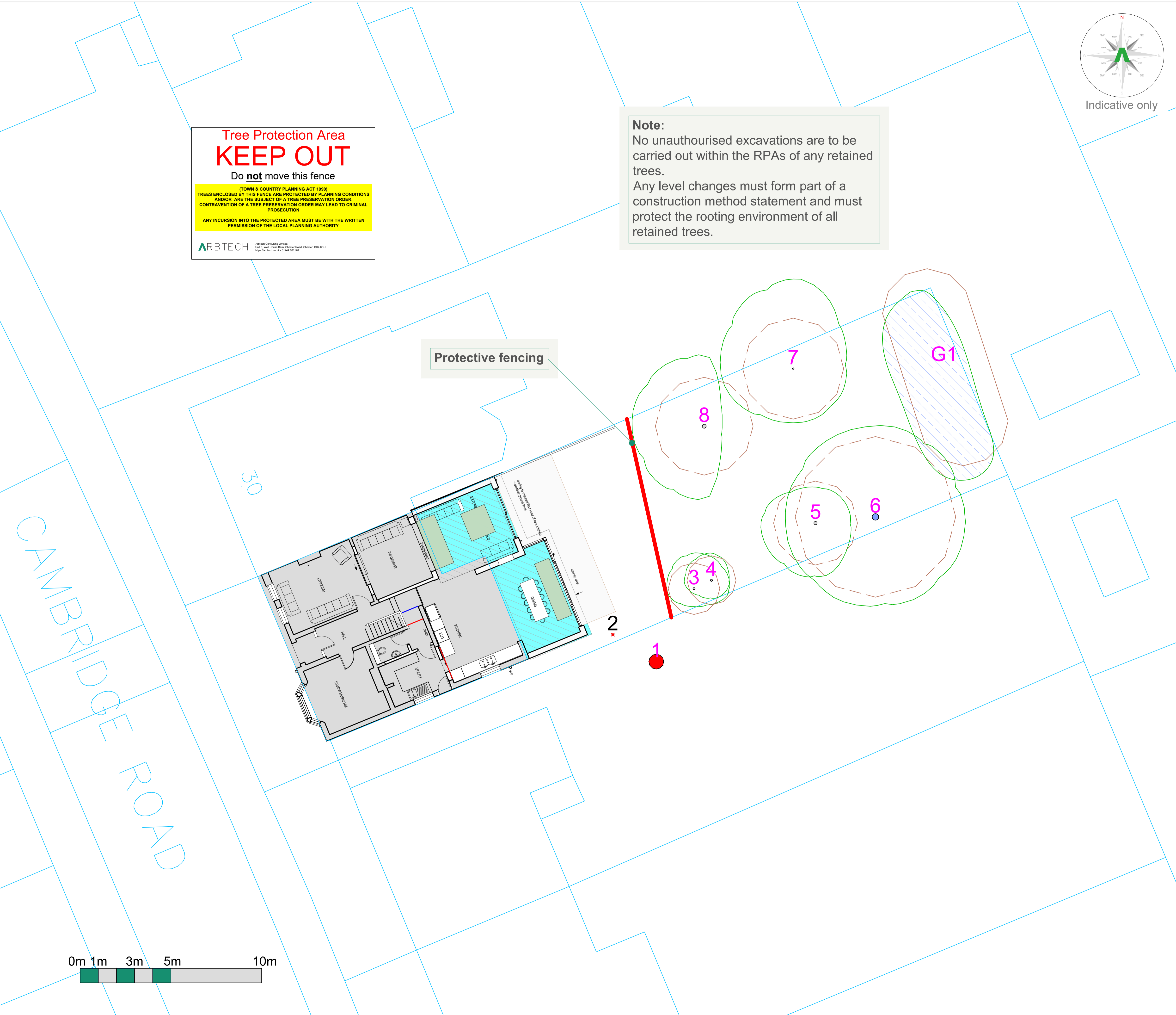

ARBTECH
 Unit 3, Well House Barns, Chester, CH4 0DH
 https://arbttech.co.uk, 01244 661170

Project: **28 Cambridge Road, Teddington, Middlesex, TW11 8DR**

Client: **Simon Pullinger**

Drawing: **Tree Protection Plan**

Based on: **1515-301-RevA**

Drawing No: **Arbttech TPP 01** Rev:

Date: **Jan 2020** Scale: **1:100 @ A1** Drawn: **DCG**

Key:	
Tree Nos.:	1
Tree Canopies:	(Green outline)
Trunks:	(Red dot)
RPAs:	(Dashed green circle)
Category 'U' trees:	(Red dot)
Category 'B' trees:	(Blue dot)
Category 'C' trees:	(Green dot)
Trees to be removed:	(Red dot with 'X')
Existing Structures:	(Grey fill)
Proposed Structures:	(Blue fill)
Protective fencing (Construction):	(Red line)
Protective fencing (Demolition):	(Blue line)
Protective fencing - Pedestrian:	(Green line)
Protective fencing - Tree boxes:	(Purple line)
Trunk protection:	(Red circle)
Goal posts:	(Blue line)
Ground boarding:	(Blue hatched)
Ground boarding (Construction):	(Red hatched)
Ground boarding (Demolition):	(Blue hatched)
Arboricultural supervision - Construction:	(Blue hatched)
Arboricultural supervision - Demolition:	(Blue hatched)
Arboricultural supervision - Excavations:	(Yellow hatched)
Arboricultural supervision - No Dig HS:	(Green hatched)
Trees for relocation:	(Green circle with 'X')
Site investh.:	(Orange hatched)
Planting locations:	(Green circle with 'X')

All dimensions should be checked on site. No dimensions are to be scaled from this drawing. Please notify us of any discrepancies found. Arbttech Consulting Ltd. cannot be held responsible for inaccuracies in the base drawing in which this plan is based.
 This drawing is designed to reflect the principles of the layout or design only, and relates only to the protection of retained trees.
 This drawing is not to be read as a definitive part of the engineering or construction design or method statement. An architect or structural engineer should be contacted over any matters of construction, detailing or specification and for any standards or regulatory requirements relating to proposed structures, hard surfacing or underground services.
 This drawing was produced in colour - a monochrome copy should not be relied upon.
 © Arbttech Consulting Ltd, 2020