



## Section Pictures - 28/10/2024 - TQ19766801X

Item No.	Inspection Direction	PLR	Client's Job Ref	Contractor's Job Ref
1	Downstream	TQ19766801X	49480	



TQ19766801\_D\_241028\_095218\_49480\_8.jpg, 00:07:41,  
70.22 m

General photograph taken at this point, Condition photo



TQ19766801\_D\_241028\_095218\_49480\_9.jpg, 00:08:42,  
80.07 m

General photograph taken at this point, Condition photo

## Curtis, Sam

---

**From:** James Mayfield <James.Mayfield@thameswater.co.uk>  
**Sent:** 07 November 2024 13:53  
**To:** McLean, Thomas; Curtis, Sam  
**Cc:** Coleman, Matthew; Nowak, Piotr; Guven, Irem  
**Subject:** Re: Kew - Line and level survey - X2039-1959

Hi Tom,

As mentioned below, Thames Water have no further comments on the survey which has been completed.

Kind regards,

**James Mayfield**

Senior Project Engineer – Developer Services, Major Projects

Mobile: 07747 642 662

[James.Mayfield@thameswater.co.uk](mailto:James.Mayfield@thameswater.co.uk)

Clearwater Court, Vastern Road, Reading, RG1 8DB



---

**From:** McLean, Thomas <Tom.McLean@wsp.com>  
**Sent:** 07 November 2024 13:44  
**To:** James Mayfield <James.Mayfield@thameswater.co.uk>; Curtis, Sam <samuel.curtis@wsp.com>  
**Cc:** Coleman, Matthew <Matthew.Coleman@wsp.com>; Nowak, Piotr <piotr.nowak@arcadis.com>; Guven, Irem <irem.guven@arcadis.com>  
**Subject:** RE: Kew - Line and level survey - X2039-1959

This e-mail originated from outside of Thames Water. Do not click links, open attachments or reply, unless you recognise the sender's e-mail address and know the content is safe. If in doubt, contact the Digital Service Desk. Report Phishing via the Report Message option.

Thanks James,

To confirm, Thames Water are satisfied that the extent of the condition survey can be taken as representative of the length of the sewer?

Thanks,  
Tom



**Thomas McLean**

Structural Engineer | Digital Design Specialist

T+ 44 20 3116 6075

**Confidential**

This message, including any document or file attached, is intended only for the addressee and may contain privileged and/or confidential information. Any other person is strictly prohibited from reading, using, disclosing or copying this message. If you have received this message in

# Appendix D

## **TRANSFER STRUCTURE DRAWINGS**





THIS DRAWING IS FOR CONTEXT ONLY FOR THE PURPOSE OF A THAMES WATER BUILD-OVER APPLICATION

DRAWING NO: 70119108 - REV: 01 - DATE: 27 JUN 2024 - PROJECT: KEW RIVERSIDE - SHEET: SW-XX-DR-S-0021 - SCALE: 1:100

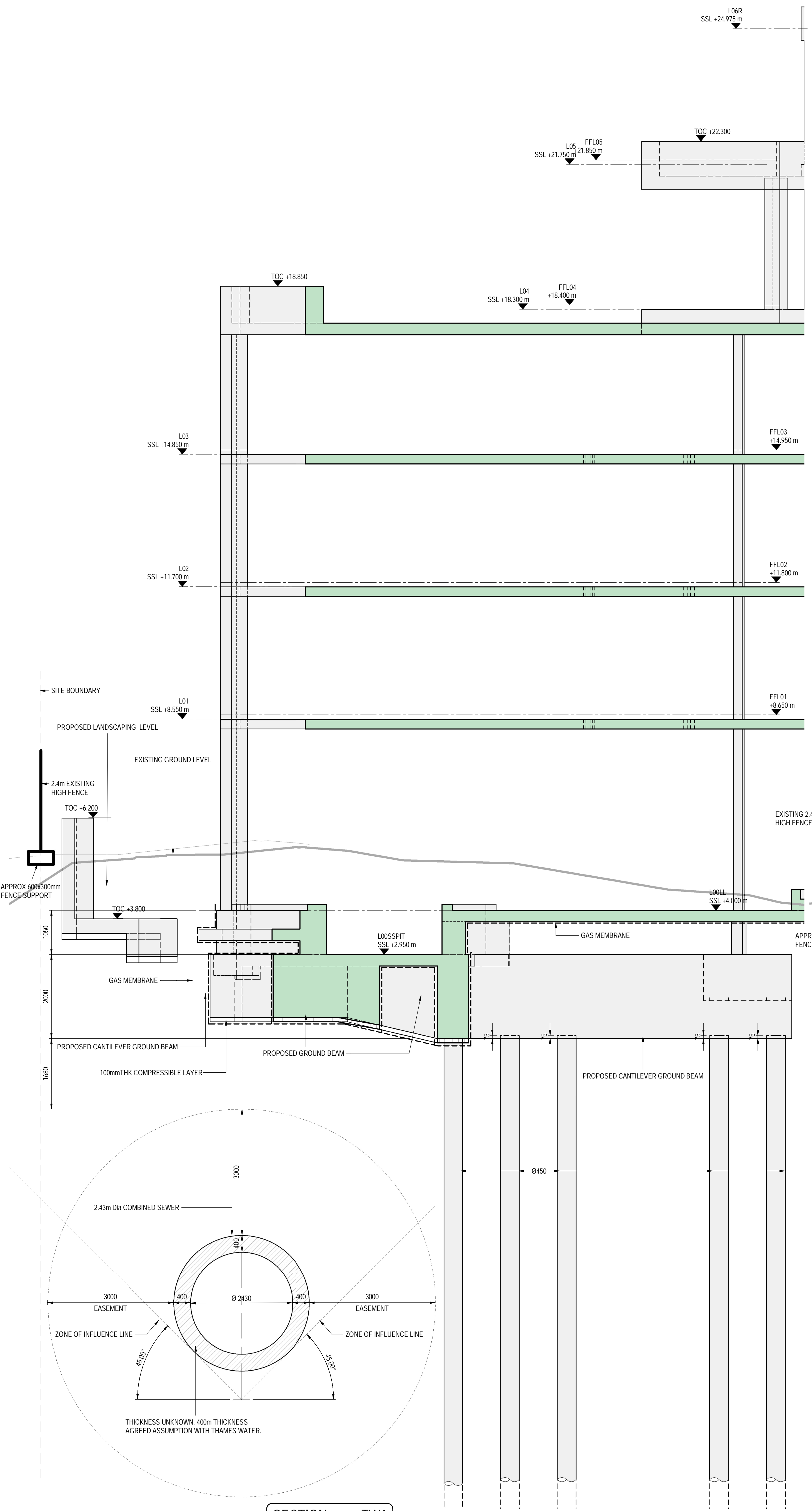

SECTION TW1  
SCALE 1:50

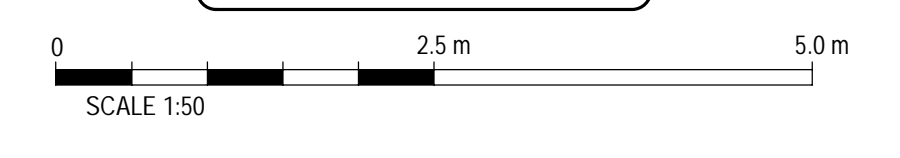

EXISTING SITE PLAN SHOWING THAMES WATER TUNNEL  
SCALE 1:500



PROPOSED SITE PLAN SHOWING THAMES WATER TUNNEL  
SCALE 1:500

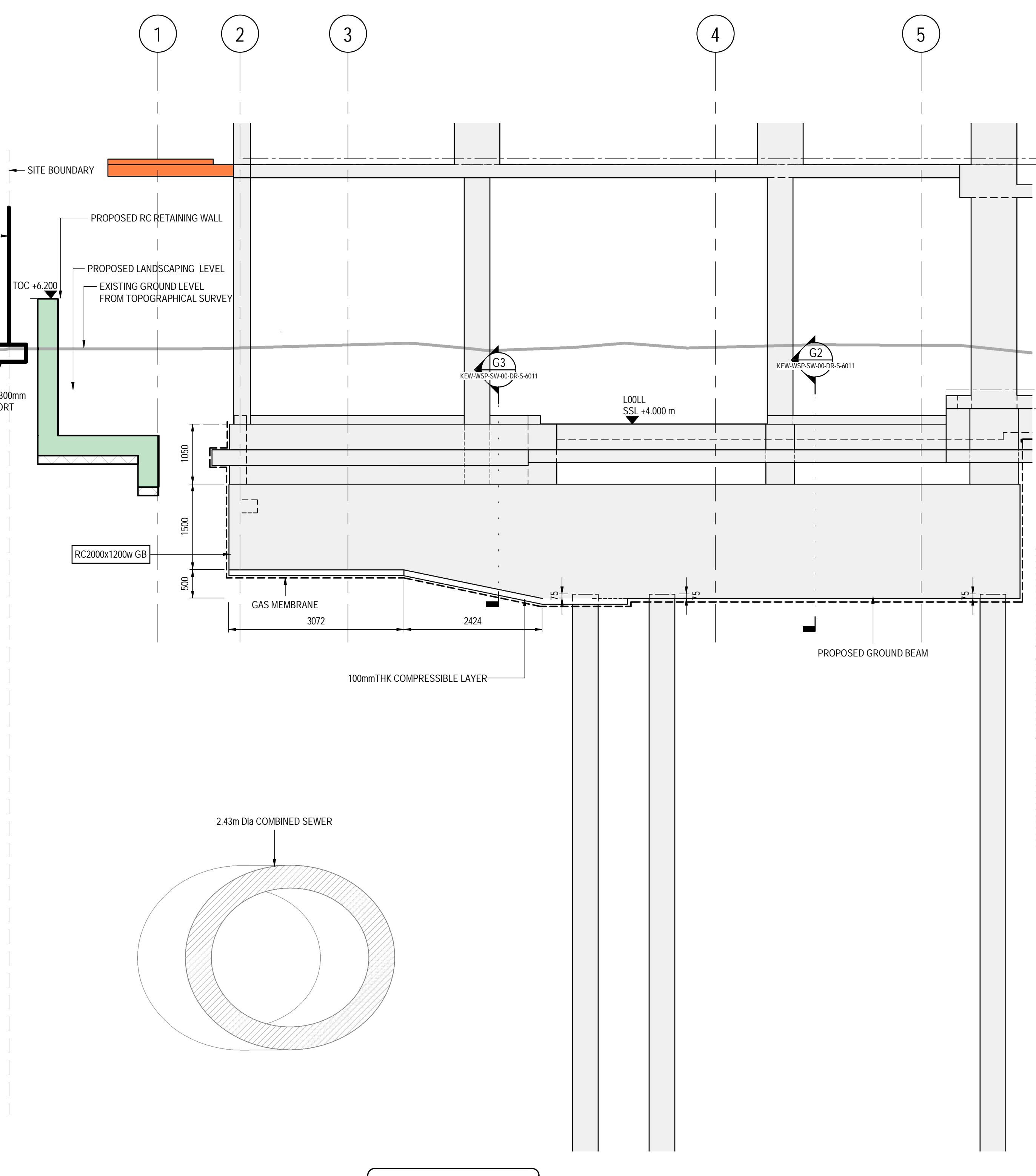

SECTION TW2  
SCALE 1:50

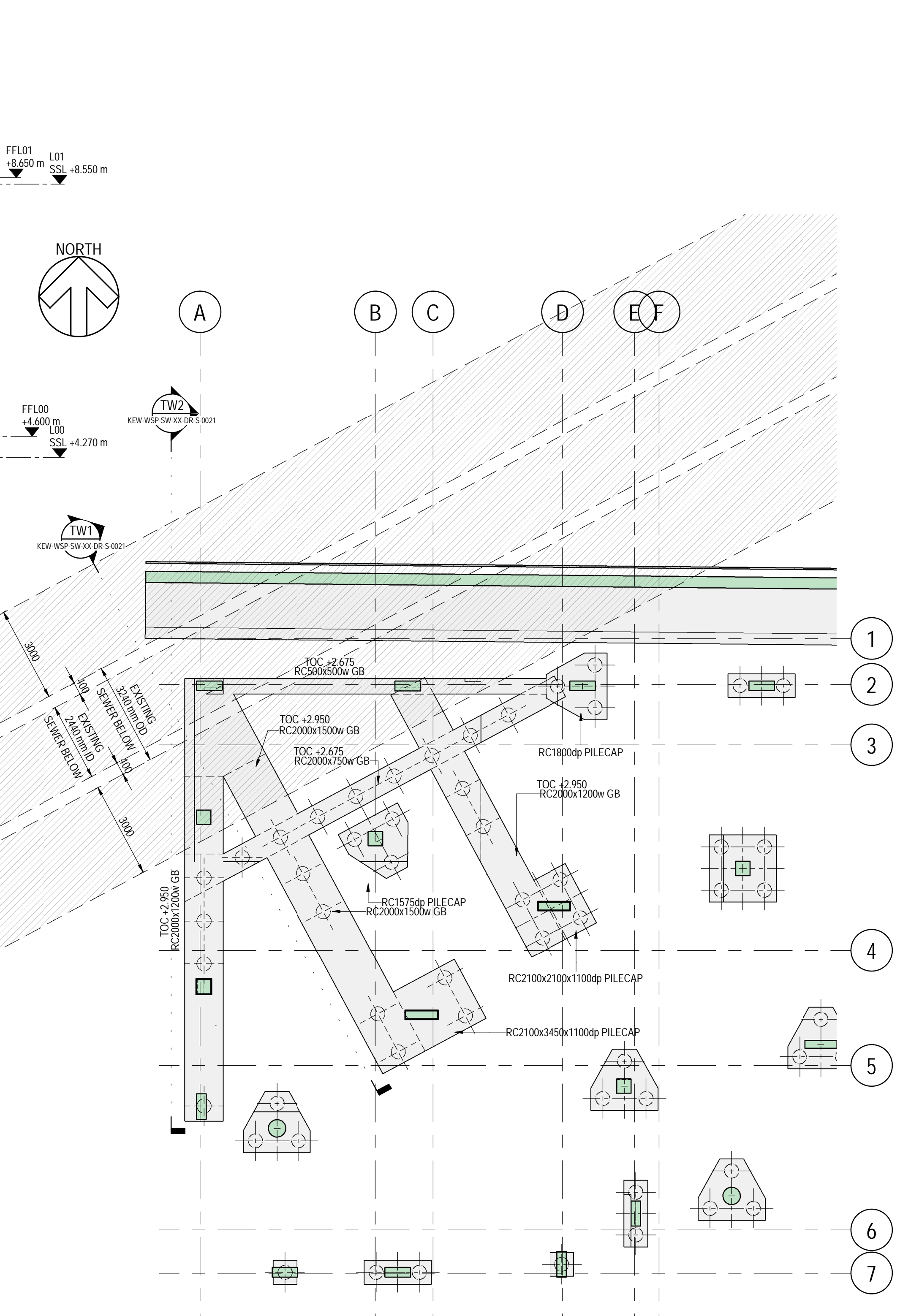
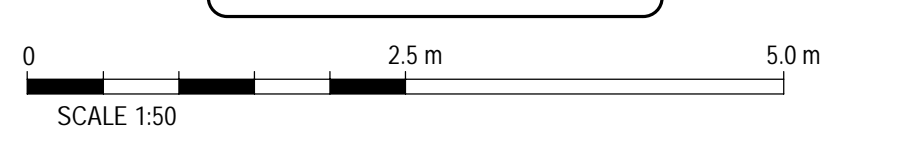

A - FOUNDATION PART PLAN  
SCALE 1:100

INFORMATION			
WSP House, 70 Chancery Lane, London WC2A 1AF Tel: +44 20 7314 5000 Fax: +44 20 7314 5111 http://www.wsp.com			
CLIENT:	KEW UNIT TRUST		
ARCHITECT:	COLLADO COLLINS ARCHITECTS		
PROJECT:	KEW RIVERSIDE		
TITLE:	THAMES WATER TUNNEL BUILD-OVER		
SCALE: DRAWING	1:250	1:50	
DESIGNED:	SC	DR	MC
DRAWN:	SC	TRC	27 JUN 2024
CHECKED:	SC	TRC	
DATE:			
DESCRIPTION:			
DRAWING NO:	KEW-WSP-SW-XX-DR-S-0021		REV: P2
© WSP UK Ltd			



# Appendix E

## **FRANKI PILING METHOD STATEMENT**

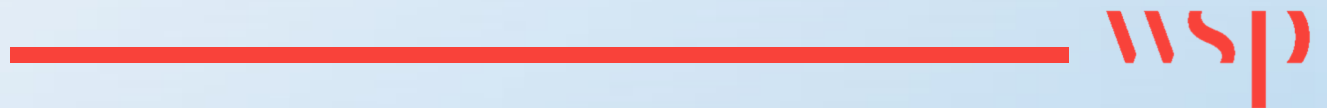

## GROUP METHOD STATEMENT

### CFA Piling for Kew Riverside

Acceptance by Group						Acceptance by Main Contractor	
Submittal History	Date:	Prepared by:	Checked by:	Approved by:	Description of modifications:	Accepted by	Date:
DRAFT	6.1124	K Herbert	D Hall	D Hall	Comments and approval		

**Comments**

## Method Statement for: SR30

### Piling Operation: CFA

<b>Contract No:</b>	F24405
<b>Contractor:</b>	CPC Project Services
<b>Site Address:</b>	Melliss Avenue, Richmond, TW9 4BD
<b>Project Manager:</b>	Tbc
<b>Normal Working Hours:</b>	0800-1800
<b>Project Type:</b>	CFA Bearing piles
<b>No of Piles:</b>	301
<b>Pile Diameter:</b>	300, 350 and 400mm
<b>Contract Start Date</b>	Tbc



## CONTENTS

1.	SCOPE OF WORK .....	4
2.	PROGRAMME.....	5
3.	RESPONSIBLE PERSONS WITHIN GROUP .....	5
4.	SITE LOCATION AND ACCESS.....	6
5.	PLANT AND MACHINERY MOVEMENTS.....	6
6.	PILING PLATFORM REQUIREMENTS.....	6
7.	EXISTING SERVICES .....	7
8.	EMERGENCY ARRANGEMENTS .....	7
9.	HEALTH & SAFETY .....	8
10.	SITE OPERATIVES/TRAINING .....	9
11.	SUPPLIED PLANT & EQUIPMENT .....	9
12.	FRANKI FOUNDATIONS UK GROUP REQUIREMENTS .....	10
13.	METHODOLOGY .....	10
14.	ENVIRONMENTAL .....	11
15.	QUALITY CONTROLS.....	12
16.	EMPLOYEES CONFIRMATION .....	13



## 1. Scope of Work

The proposed work is the construction of 301nr CFA piles for the project. The piles are 300, 350 and 400mm in diameter and will be constructed using the CFA piling technique outlined in the following method statement and associated task briefings. As part of the work 3nr test piles will be completed.

The piles will be constructed using Soilmec SR30 piling rig or similar.

Pile Layout and diameter breakdown ;

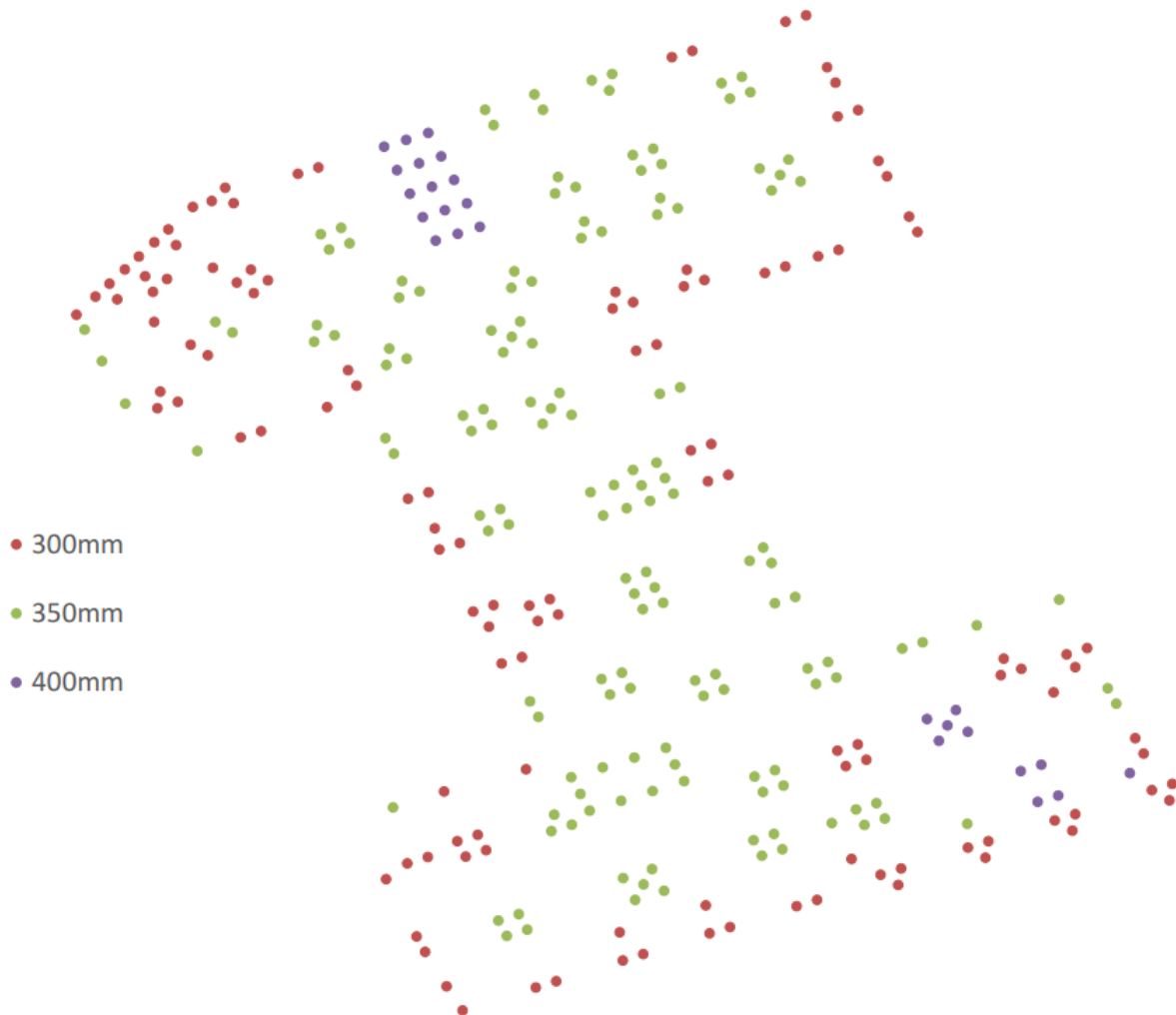

## 2. Programme

The start date for the project is programmed for tbc and will be completed in one visit. The works are expected to take approximately 6 weeks not including the follow-on testing.

## 3. Responsible Persons within Group

Position	Responsibilities	Contact	Contact Details
Group Managing Director	Director of Health & Safety at Franki Foundations UK Group to implement, coordinate and control the administration of Health and Safety matters within the company	Craig Macklin	01322 479000 craig.macklin@frankifoundations.co.uk
Group Operations Director	Director of contracts and new developments, control all Operational matters within the company	Alan Turner	01322 479000 07917 186 160 alan.turner@martellopiling.com
Group Health & Safety Manager	To monitor, control and correct the H&S actions of all employees and others under his jurisdiction to ensure H&S is prioritised and that the company's H&S Policy is fully understood/ implemented. To investigate accidents, incidents and near misses		
Contracts Manager	To manage all contracts and ensure that any new developments are communicated both quickly and effectively to all company staff.	Kieran Herbert	01322 479000 07972 870 780 kieran.herbert@franki.uk
Contracts Manager	To manage all contracts and ensure that any new developments are communicated both quickly and effectively to all company staff.	Jason Melton	01322 479000 07741 247 557 jason.melton@frankifoundations.co.uk
Operations Manager	To manage Operational matters within the company.	David Hall	01322 479000 07741 644112 David.hall@frankifoundations.co.uk
Contracts Manager	To manage all contracts and ensure that any new developments are communicated both quickly and effectively to all company staff.	Jim Moore	01322 479000 07584 026 865 Jim.moore@frankifoundations.co.uk
Foreman /Supervisor	To ensure all operations on site are carried out in a safe manner To manage Site Staff within the groups legal requirements, policies, works program. groups Site FIRST AIDER	Tbc	Tbc

## 5. Site Location and Access

The site gates and boundaries will be maintained and operated by the Main Contractor, the boundary will be formed of site hoarding or line Herras fencing and will be suitable to prevent unauthorised access by the public.

The piling rig will access the site via the designated site entrance along with all other plant and material deliveries. All piling operatives will access the site through the designated pedestrian entrance and make their way to the Main Contractors office where site inductions will be held on the first day.

Site Address –



## 6. Plant and Machinery Movements

All plant and vehicle movements will be under the control of a vehicle marshal or banksman. Exclusion zones around plant must be enforced along with plant and pedestrian segregation by means of barriers.

## 7. Piling Platform Requirements

The main contractor is responsible for providing the rig and crew with a firm and level piling platform as specified within the piling platform design document.

The piling platform must be installed and maintained throughout the piling works as per the design document and signed off on the FPS working platform certificate. The piling mat will be inspected weekly by Franki and the Main contractor to confirm acceptance and at any intervals between deemed necessary if repairs need to be or have been undertaken.



Clear marking of the platform boundaries must be in place on the piling platform to ensure the rig does not track onto areas that are not installed as per the design. The piling platform should be installed a minimum of 2M past the furthest pile positions on all sides.

The rig must not be stood up until the working platform certificate has been signed by the Main Contractor.

## 8. Existing Services

The main contractor must carry out all necessary inspections for existing services and probe for existing substructures in line with HSE ACOP HSG47. These areas are to be removed or clearly marked prior to the commencement of any piling works. All efforts must be made by the Main Contractor to isolate any services near the piling works.

If piling works are to be carried out near existing services, they must be exposed and protected to ensure the piling works do not affect the service in any way. It is noted on the drawings that there are services that have a no track zone, this will be demarked on site.

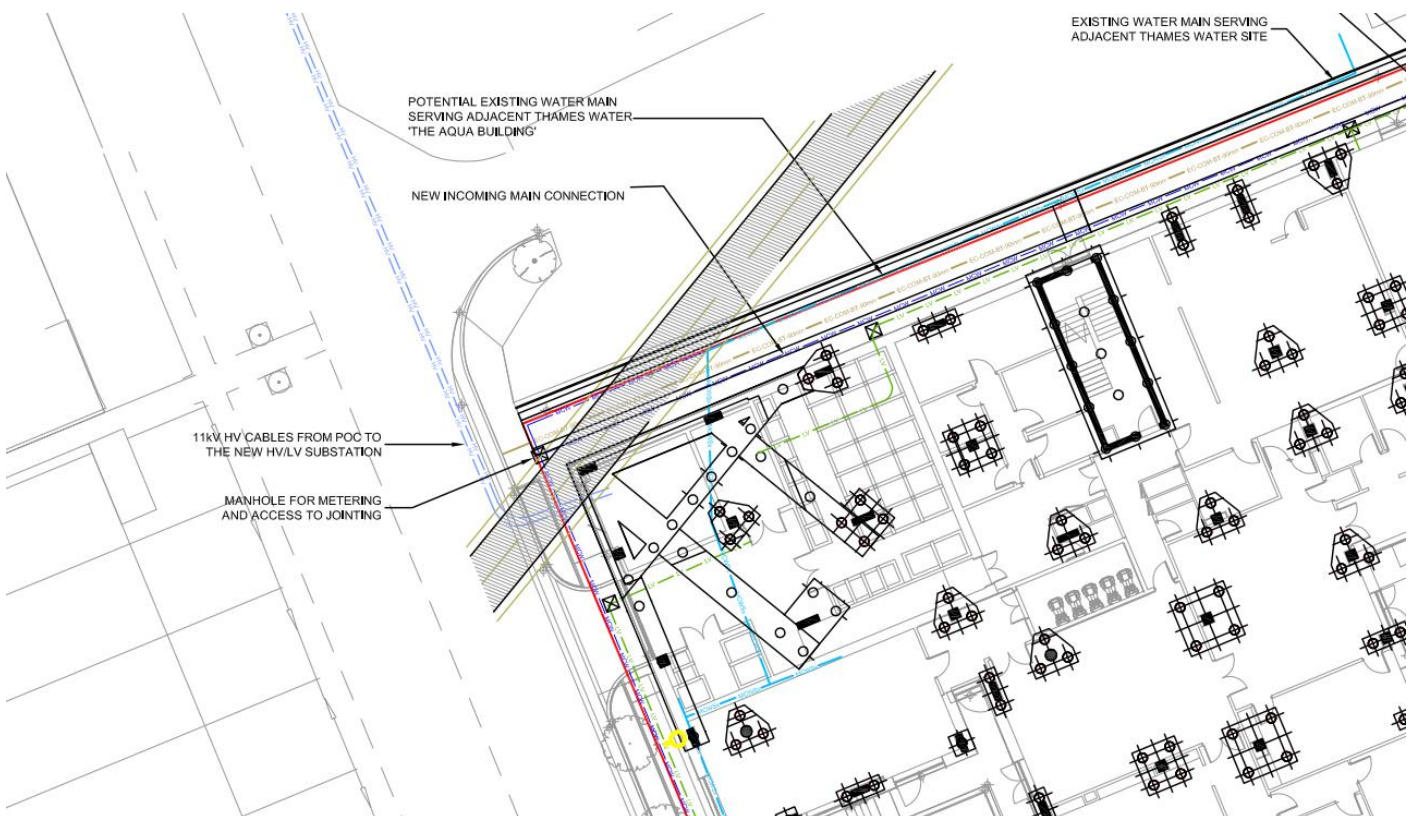

A permit to dig must be issued and signed by the main contractor prior to piling that highlights any services that may affect the work and any additional control measures that may need to be taken.

## 9. Emergency Arrangements

In the event of an emergency, works are to stop immediately & be made safe. If necessary, contact the emergency services (999). Notify site manager/supervisor.

If a fire is discovered, raise the alarm and evacuate the site as per the fire plan.



The nearest hospital is:

West Middlesex University Hospital,  
Twickenham Rd,  
Middlesex  
TW7 6AF

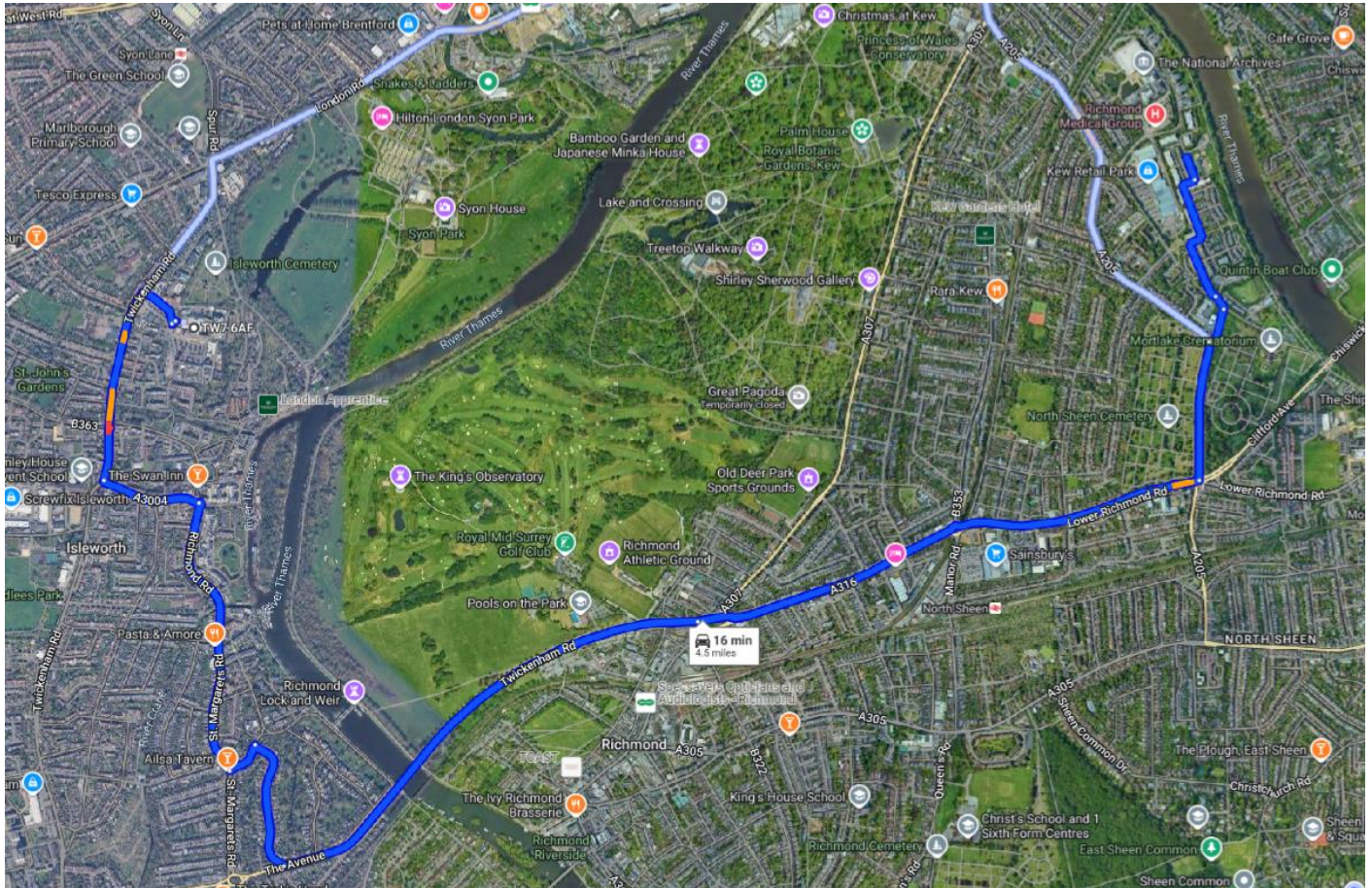

The Rig Driver/Site Supervisor is the person in control of the works at site level. Should any problems arise beyond his authority, the contracts manager or operations manager should be contacted.

## 10. Health & Safety

The Groups employees will always operate in a safe and diligent manner in accordance with their Health & Safety Policy. They will work in accordance with the method statement and risk assessment at all times.

Personnel Protective Equipment will be worn at all times whilst on site the company's minimum requirement is: Hard Hat, Safety Boots, Safety Glasses, Gloves and Hi-Viz Vest or Jacket. Additional Personnel Protective Equipment will be worn for site specific work as required by the risk assessment i.e. Overalls and Ear Defenders.

Health & Safety is monitored daily by the construction Manager and any incidents, accidents or near misses are investigated promptly. All employees are encouraged to report any accidents,



incidents or near misses to the construction manager.

Site Inspections are carried out monthly; any findings are passed on to the relevant managers to act.

The group has a Safety, Quality & Environmental Committee which meets weekly to discuss issues arising.

All Group site employees will undertake the Main contractor site induction before commencing work on site.

## 11. Site Operatives/Training

The following labour is envisaged for the piling operations of this project:

Site Personnel	Competence	Quantity
Foreman/Rig Driver (Certified Rig Operator)	SSSTS / CPCS rig operative bored above 15 tonnes	1
Banksman (Certified Banksman / Slinger)	CPCS Slinger Signaller	1
Pumpman	CPCS card holder	1
Excavator Operator C/O The Main Contractor	CPCS excavator operative with lift and carry	1
Steel Fixer	CSCS	1

No Group employee is to use equipment for which they have not been trained and authorised by Franki Foundations UK Group Management.

## 12. Supplied Plant & Equipment

Franki Foundation UK Group will supply the plant and equipment below for the contract.

Item	Quantity
Soilmec SF 30 CFA piling rig or similar	1
Excavator C/O The Main Contractor	1
Concrete trailer pump and equipment	1
Double tool compressor and hose	1
Piling Job Box / tool box	1
Delivery trucks/vans	As required





All plant and equipment will be certified tested and maintained in accordance to PEWER 98 and where applicable LOLER 98.

All lifting gear will be certified, tested and maintained in accordance with LOLER 98.

### **13. Franki Foundations UK Group Requirements**

1. The Main Contractor will provide the following:
2. The nearest accident and emergency hospital together with direction is to be provided to site operatives during the site induction by the Principal Contractor. (Indicated in the Construction Phase Plan).
3. The Principal Contractor will provide first aid facilities as required. Franki Foundations UK Group personnel will be made aware of the identity and location of these facilities during the site induction.
4. Identification, excavation and or protection of all services chartered or un-chartered) within the site access route and the site area. These include but not limited to electricity, water, telecoms, gas, and sewerage.
5. Protection / excavation and capping of all ducts, pipes, channels, culverts, and sewers to prevent damage and loss of concrete.
6. Protection to adjacent buildings, pathways, highways from spoil, concrete slurry and bore spoil debris.
7. Provision of service drawings relevant to pile locations). Identification and maintenance of service locations and easements zones on site.
8. The principal contractor will provide a permit to pile, confirming pile positions are clear of all site services (chartered or un-chartered) .
9. All work areas to be segregated.
10. Health & Safety requirements and welfare facilities with accordance to the CDM 2015 regulations.
11. An attendant 360 Tracked Excavator [Minimum 13 Tonne] & Qualified Driver to be always in 100% attendance.
12. Install and maintain the working platform when required.
13. To protect the public from the piling works.
14. To provide mains water to the Group foundations holding drum.

### **14. Methodology**