

KEY:

-  EXISTING
-  PROPOSED

Note: Surrounding buildings and levels are indicative only, carried out from a visual survey

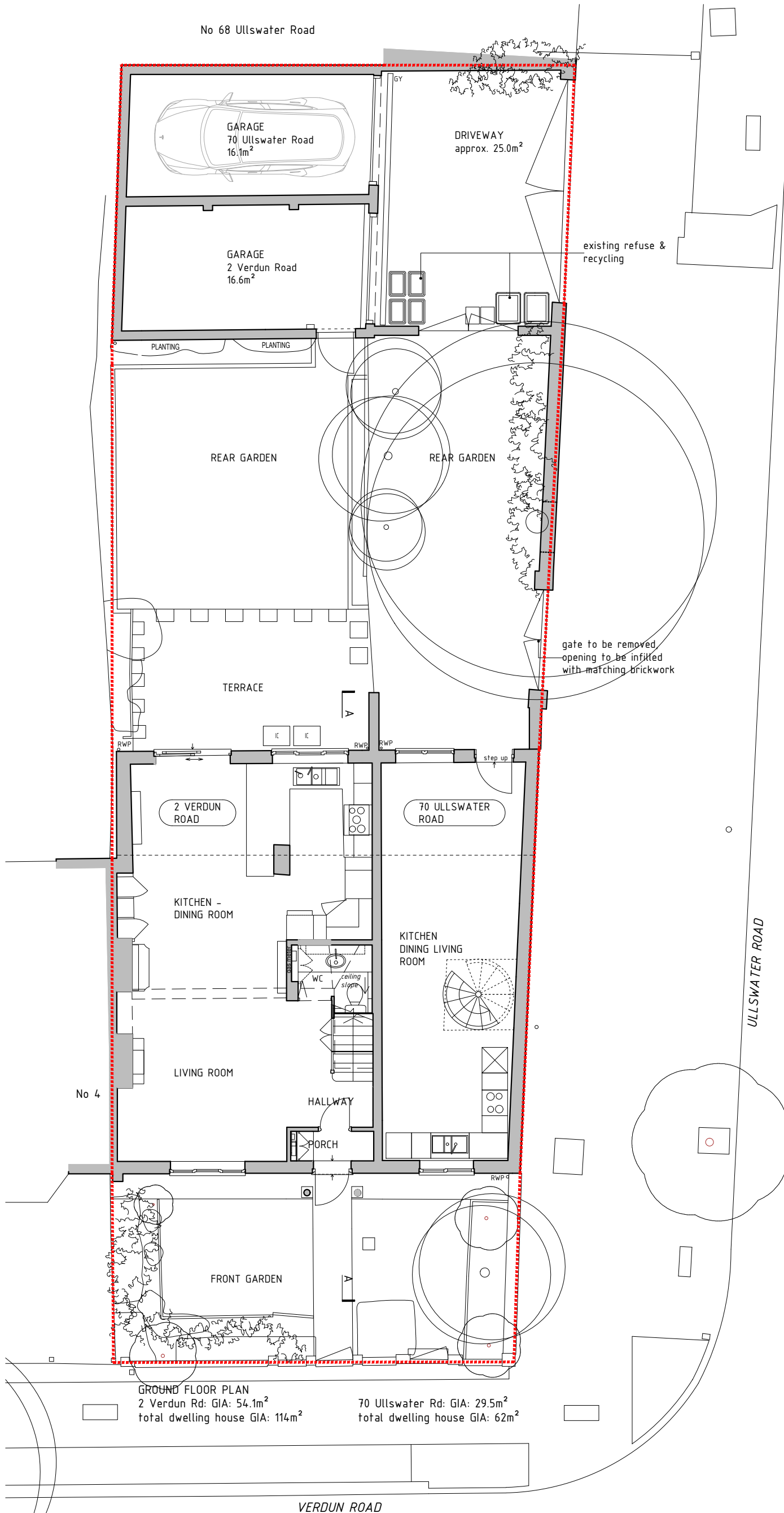

GROUND FLOOR PLAN
 2 Verdun Rd: GIA: 54.1m²
 total dwelling house GIA: 114m²

70 Ullswater Rd: GIA: 29.5m²
 total dwelling house GIA: 62m²

revisions	
project	2 VERDUN ROAD, SW13
drawing name	EXISTING GROUND FLOOR PLAN
client	JASPREET NARANG
drawing number	2VR_P001
scale	date
1:100 @ A3	13 11 2024
status	
PLANNING	

deUNIT

info@de-unif.co.uk www.de-unif.co.uk
 copyright © deUNIT - all rights reserved

note: do not scale from this drawing, all dimensions, levels and areas to be checked and confirmed on site, the architect to be notified of any discrepancies