

A-A

- KEY**
- EXISTING CONCRETE STRUCTURE
 - EXISTING SECOND FLOOR PARTITIONS
 - NEW SECOND FLOOR PARTITIONS
 - NEW ROOF STRUCTURAL TIMBERS

PROPOSED SERVICES PLATFORM COMPRISES 2230x60mm STEICO UNIVERSAL SARKING BOARDS (HIGHLIGHTED IN RED) ON ex50x225 S/W CEILING JOISTS AT 400c/c SPANNING BETWEEN ex75x225mm S/W TRIMMERS SUPPORTED ABOVE EXISTING TIMBER & CONCRETE MAIN STRUCTURE TO STRUCTURAL ENGINEERS DESIGN. FOR PROPOSED SECTION PLEASE REFER TO BHA DRAWING Sk913

ex50x225 S/W CEILING JOISTS AT 400c/c
ex75x225mm S/W TRIMMERS

01 Sk913

B-B

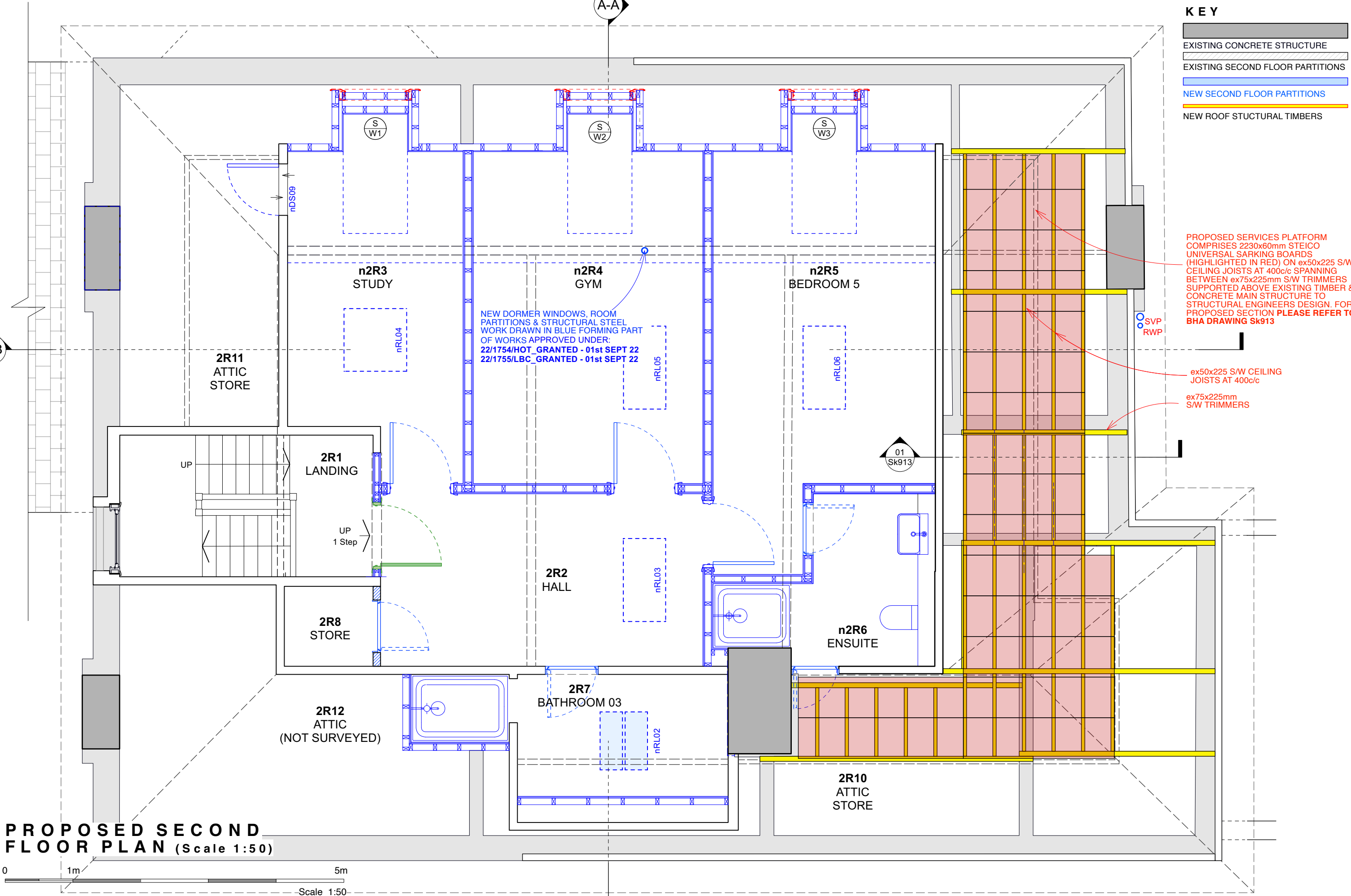

PROPOSED SECOND FLOOR PLAN (Scale 1:50)



Butler Hegarty Architects
Unit 3.3, Islington Studios, 159-163 Marlborough Road, London, N19 4NF
tel: 020 72638933 email: mail@butlerhegartyarchitects.co.uk

LISTED BUILDING CONSENT AND PLANNING APPROVAL ISSUE

16 St. Peters Road
Title: Proposed Second Floor Plan.
Drawing No: 0822522-Sk909

Scale 1:50 @ A3