



Date _____
Revision _____



MARGUERITE MURDOCH ARCHITECTS

The Boathouse Design Studio

27 Ferry Road, Teddington, TW11 9NN

M: +44 (0) 7739048710

T: +44 (0) 20 8943 9031

E: info@mmurdocharchitects.co.uk

www.mmurdocharchitects.co.uk

Do not scale

All dimensions in millimetres unless otherwise stated.

Any variations or supplementary drawings are to be approved by the Architect.

ALL DIMENSIONS AND CONDITIONS ARE TO BE CHECKED ON SITE PRIOR TO PREPARING DRAWINGS OR COMMENCING ANY WORK.

Magnetic Media does not constitute contract documentation and update of this data will occur. These files are current as of the date of issue. Your use of the content of these files is at your own risk. Reference should always be made to the hard copy which is superior to the digital format. Any documents produced by yourselves which contain part or all of this data remains your responsibility and is attributed to yourselves. Whilst every effort has been made to ensure that this file has been scanned for viruses, we cannot ensure that it does not contain any.

Status **PLANNING**

Project
**44 RIPLEY ROAD
HAMPTON
TW12 2JH**

Drawing description
PROPOSED SITE PLAN

Local Authority
LONDON BOROUGH OF RICHMOND UPON THAMES

Client
MR I KERSHAW & MRS K KERSHAW

Scale 1:200@A3 Date NOVEMBER 2024

CAD drawn Checked
MMM

Job Number Drawing Number
22-002 PL-003

Revision

© 2006, Marguerite Murdoch Architects

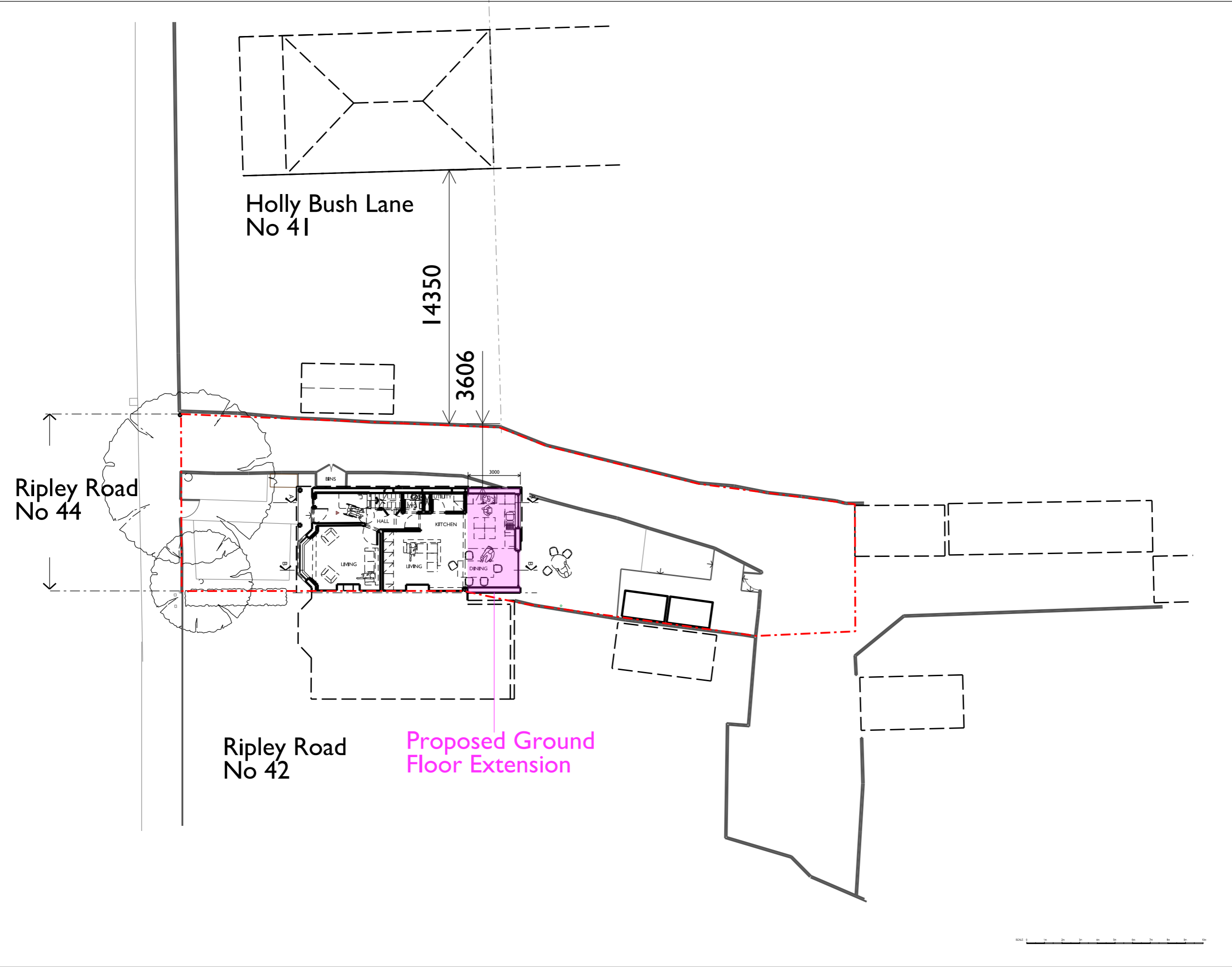

Proposed Ground Floor Extension

Ripley Road No 42

Ripley Road No 44

Holly Bush Lane No 41