

IF JULIET BALCONY IS PROPOSED, PROVIDE BALUSTRADES TO BALCONY MIN 1100MM IN HEIGHT AND CAPABLE OF RESISTING AT LEAST THE HORIZONTAL FORCE GIVEN IN BS 6180:2011. NO OPENINGS IN ANY BALUSTRADING SHOULD ALLOW THE PASSAGE OF A 100MM SPHERE AND CHILDREN SHOULD NOT READILY BE ABLE TO CLIMB THE GUARDING.

DORMER CHEEK WITHIN 1M OF BOUNDARY TO BE LINED WITH SUPALUX BOARD OR EQUIVALENT

UPGRADE EXISTING PARTY WALL WITH 77.5mm KINGSPAN KOOLTHERM K18 INSULATED DRY LINING BOARD & 5mm SKIM COAT TO ATTAIN 'U' VALUE OF 0.3W/m²K.

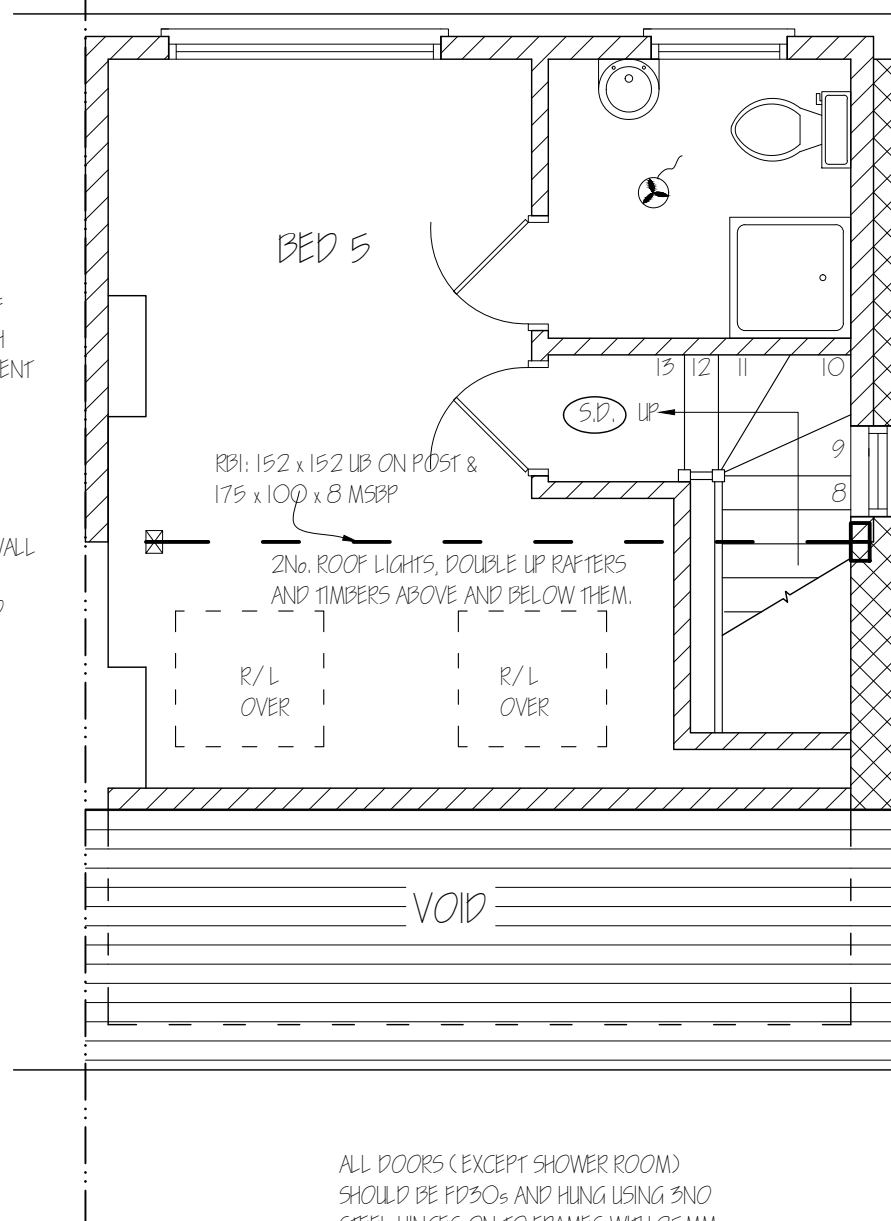

CONNECT 38Ø SHOWER, 32Ø BASIN & 100Ø W.C. BRANCH TO S.V.P. EXTEND S.V.P. TO BE 900mm ABOVE OPENABLE WINDOW.

USE 12.5mm PLASTERBOARD IN PARTITION AROUND STAIRS

GABLE WALL BUILT UP IN 225 THERMALITE 'TURBO' BLOCKWORK & 77.5MM KINGSPAN KOOLTHERM K18 DRY LINING BOARD.

ALL DOORS (EXCEPT SHOWER ROOM) SHOULD BE FD30s AND HUNG USING 3NO STEEL HINGES ON TO FRAMES WITH 25MM DOOR STOPS.

Nigel Fallon, B.Sc. (Hons) MBEng. 07768-408525
 Planning & Development Consultant, Building Engineer.
 164 Japonica Lane,
 Willen Park,
 Milton Keynes, MK15 9EE.

ADDRESS:
 7, RINGWOOD WAY,
 HAMPTON HILL, TWIZ IAT.

DRAWING TITLE: PROPOSED SECOND FLOOR PLAN

NO. - 06

REV:

SCALE - 1:100

DATE: 01/12/2024

DRG. PAPER SIZE: A3

