

770L INTERNAL REFUSE BIN

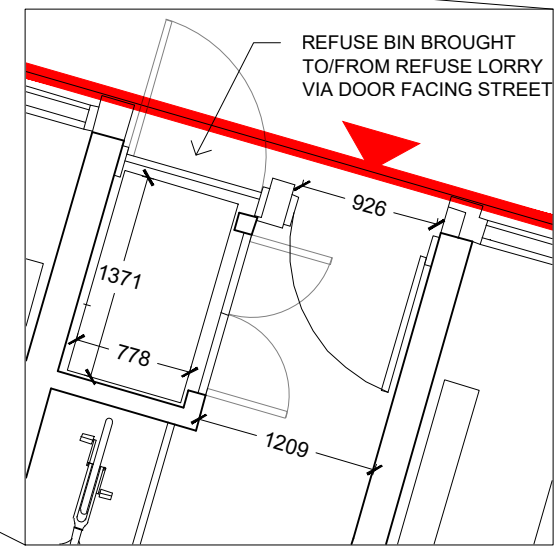
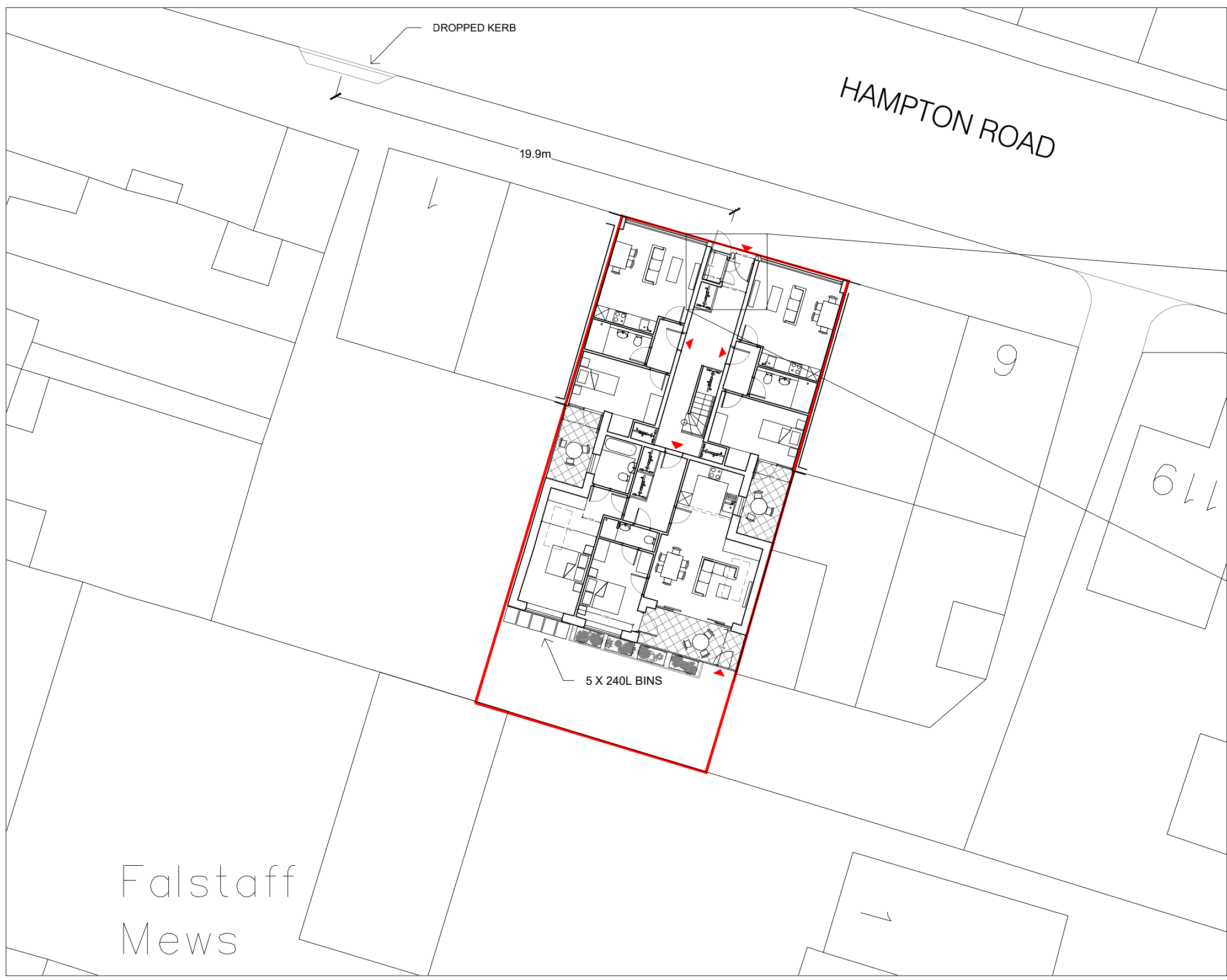

INTERNAL REFUSE BIN LOCATION
DOUBLE DOOR ACCESS WITH FOB CONTROL
FIRE DOORS WITH SMOKE SEALS/OVERHEAD CLOSER

BIN REQUIREMENT (SPD 2022)
 7 x 30L plus 8 x 70L = 770L REFUSE
 7 x 55L = 385L RECYCLING
 7 x 55 = 385L PAPER/CARD
 7 23 = 161L FOOD WASTE

TOTAL BINS PROVIDED
 1 x 770L REFUSE (INTERNAL)
 2 X 240L = 480L RECYCLING
 2 X 240L = 480L PAPER/CARD
 1 X 240L FOOD WASTE

Falstaff
Mews

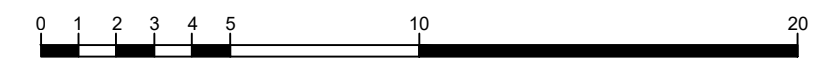

<small>All dimensions to be checked on site prior to construction or manufacture. Refer also to written specification of works where applicable. No dimensions should be scaled from this drawing for construction purposes. Any discrepancies found between this drawing and other drawings should be referred to consultants immediately.</small> <small>This drawing is the property of Mark Smith Architects Limited. Copyright is reserved. This drawing is issued on the condition that it is not retained by any unauthorised person. It may not be reproduced or disclosed or used, either wholly or in part without written consent of Mark Smith Architects Limited.</small>			PROJECT New Broadway/ Hampton Road		DRAWING Proposed Site Plan		STATUS PLANNING		Mark Smith Architects Limited
			CLIENT	SCALE 1:200 @ A3	DATE JUNE 2023	CHECKED MS	DRAWING No. 2103_PL.05_100	REVISION C	
REV	AMENDMENTS	DATE							