

notes

CDM Regulations 2015

- The contractor is responsible for checking dimensions, tolerances and references. Any discrepancy to be verified with the Architect before proceeding with the works.
- Where an item is covered by drawings to different scales the larger scale is to be worked to.
- Do not scale drawing. Figured dimensions to be worked to in all cases.
- The drawing information must be read in conjunction with all relevant scheme drawings, TECHNICAL NOTES drawings, specification and/or schedules referred to or not.
- True line of boundary and ownership to be established on site. Red line boundary extent to be confirmed by client.

ALL current drawings and specifications for the project must be read in conjunction with the Designer's Hazard and Environmental Assessment Record & Construction Phase Plan. Client to comply with CDM 2015 duties.

CDM 2015

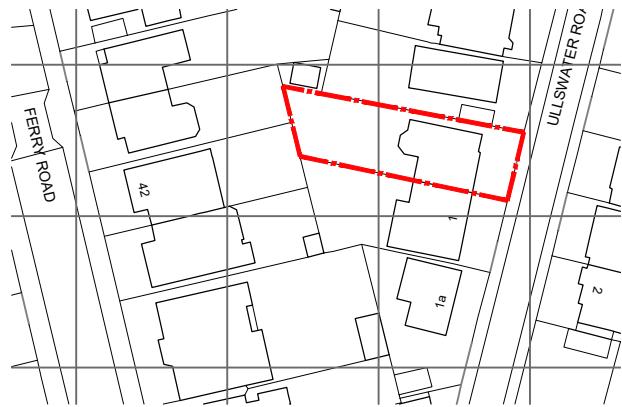

SITE LOCATION PLAN sc 1:1250

© Crown copyright 2024 Ordnance Survey 100053143

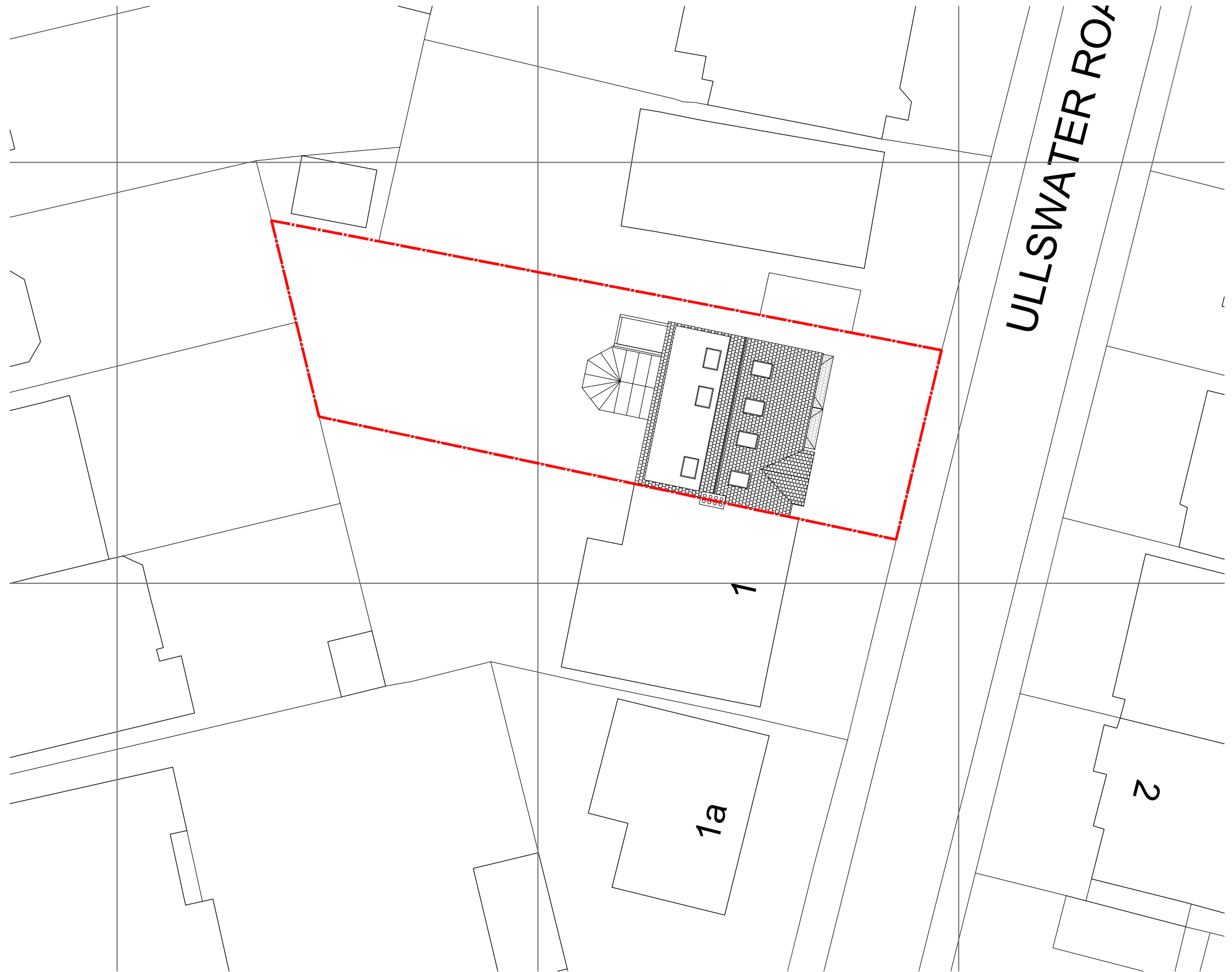

PROPOSED BLOCK PLAN sc 1:250

date 26.11.2024	rev A	revision/author/checker Enlarged dormer & material change	drawn SO	project 3 Ullswater Road SW13 9PL	purpose of issue PLANNING	drawing no U3_00	rev A	TW10 architects Richmond son@tw10architects.com 07568184305
			scale @ A3 NOTED					
			date 09.08.2024					