

BEAM SCHEDULE	
BEAM B1	120x80x8 RHS LAID FLAT (GALVANIZED)



INDICATES LOCATION OF TRIAL PIT TO ASSESS THE EXISTING RETAINING WALL FOUNDATION FORMATION LEVEL

*

ALLOWANCE IS TO BE MADE FOR THE BEAM TO BE ENCASED IN CONCRETE SLAB. TO BE CONFIRMED FOLLOWING THE COMPLETION OF TRIAL PIT

LEGEND	
	EXISTING STRUCTURE
	STRUCTURE UNDER
	WALL REMOVED
	PROPOSED BLOCK WALL
	PROPOSED BRICK WALL
	PROPOSED TIMBER PARTITION
	PROPOSED PADSTONE
	PROPOSED CONCRETE WALL
HD	HOLDING DOWN STRAP
RS	RESTRAINT STRAP
DJ	DOUBLE JOISTS BOLTED TOGETHER USING M12 BOLTS AT 300c/c
	EXISTING JOISTS SPAN DIRECTION
	MEMBER CANTILEVER PAST SUPPORT
	PROPOSED CAVITY WALL
F	FURFIX WALL STARTER SYSTEM
SJ	SHRINKAGE JOINT
EJ	EXPANSION JOINT

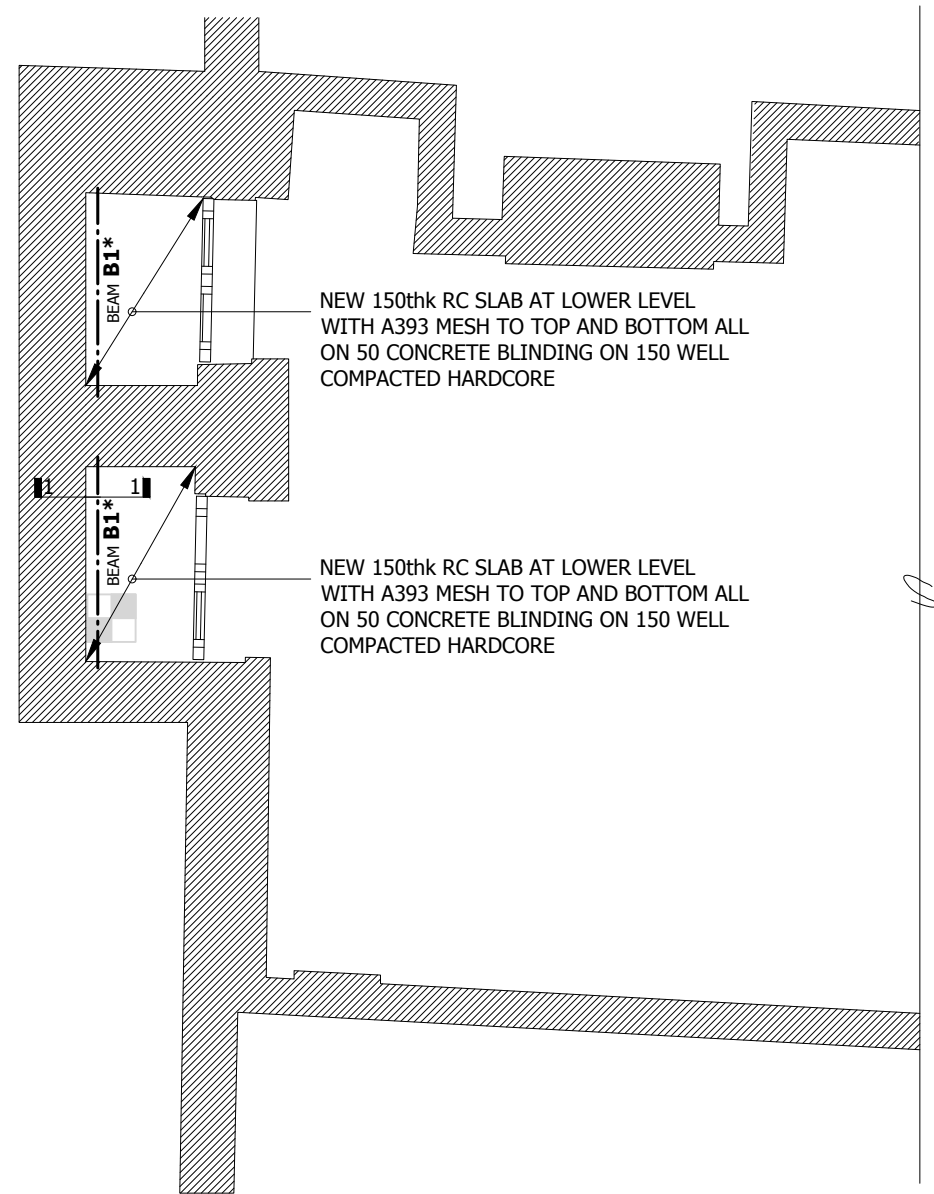

- NOTES:
- THIS DRAWING MUST BE READ IN CONJUNCTION WITH ALL ARCHITECTS, SERVICE ENGINEERS AND SPECIALIST CONTRACTOR DRAWINGS, DETAILS AND SPECIFICATIONS. ANY DISCREPANCIES MUST BE BROUGHT TO THE ATTENTION OF THE CONTRACT ADMINISTRATOR PRIOR TO COMMENCEMENT OF THE WORKS.
 - DO NOT SCALE FROM PAPER OR DIGITAL VERSIONS OF THIS DRAWING. USE STATED DIMENSIONS ONLY.
 - ALL LEVELS, DIMENSIONS AND SETTING-OUT MUST BE CONFIRMED BY THE ARCHITECT PRIOR TO CONSTRUCTION.

REV	DATE	DESCRIPTION	BY
P1	11.12.24	PRELIMINARY ISSUE	JL

PROJECT TITLE:	5 OLD PALACE TERRACE LONDON TW9 1NB
SCALE:	1:50 @A3
DATE:	DEC 2024
DRAWING STATUS:	PRELIMINARY

DRAWING TITLE:	PROPOSED LG FLOOR PARTIAL PLAN
DRAWN BY:	JL
JOB NUMBER-DRAWING NUMBER:	1223508 - 010
REVISION:	P1

Lengineering Ltd
CONSULTING STRUCTURAL ENGINEERS

10 UNWIN AVENUE
LONDON
TW14 9RG

07730533857
02087071544

office@lengineering.co.uk
www.lengineering.co.uk